

I-95 ETL NORTHBOUND EXTENSION PHASE II ECCLESTON ADJACENT PROPERTIES MAP

- Legend**
- New or Increased Project Impacts
 - Project Parcels
 - Adjacent Property Boundary
 - Parcel Boundaries

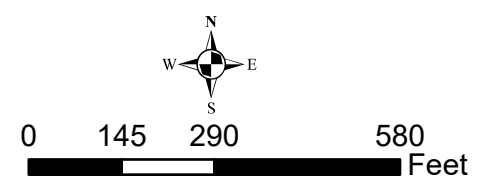

DATE: MARCH 2024



1" = 300'

SOURCE: ESRI, BALTIMORE COUNTY

I-95 ETL NORTHBOUND EXTENSION PHASE II ECCLESTON ADJACENT PROPERTY OWNER LIST

Acct #	Owner Name	Owner Mailing Address				Parcel
		Address	City	State	Zip Code	Location #
NA - ROW	BALTIMORE GAS AND ELECTRIC	ATTN: GARY BOWERS 1068 N FRONT ST FL 3	BALTIMORE	MD	21202	1
04030316017410	LITTLE ROBERT D AND ANN M	8700 PARK HEIGHTS AVE	STEVENSON	MD	21153	2
04030320095180	TYLER LAWRENCE RICARDO	2705 SPRING HILL RD	OWINGS MILLS	MD	21117	3
04030305088310	WRIGHT M BOSLEY AND CINDY SCOTT	71 NORTH BAY HARBOR	KEY LARGO	FL	33037	4
04031900004687	WRIGHT M BOSLEY AND CINDY SCOTT	2501 GREENSPRING VALLEY RD	OWINGS MILLS	MD	21117	5

ECCLESTON MITIGATION SITE PUBLIC OFFICIAL LIST					
Title	Name	Mailing Address			
		Address	City	State	Zip Code
State Senator (District 11)	Shelly L. Hettleman	203 James Senate Office Building 11 Bladen St.	Annapolis	MD	21401
State Delegate (District 11B)	Jon S. Cardin	426 Lowe House Office Building 6 Bladen St.	Annapolis	MD	21401
State Delegate (District 11B)	Dana M. Stein	301 Lowe House Office Building 6 Bladen St.	Annapolis	MD	21401
County Executive (Baltimore County)	John A. Olszewski, Jr.	Office of County Executive Historic Courthouse, Mezzanine Level, 400 Washington Ave.	Towson	MD	21204