

MATCHLINE KEYMAP 2

HAHA BRANCH

PLATE 1

IMPACT PLATE KEYMAP I

**I-95 ETL NORTHBOUND EXTENSION
PHASE II**

**MD 24 INTERCHANGE
I-95 NB ETL TWO-LANE EXTENSION
HARFORD COUNTY, MARYLAND**



**MARYLAND
TRANSPORTATION AUTHORITY**

CONTRACT NO.: KH-3021

SCALE: 1" = 1,000'

DATE: JUNE 2019

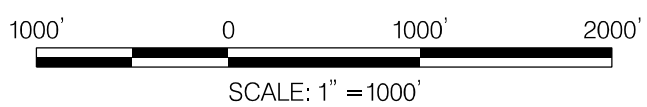

FILE: \$FILES\$
DATE: \$DATES\$

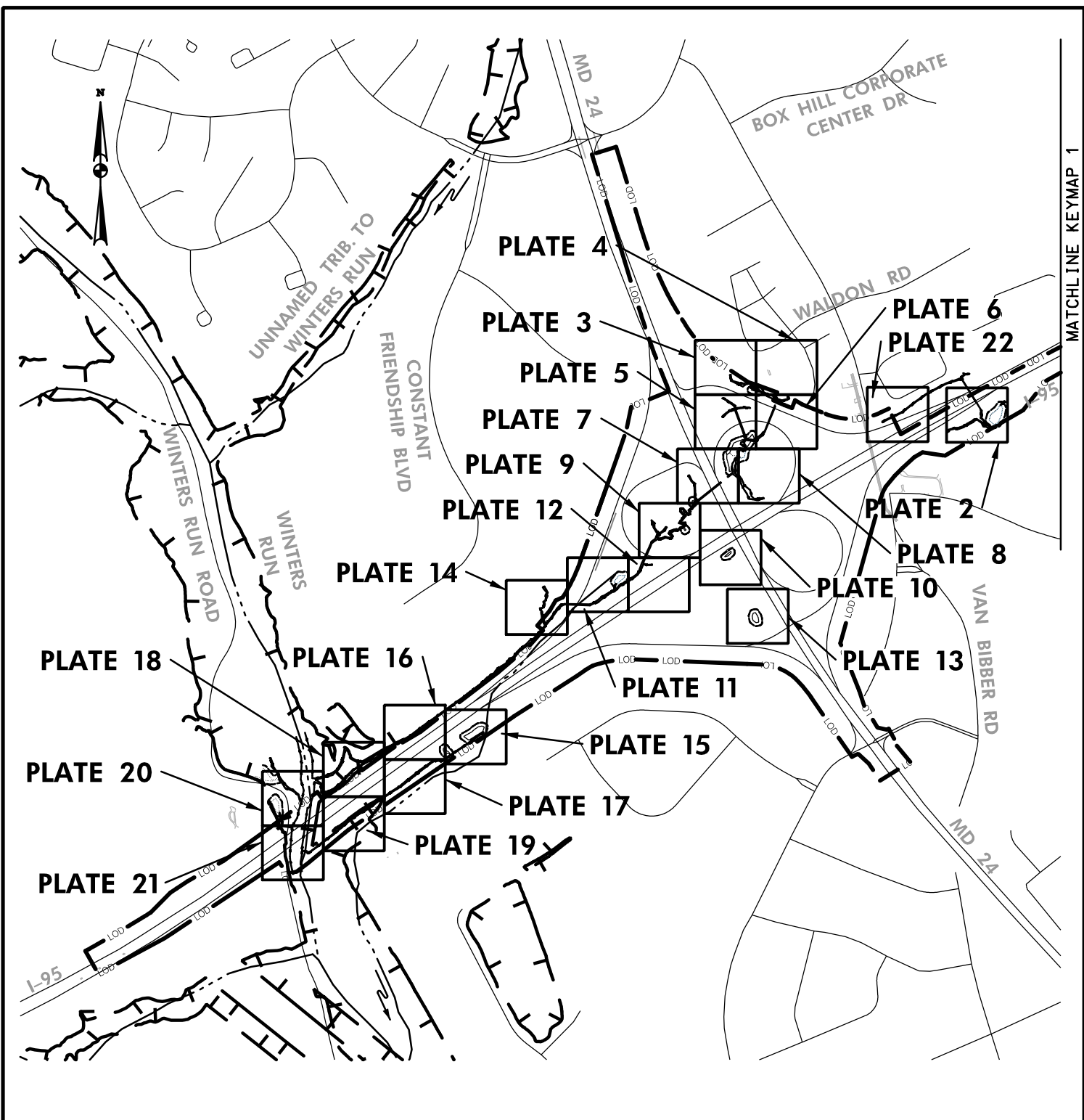

MATCHLINE KEYMAP 1

IMPACT PLATE KEYMAP 2

**I-95 ETL NORTHBOUND EXTENSION
PHASE II**

**MD 24 INTERCHANGE
I-95 NB ETL TWO-LANE EXTENSION
HARFORD COUNTY, MARYLAND**



**MARYLAND
TRANSPORTATION AUTHORITY**

CONTRACT NO.: KH-3021

SCALE: 1" = 1,000'

DATE: JUNE 2019

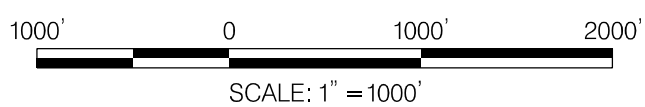

FILE: \$FILES\$
DATE: \$DATES\$

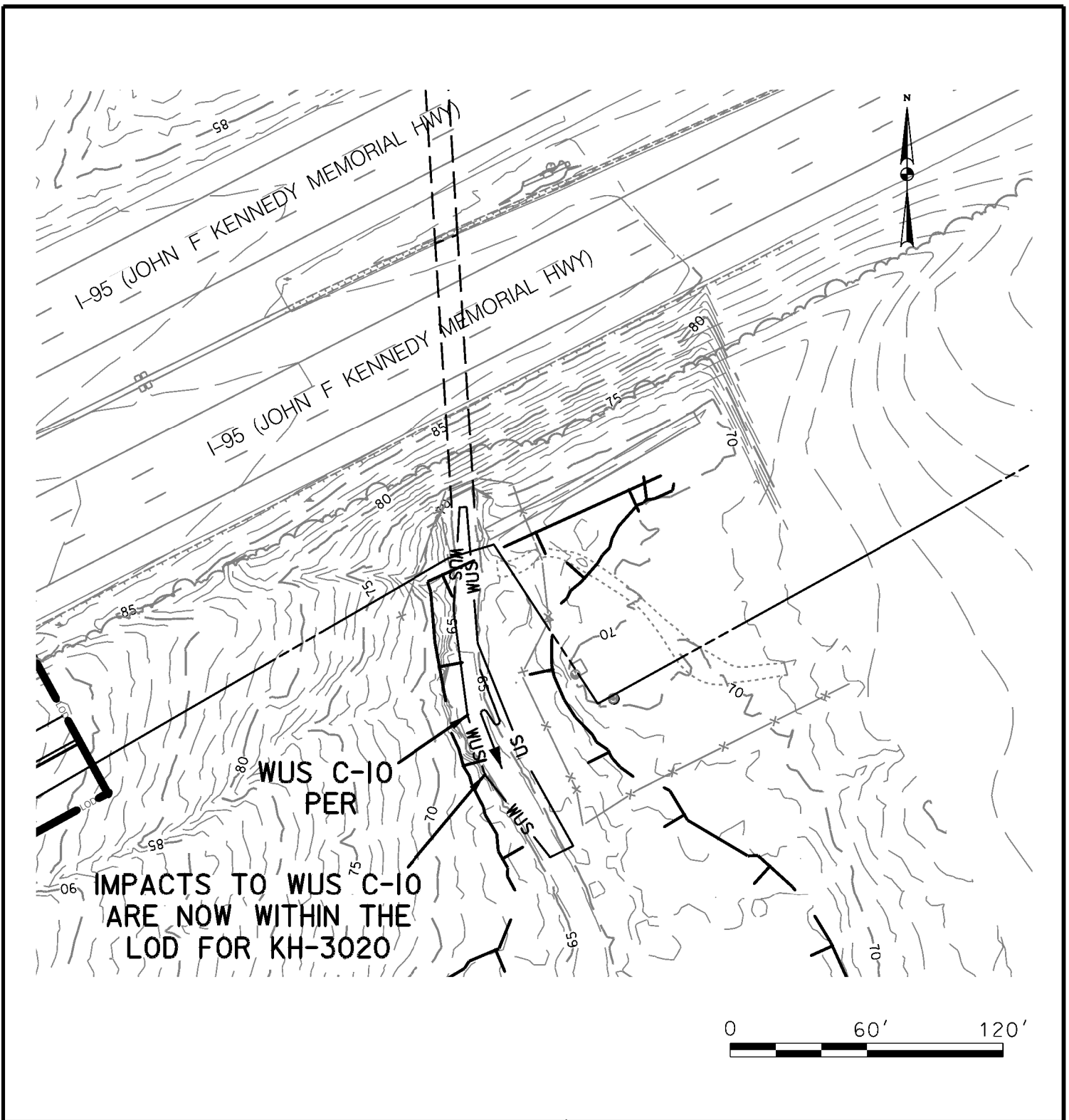

IMPACTS ON THIS PLATE

	TEMPORARY	PERMANENT
PFO WETLAND	0 SF	0 SF
PSS WETLAND	0 SF	0 SF
PEM WETLAND	0 SF	0 SF
PERENNIAL WUS	0 LF/SF	0 LF/SF
INTERMITTENT WUS	0 LF/SF	0 LF/SF
EPHEMERAL WUS	0 LF/SF	0 LF/SF
WETLAND BUFFER	0 SF	0 SF
100-YEAR FLOODPLAIN	0 SF	0 SF

WETLAND IMPACT PLATE

I-95 ETL NORTHBOUND EXTENSION
 PHASE II
 MD 24 INTERCHANGE
 I-95 NB ETL TWO-LANE EXTENSION
 HARFORD COUNTY, MARYLAND



**MARYLAND
 TRANSPORTATION AUTHORITY**

SCALE: 1" = 60'

CONTRACT NO.: KH-3021

DATE: JUNE 2019

PLATE 1 OF 22

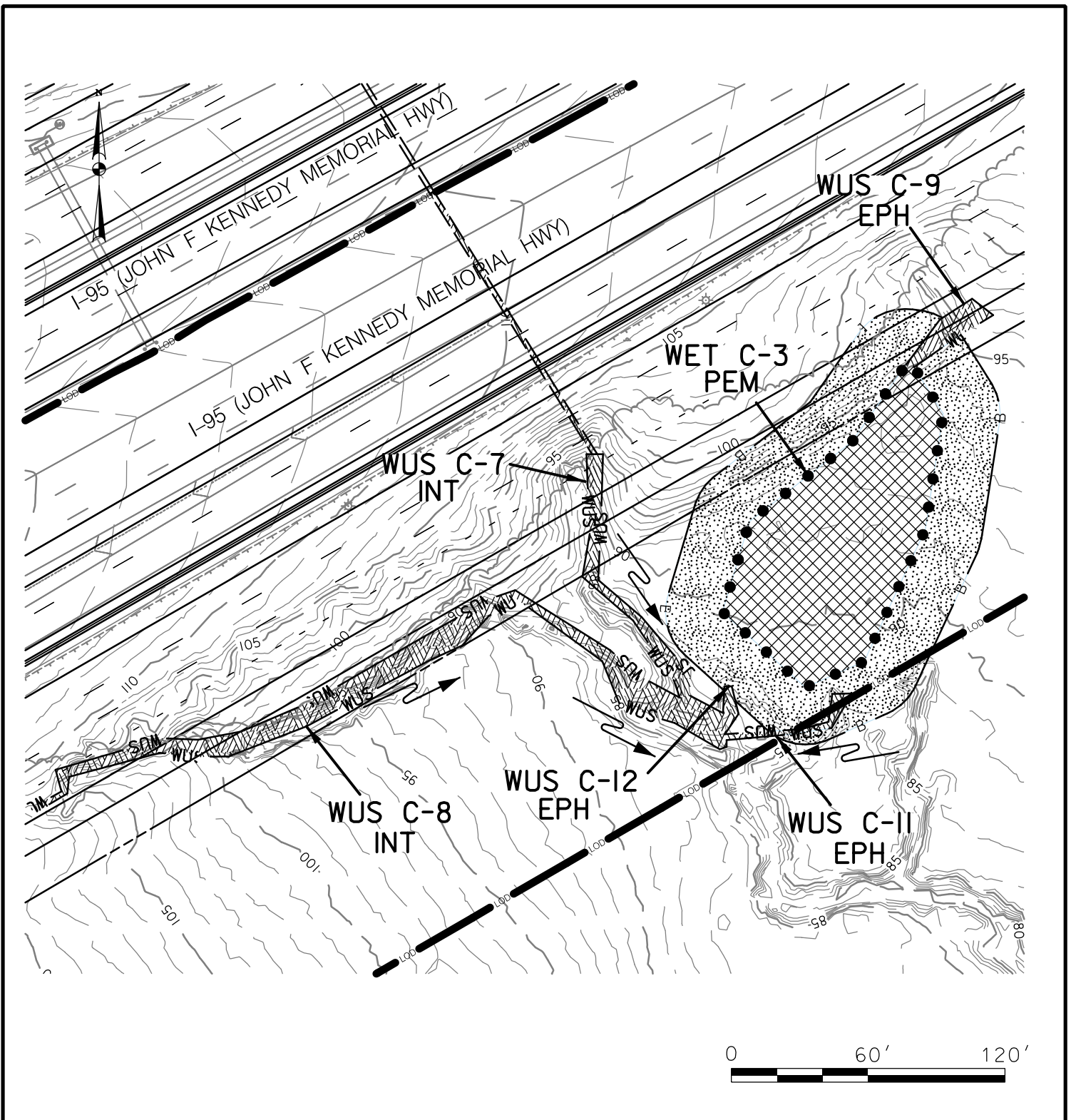

IMPACTS ON THIS PLATE

	TEMPORARY	PERMANENT
PFO WETLAND	0 SF	0 SF
PSS WETLAND	0 SF	0 SF
PEM WETLAND	0 SF	7,220 SF
PERENNIAL WUS	0 LF/SF	0 LF/SF
INTERMITTENT WUS	0 LF/SF	608/4,377 LF/SF
EPHEMERAL WUS	0 LF/SF	88/519 LF/SF
WETLAND BUFFER	0 SF	10,605 SF
100-YEAR FLOODPLAIN	0 SF	0 SF

WETLAND IMPACT PLATE

I-95 ETL NORTHBOUND EXTENSION
 PHASE II
 MD 24 INTERCHANGE
 I-95 NB ETL TWO-LANE EXTENSION
 HARFORD COUNTY, MARYLAND



**MARYLAND
 TRANSPORTATION AUTHORITY**

SCALE: 1" = 60'

CONTRACT NO.: KH-3021

DATE: JUNE 2019

PLATE 2 OF 22

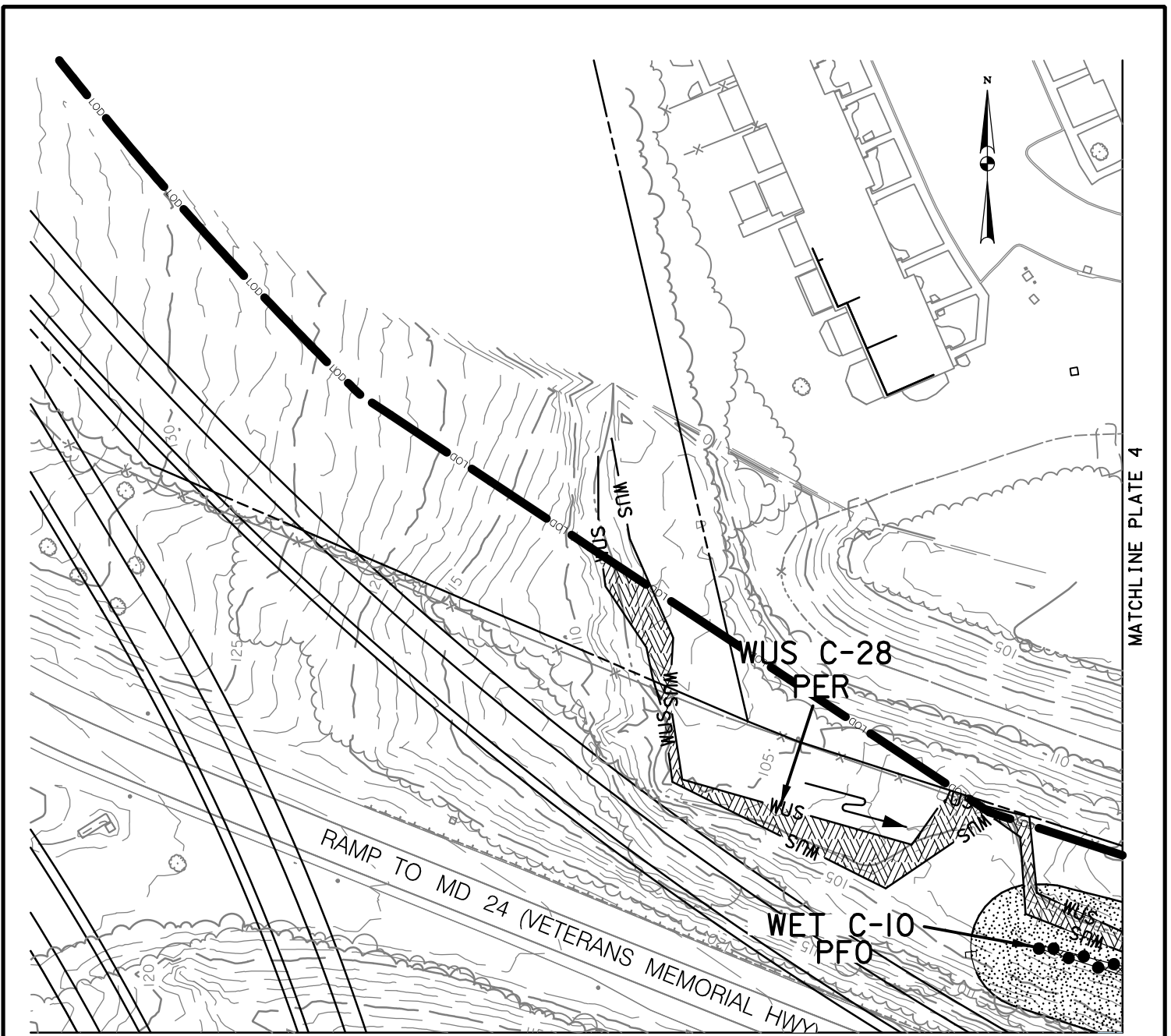

MATCHLINE PLATE 5



IMPACTS ON THIS PLATE

	TEMPORARY	PERMANENT
PFO WETLAND	0 SF	86 SF
PSS WETLAND	0 SF	0 SF
PEM WETLAND	0 SF	0 SF
PERENNIAL WUS	0 LF/SF	323/2,845 LF/SF
INTERMITTENT WUS	0 LF/SF	0 LF/SF
EPHEMERAL WUS	0 LF/SF	0 LF/SF
WETLAND BUFFER	0 SF	2,453 SF
100-YEAR FLOODPLAIN	0 SF	0 SF

WETLAND IMPACT PLATE

I-95 ETL NORTHBOUND EXTENSION
 PHASE II
 MD 24 INTERCHANGE
 I-95 NB ETL TWO-LANE EXTENSION
 HARFORD COUNTY, MARYLAND

**MARYLAND
 TRANSPORTATION AUTHORITY**

SCALE: 1" = 60'

CONTRACT NO.: KH-3021

DATE: JUNE 2019

PLATE 3 OF 22



MATCHLINE PLATE 3

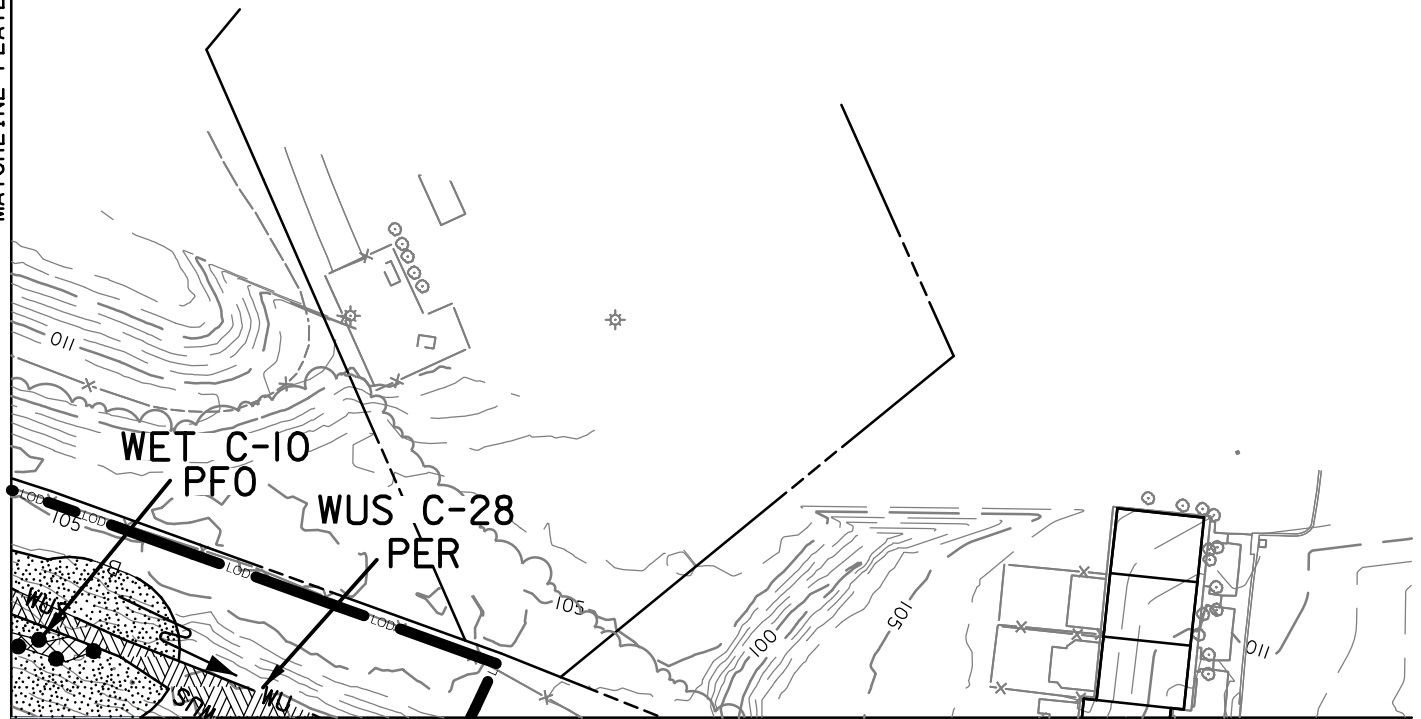

MATCHLINE PLATE 6

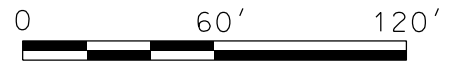

IMPACTS ON THIS PLATE

	TEMPORARY	PERMANENT
PFO WETLAND	0 SF	124 SF
PSS WETLAND	0 SF	0 SF
PEM WETLAND	0 SF	0 SF
PERENNIAL WUS	0 LF/SF	88/750 LF/SF
INTERMITTENT WUS	0 LF/SF	0 LF/SF
EPHEMERAL WUS	0 LF/SF	0 LF/SF
WETLAND BUFFER	0 SF	1,848 SF
100-YEAR FLOODPLAIN	0 SF	0 SF

WETLAND IMPACT PLATE

I-95 ETL NORTHBOUND EXTENSION
 PHASE II
 MD 24 INTERCHANGE
 I-95 NB ETL TWO-LANE EXTENSION
 HARFORD COUNTY, MARYLAND



**MARYLAND
 TRANSPORTATION AUTHORITY**

SCALE: 1" = 60'

CONTRACT NO.: KH-3021

DATE: JUNE 2019

PLATE 4 OF 22

FILE: \$FILE\$
 DATE: \$DATE\$

MATCHLINE PLATE 3

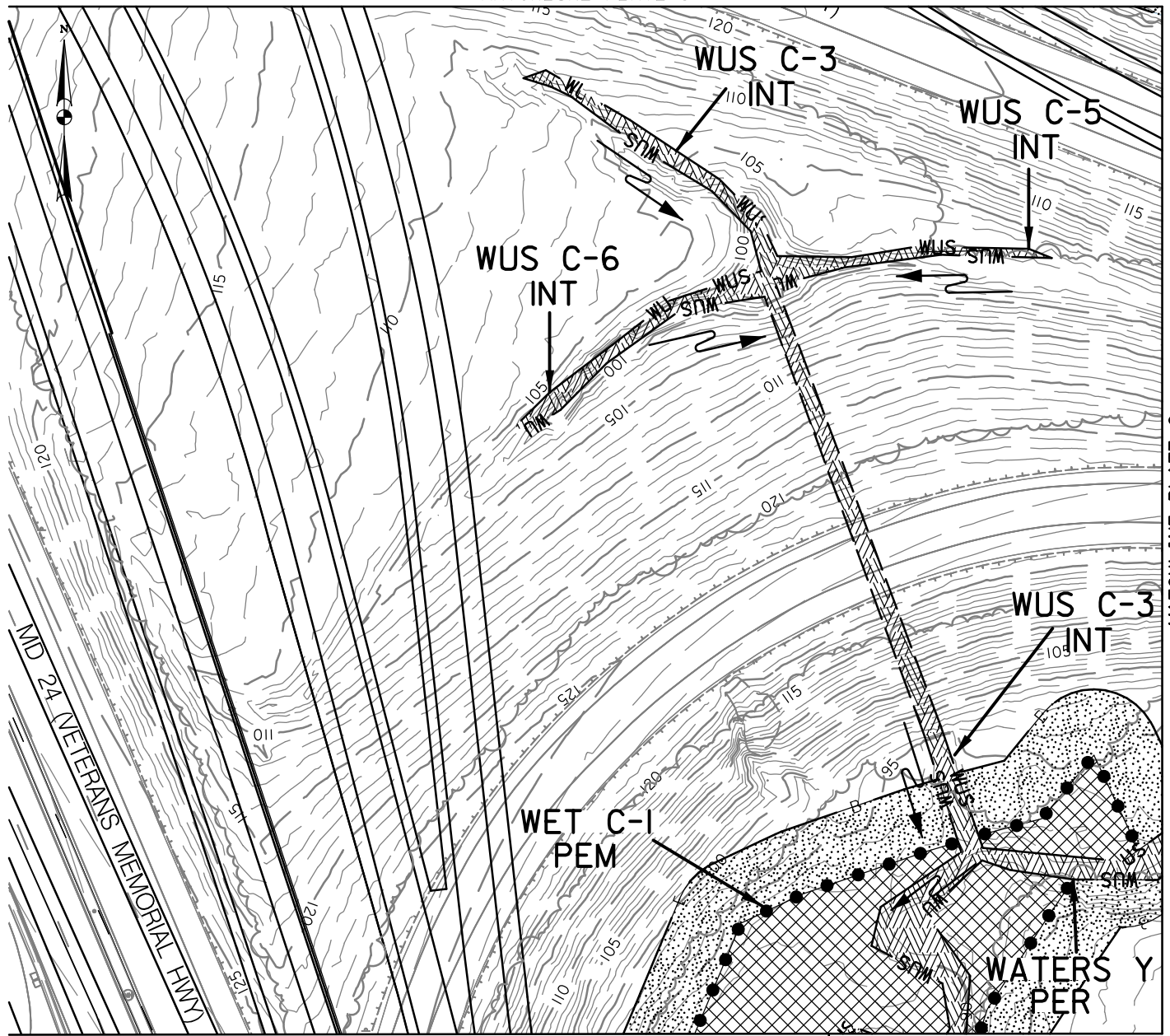

MATCHLINE PLATE 7

MATCHLINE PLATE 8



IMPACTS ON THIS PLATE

	TEMPORARY	PERMANENT
PFO WETLAND	0 SF	0 SF
PSS WETLAND	0 SF	0 SF
PEM WETLAND	0 SF	6,807 SF
PERENNIAL WUS	0 LF/SF	174/1,713 LF/SF
INTERMITTENT WUS	0 LF/SF	515/3,304 LF/SF
EPHEMERAL WUS	0 LF/SF	0 LF/SF
WETLAND BUFFER	0 SF	8,257 SF
100-YEAR FLOODPLAIN	0 SF	0 SF

WETLAND IMPACT PLATE

I-95 ETL NORTHBOUND EXTENSION
 PHASE II
 MD 24 INTERCHANGE
 I-95 NB ETL TWO-LANE EXTENSION
 HARFORD COUNTY, MARYLAND



**MARYLAND
 TRANSPORTATION AUTHORITY**

SCALE: 1" = 60'

CONTRACT NO.: KH-3021

DATE: JUNE 2019

PLATE 5 OF 22

MATCHLINE PLATE 4

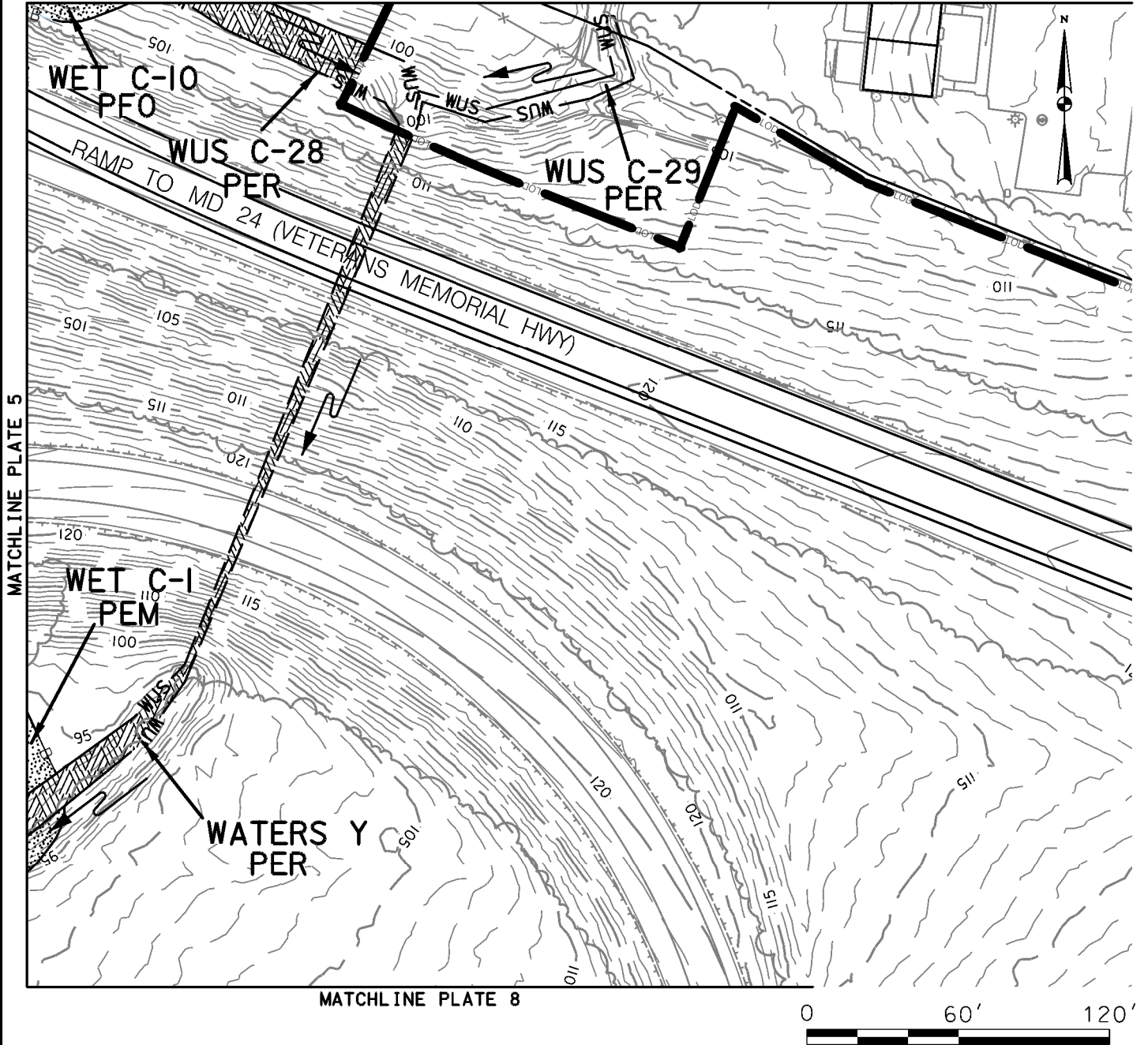

IMPACTS ON THIS PLATE

	TEMPORARY	PERMANENT
PFO WETLAND	0 SF	0 SF
PSS WETLAND	0 SF	0 SF
PEM WETLAND	0 SF	0 SF
PERENNIAL WUS	0 LF/SF	371/2,951 LF/SF
INTERMITTENT WUS	0 LF/SF	0 LF/SF
EPHEMERAL WUS	0 LF/SF	0 LF/SF
WETLAND BUFFER	0 SF	569 SF
100-YEAR FLOODPLAIN	0 SF	0 SF

WETLAND IMPACT PLATE

I-95 ETL NORTHBOUND EXTENSION
 PHASE II
 MD 24 INTERCHANGE
 I-95 NB ETL TWO-LANE EXTENSION
 HARFORD COUNTY, MARYLAND



**MARYLAND
 TRANSPORTATION AUTHORITY**

SCALE: 1" = 60'

CONTRACT NO.: KH-3021

DATE: JUNE 2019

PLATE 6 OF 22

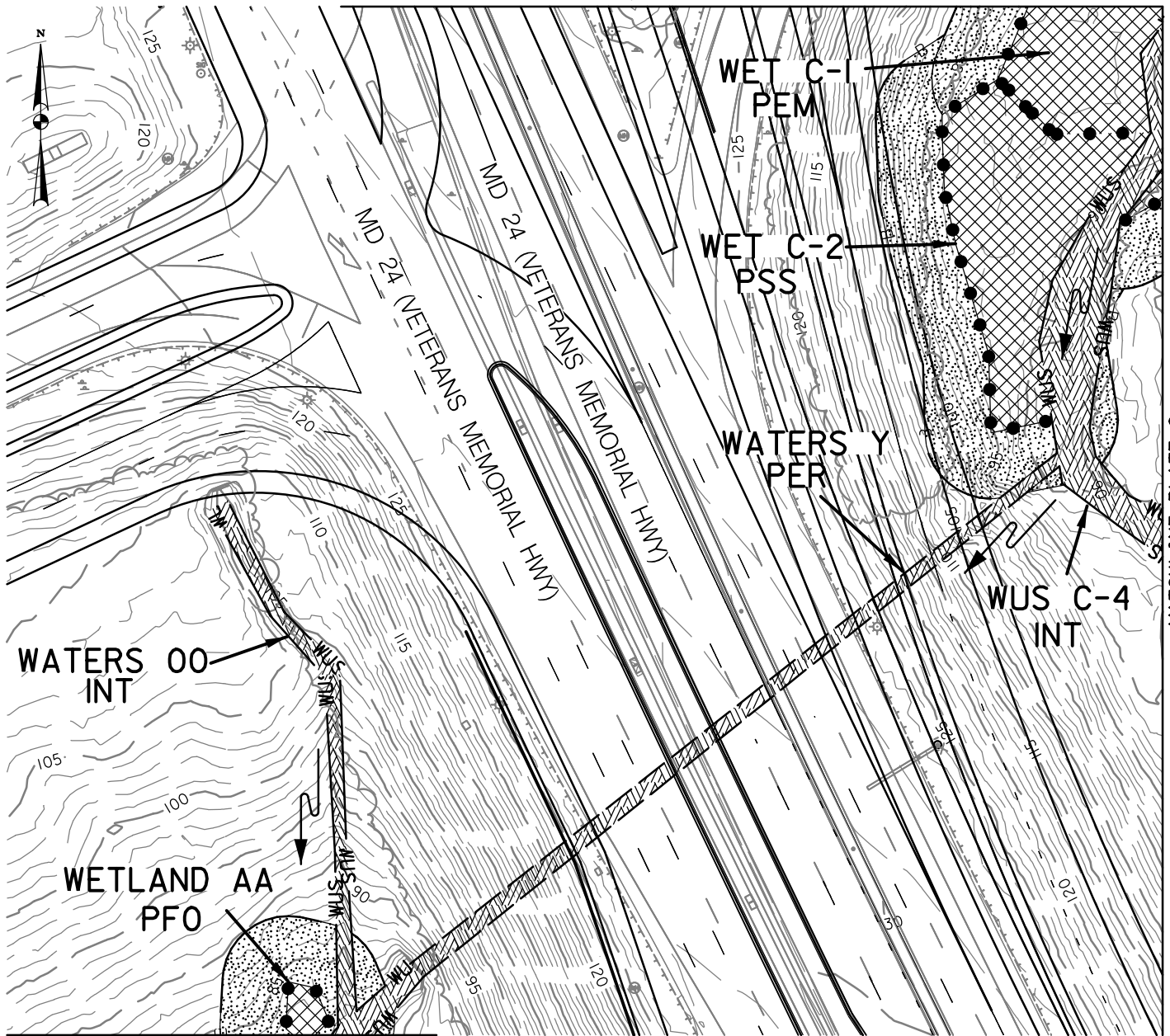

MATCHLINE PLATE 9

MATCHLINE PLATE 8



IMPACTS ON THIS PLATE

	TEMPORARY	PERMANENT
PFO WETLAND	0 SF	246 SF
PSS WETLAND	0 SF	4,946 SF
PEM WETLAND	0 SF	2,493 SF
PERENNIAL WUS	0 LF/SF	516/4,555 LF/SF
INTERMITTENT WUS	0 LF/SF	249/1,703 LF/SF
EPHEMERAL WUS	0 LF/SF	0 LF/SF
WETLAND BUFFER	0 SF	8,090 SF
100-YEAR FLOODPLAIN	0 SF	0 SF

WETLAND IMPACT PLATE

I-95 ETL NORTHBOUND EXTENSION
 PHASE II
 MD 24 INTERCHANGE
 I-95 NB ETL TWO-LANE EXTENSION
 HARFORD COUNTY, MARYLAND



**MARYLAND
 TRANSPORTATION AUTHORITY**

SCALE: 1" = 60'

CONTRACT NO.: KH-3021

DATE: JUNE 2019

PLATE 7 OF 22

MATCHLINE PLATE 5

MATCHLINE PLATE 6

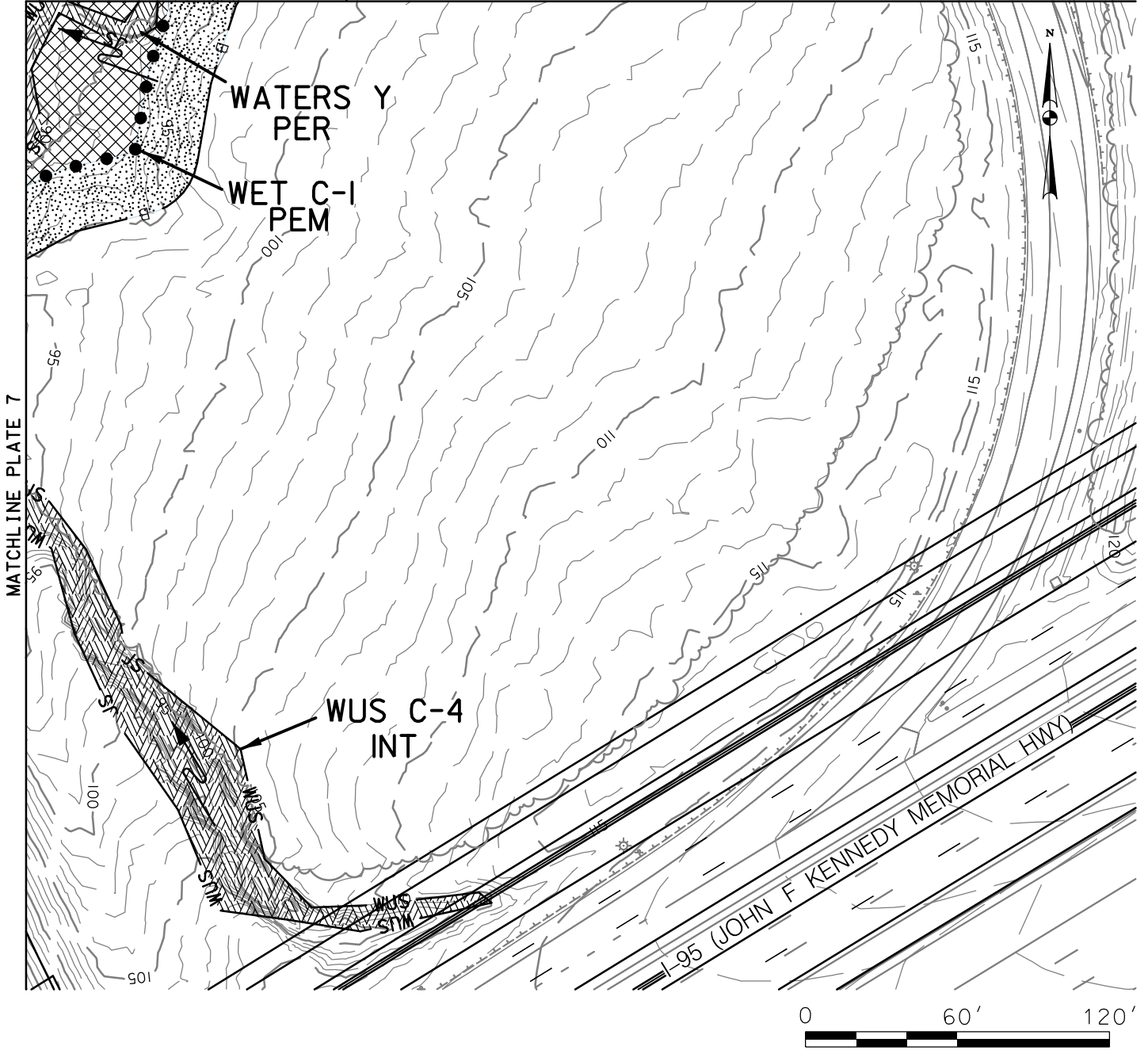

IMPACTS ON THIS PLATE

	TEMPORARY	PERMANENT
PFO WETLAND	0 SF	0 SF
PSS WETLAND	0 SF	0 SF
PEM WETLAND	0 SF	2,444 SF
PERENNIAL WUS	0 LF/SF	106/710 LF/SF
INTERMITTENT WUS	0 LF/SF	274/4,767 LF/SF
EPHEMERAL WUS	0 LF/SF	0 LF/SF
WETLAND BUFFER	0 SF	3,174 SF
100-YEAR FLOODPLAIN	0 SF	0 SF

WETLAND IMPACT PLATE

I-95 ETL NORTHBOUND EXTENSION
 PHASE II
 MD 24 INTERCHANGE
 I-95 NB ETL TWO-LANE EXTENSION
 HARFORD COUNTY, MARYLAND



**MARYLAND
 TRANSPORTATION AUTHORITY**

SCALE: 1" = 60'

CONTRACT NO.: KH-3021

DATE: JUNE 2019

PLATE 8 OF 22

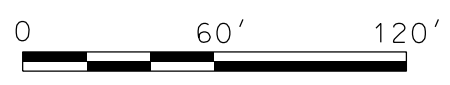
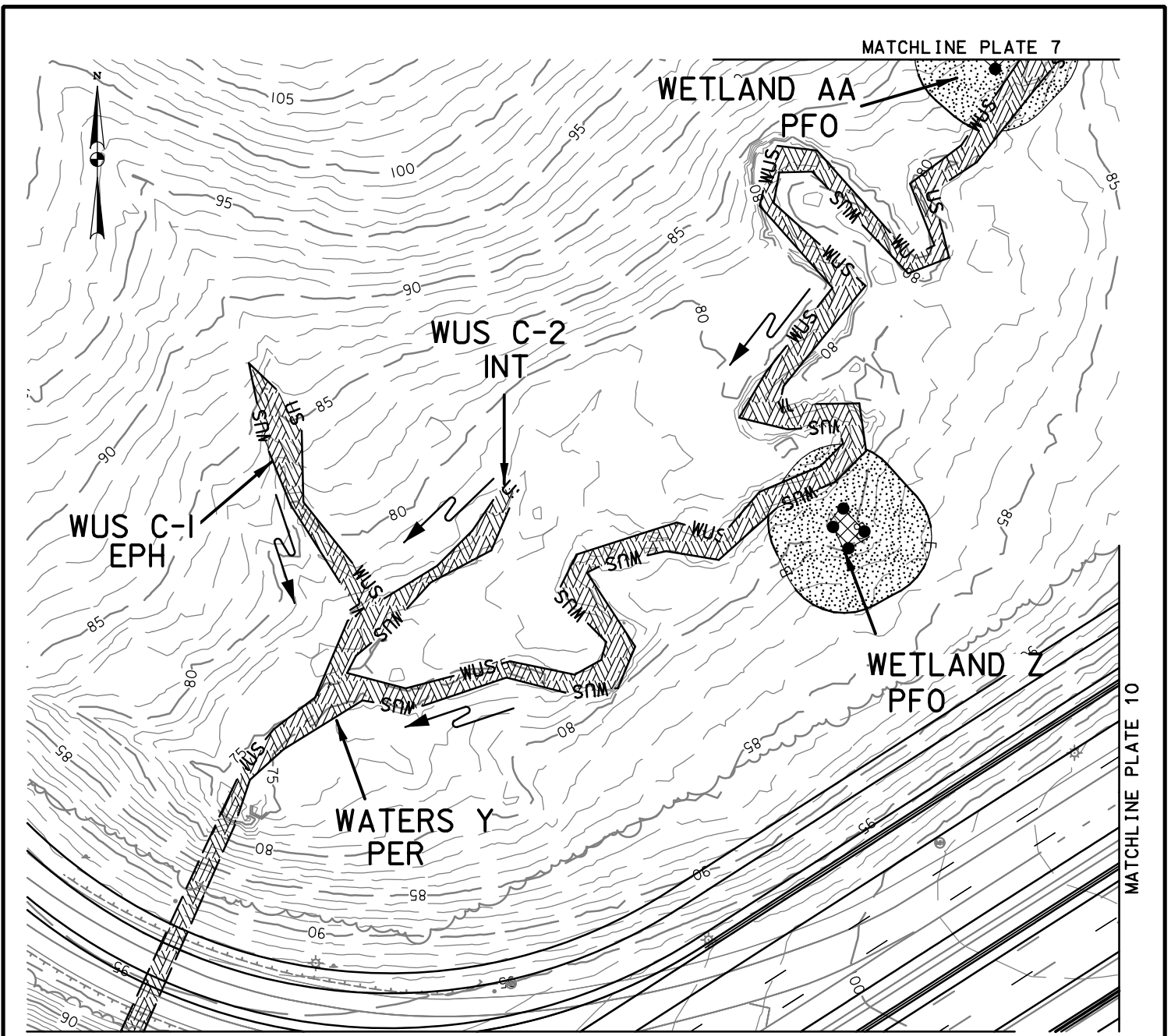

IMPACTS ON THIS PLATE

	TEMPORARY	PERMANENT
PFO WETLAND	0 SF	151 SF
PSS WETLAND	0 SF	0 SF
PEM WETLAND	0 SF	0 SF
PERENNIAL WUS	0 LF/SF	799/6,792 LF/SF
INTERMITTENT WUS	0 LF/SF	109/911 LF/SF
EPHEMERAL WUS	0 LF/SF	110/975 LF/SF
WETLAND BUFFER	0 SF	3,760 SF
100-YEAR FLOODPLAIN	0 SF	0 SF

WETLAND IMPACT PLATE

I-95 ETL NORTHBOUND EXTENSION
 PHASE II
 MD 24 INTERCHANGE
 I-95 NB ETL TWO-LANE EXTENSION
 HARFORD COUNTY, MARYLAND



**MARYLAND
 TRANSPORTATION AUTHORITY**

SCALE: 1" = 60'

CONTRACT NO.: KH-3021

DATE: JUNE 2019

PLATE 9 OF 22

FILE: \$FILE\$
 DATE: \$DATE\$

MATCHLINE PLATE 9

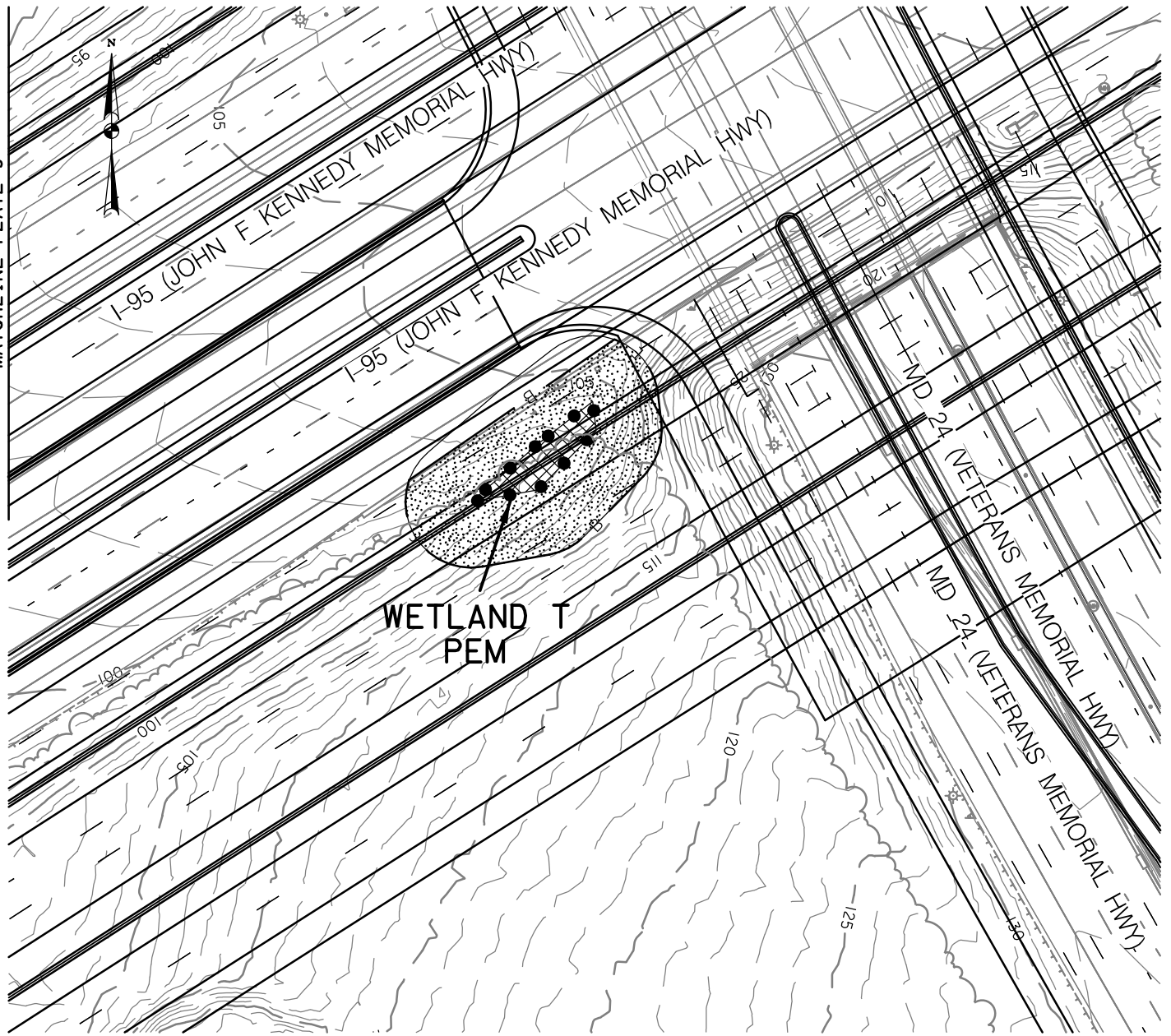

IMPACTS ON THIS PLATE

	TEMPORARY	PERMANENT
PFO WETLAND	0 SF	0 SF
PSS WETLAND	0 SF	0 SF
PEM WETLAND	0 SF	538 SF
PERENNIAL WUS	0 LF/SF	0 LF/SF
INTERMITTENT WUS	0 LF/SF	0 LF/SF
EPHEMERAL WUS	0 LF/SF	0 LF/SF
WETLAND BUFFER	0 SF	4,615 SF
100-YEAR FLOODPLAIN	0 SF	0 SF

WETLAND IMPACT PLATE

I-95 ETL NORTHBOUND EXTENSION
 PHASE II
 MD 24 INTERCHANGE
 I-95 NB ETL TWO-LANE EXTENSION
 HARFORD COUNTY, MARYLAND



**MARYLAND
 TRANSPORTATION AUTHORITY**

SCALE: 1" = 60'

CONTRACT NO.: KH-3021

DATE: JUNE 2019

PLATE 10 OF 22

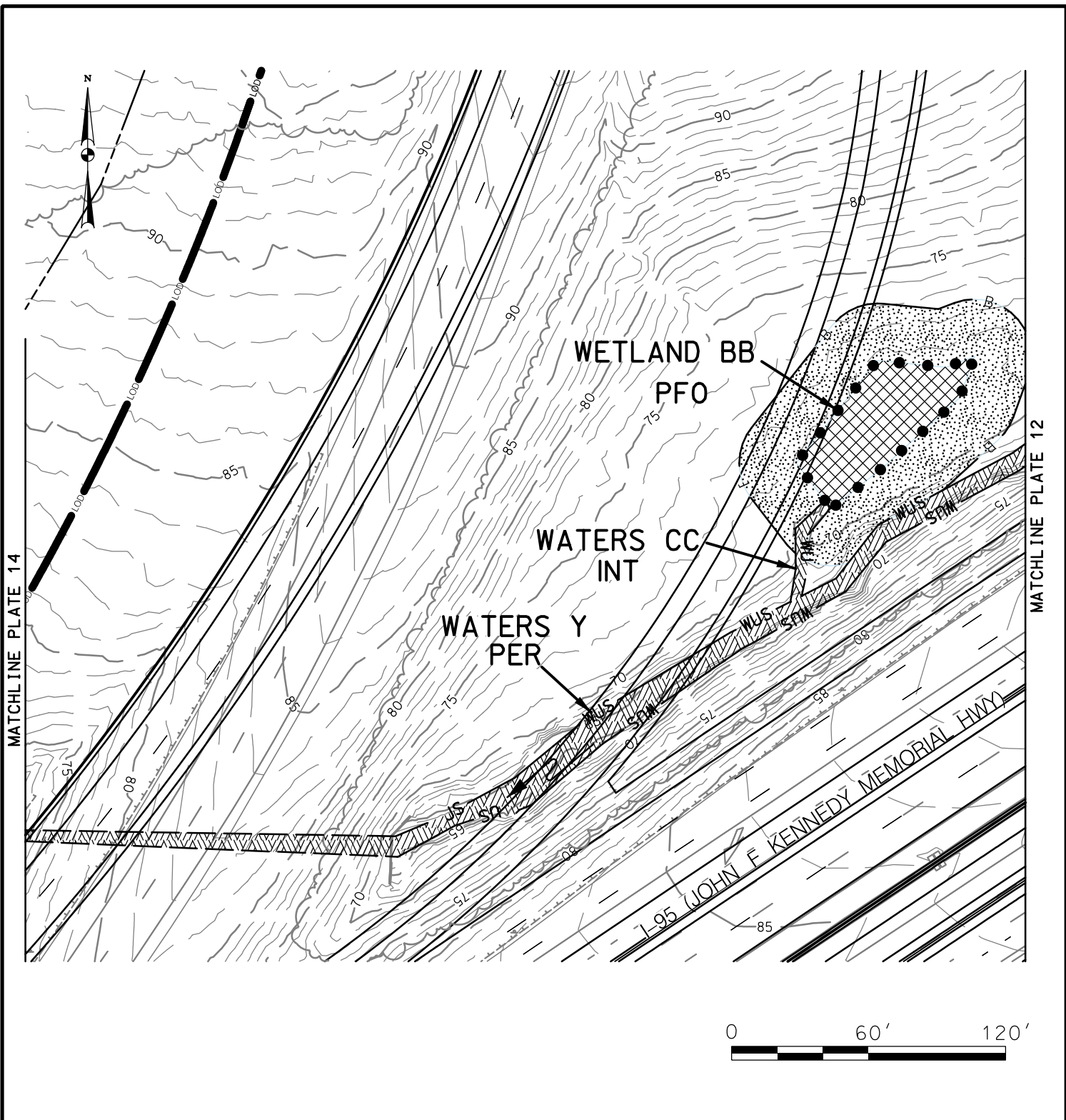

IMPACTS ON THIS PLATE

	TEMPORARY	PERMANENT
PFO WETLAND	0 SF	2,365 SF
PSS WETLAND	0 SF	0 SF
PEM WETLAND	0 SF	0 SF
PERENNIAL WUS	0 LF/SF	399/4,195 LF/SF
INTERMITTENT WUS	0 LF/SF	46/229 LF/SF
EPHEMERAL WUS	0 LF/SF	0 LF/SF
WETLAND BUFFER	0 SF	7,065 SF
100-YEAR FLOODPLAIN	0 SF	0 SF

WETLAND IMPACT PLATE

I-95 ETL NORTHBOUND EXTENSION
 PHASE II
 MD 24 INTERCHANGE
 I-95 NB ETL TWO-LANE EXTENSION
 HARFORD COUNTY, MARYLAND



**MARYLAND
 TRANSPORTATION AUTHORITY**

SCALE: 1" = 60'

CONTRACT NO.: KH-3021

DATE: JUNE 2019

PLATE 11 OF 22



IMPACTS ON THIS PLATE

	TEMPORARY	PERMANENT
PFO WETLAND	0 SF	0 SF
PSS WETLAND	0 SF	0 SF
PEM WETLAND	0 SF	0 SF
PERENNIAL WUS	0 LF/SF	213/2,009 LF/SF
INTERMITTENT WUS	0 LF/SF	62/178 LF/SF
EPHEMERAL WUS	0 LF/SF	0 LF/SF
WETLAND BUFFER	0 SF	40 SF
100-YEAR FLOODPLAIN	0 SF	0 SF

WETLAND IMPACT PLATE

I-95 ETL NORTHBOUND EXTENSION
 PHASE II
 MD 24 INTERCHANGE
 I-95 NB ETL TWO-LANE EXTENSION
 HARFORD COUNTY, MARYLAND



**MARYLAND
 TRANSPORTATION AUTHORITY**

SCALE: 1" = 60'

CONTRACT NO.: KH-3021

DATE: JUNE 2019

PLATE 12 OF 22

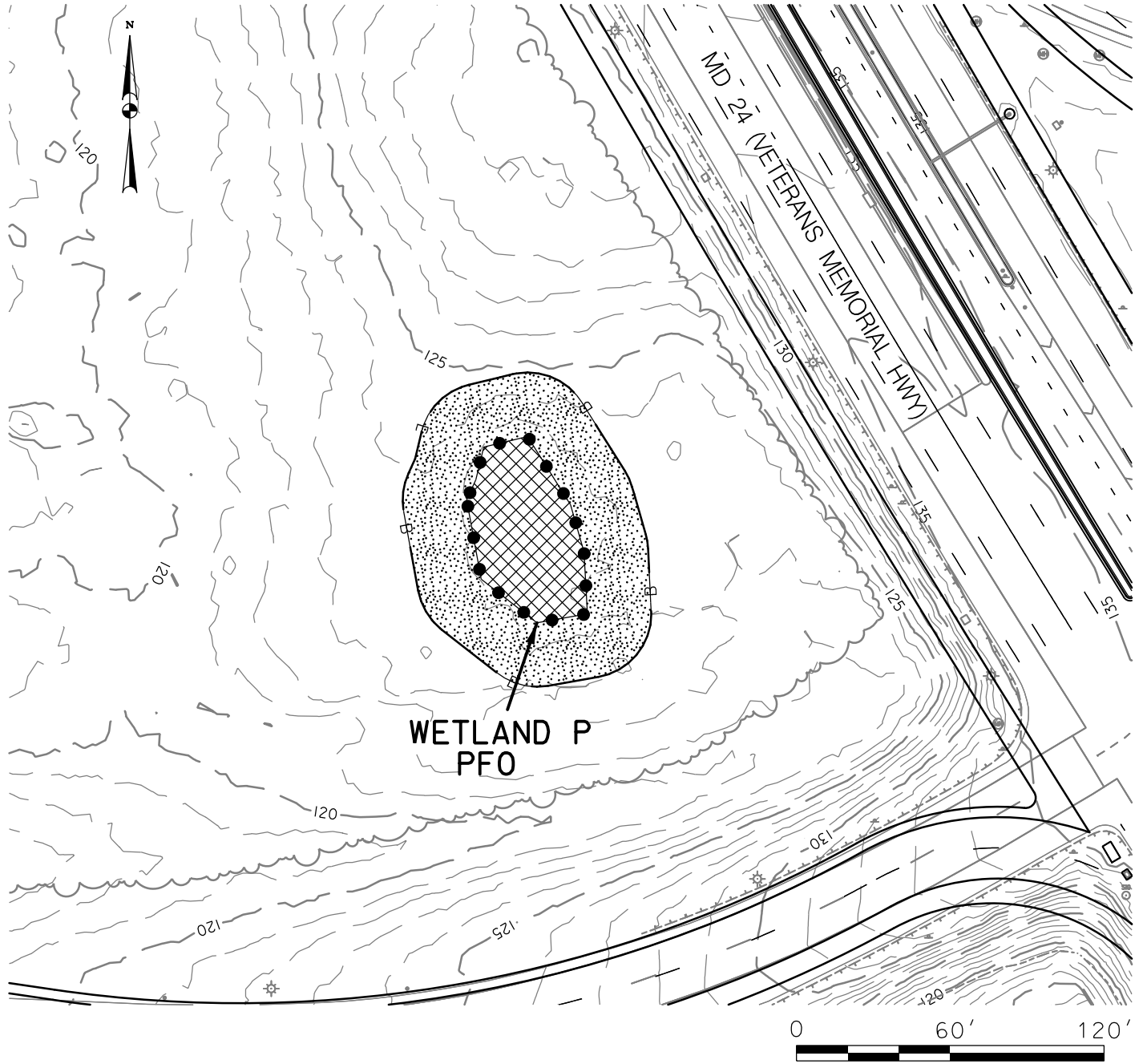

IMPACTS ON THIS PLATE

	TEMPORARY	PERMANENT
PFO WETLAND	0 SF	2,389 SF
PSS WETLAND	0 SF	0 SF
PEM WETLAND	0 SF	0 SF
PERENNIAL WUS	0 LF/SF	0 LF/SF
INTERMITTENT WUS	0 LF/SF	0 LF/SF
EPHEMERAL WUS	0 LF/SF	0 LF/SF
WETLAND BUFFER	0 SF	6,781 SF
100-YEAR FLOODPLAIN	0 SF	0 SF

WETLAND IMPACT PLATE

I-95 ETL NORTHBOUND EXTENSION
 PHASE II
 MD 24 INTERCHANGE
 I-95 NB ETL TWO-LANE EXTENSION
 HARFORD COUNTY, MARYLAND



**MARYLAND
 TRANSPORTATION AUTHORITY**

SCALE: 1" = 60'

CONTRACT NO.: KH-3021

DATE: JUNE 2019

PLATE 13 OF 22

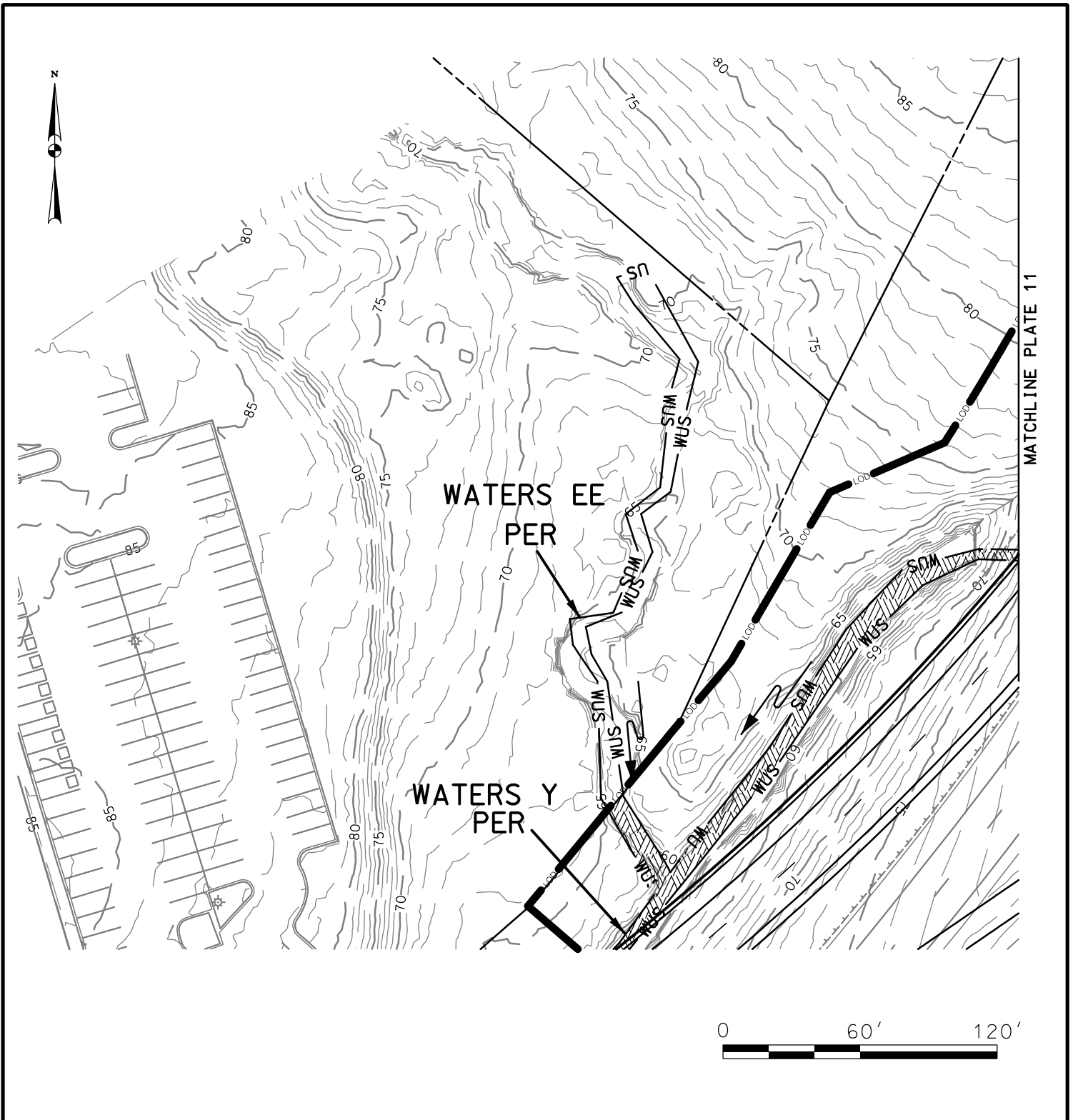

IMPACTS ON THIS PLATE

	TEMPORARY	PERMANENT
PFO WETLAND	0 SF	0 SF
PSS WETLAND	0 SF	0 SF
PEM WETLAND	0 SF	0 SF
PERENNIAL WUS	0 LF/SF	302/2,672 LF/SF
INTERMITTENT WUS	0 LF/SF	0 LF/SF
EPHEMERAL WUS	0 LF/SF	0 LF/SF
WETLAND BUFFER	0 SF	0 SF
100-YEAR FLOODPLAIN	0 SF	0 SF

WETLAND IMPACT PLATE

I-95 ETL NORTHBOUND EXTENSION
 PHASE II
 MD 24 INTERCHANGE
 I-95 NB ETL TWO-LANE EXTENSION
 HARFORD COUNTY, MARYLAND



**MARYLAND
 TRANSPORTATION AUTHORITY**

SCALE: 1" = 60'

CONTRACT NO.: KH-3021

DATE: JUNE 2019

PLATE 14 OF 22

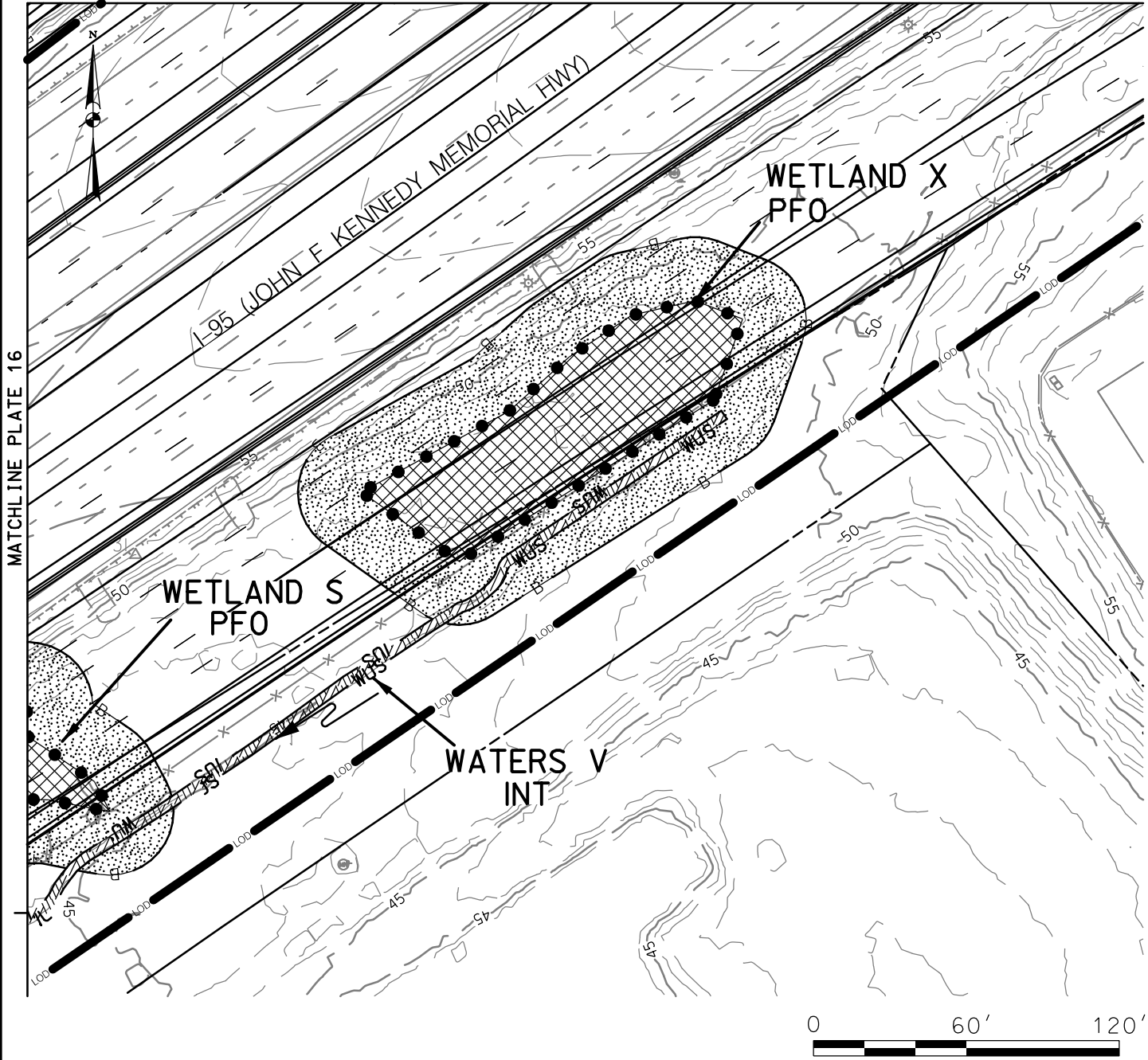

MATCHLINE PLATE 16

IMPACTS ON THIS PLATE

	TEMPORARY	PERMANENT
PFO WETLAND	0 SF	6,526 SF
PSS WETLAND	0 SF	0 SF
PEM WETLAND	0 SF	0 SF
PERENNIAL WUS	0 LF/SF	0 LF/SF
INTERMITTENT WUS	0 LF/SF	340/1,364 LF/SF
EPHEMERAL WUS	0 LF/SF	0 LF/SF
WETLAND BUFFER	0 SF	13,698 SF
100-YEAR FLOODPLAIN	0 SF	0 SF

WETLAND IMPACT PLATE

I-95 ETL NORTHBOUND EXTENSION
 PHASE II
 MD 24 INTERCHANGE
 I-95 NB ETL TWO-LANE EXTENSION
 HARFORD COUNTY, MARYLAND



**MARYLAND
 TRANSPORTATION AUTHORITY**

SCALE: 1" = 60'

CONTRACT NO.: KH-3021

DATE: JUNE 2019

PLATE 15 OF 22

FILE: \$FILES\$
 DATE: \$DATES\$

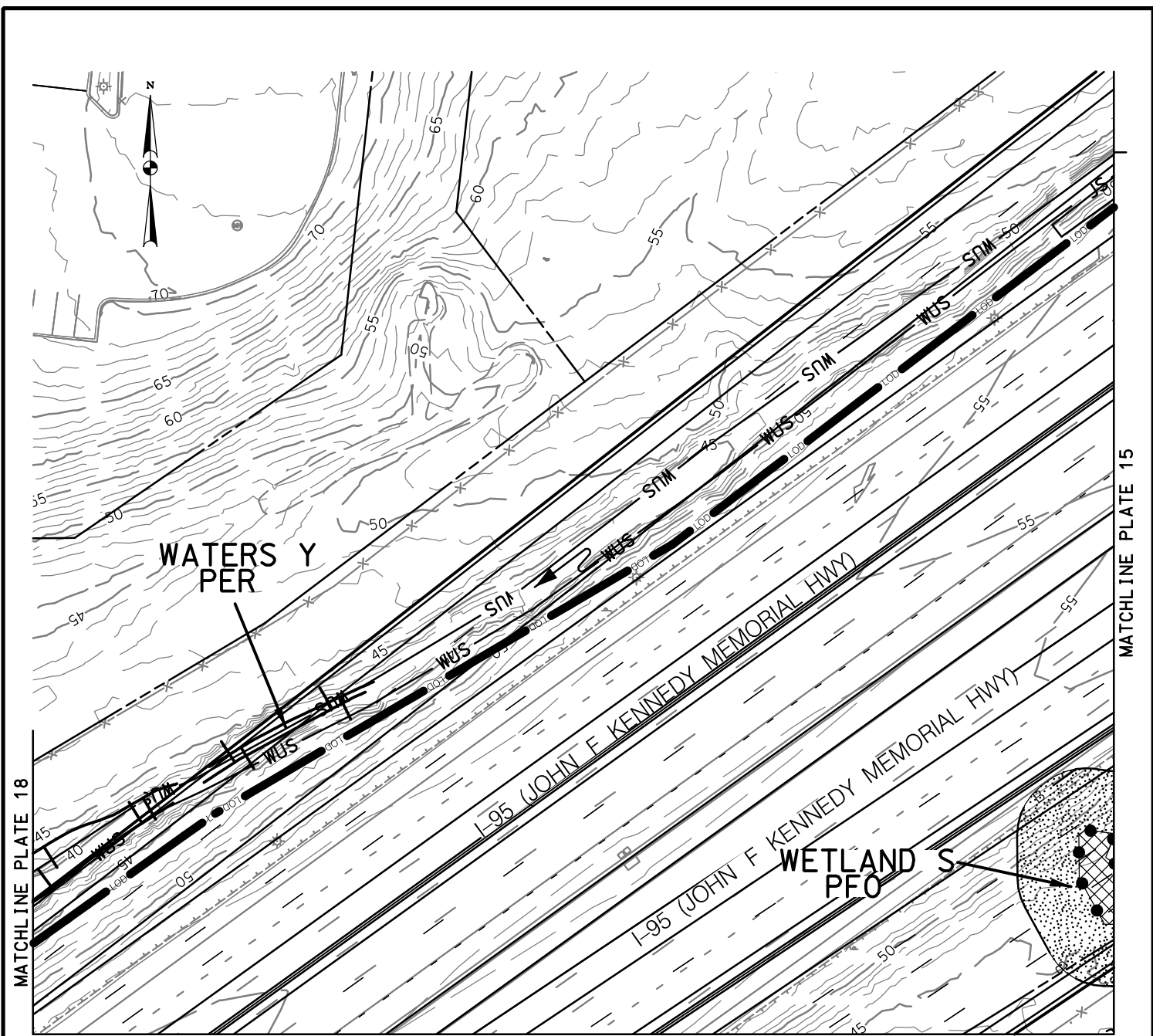

MATCHLINE PLATE 17

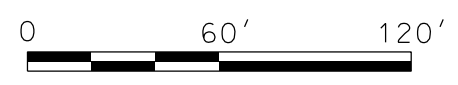

IMPACTS ON THIS PLATE

	TEMPORARY	PERMANENT
PFO WETLAND	0 SF	413 SF
PSS WETLAND	0 SF	0 SF
PEM WETLAND	0 SF	0 SF
PERENNIAL WUS	0 LF/SF	0 LF/SF
INTERMITTENT WUS	0 LF/SF	0 LF/SF
EPHEMERAL WUS	0 LF/SF	0 LF/SF
WETLAND BUFFER	0 SF	2,388 SF
100-YEAR FLOODPLAIN	0 SF	0 SF

WETLAND IMPACT PLATE

I-95 ETL NORTHBOUND EXTENSION
 PHASE II
 MD 24 INTERCHANGE
 I-95 NB ETL TWO-LANE EXTENSION
 HARFORD COUNTY, MARYLAND



**MARYLAND
 TRANSPORTATION AUTHORITY**

SCALE: 1" = 60'

CONTRACT NO.: KH-3021

DATE: JUNE 2019

PLATE 16 OF 22

FILE: \$FILE\$
 DATE: \$DATE\$

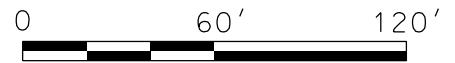
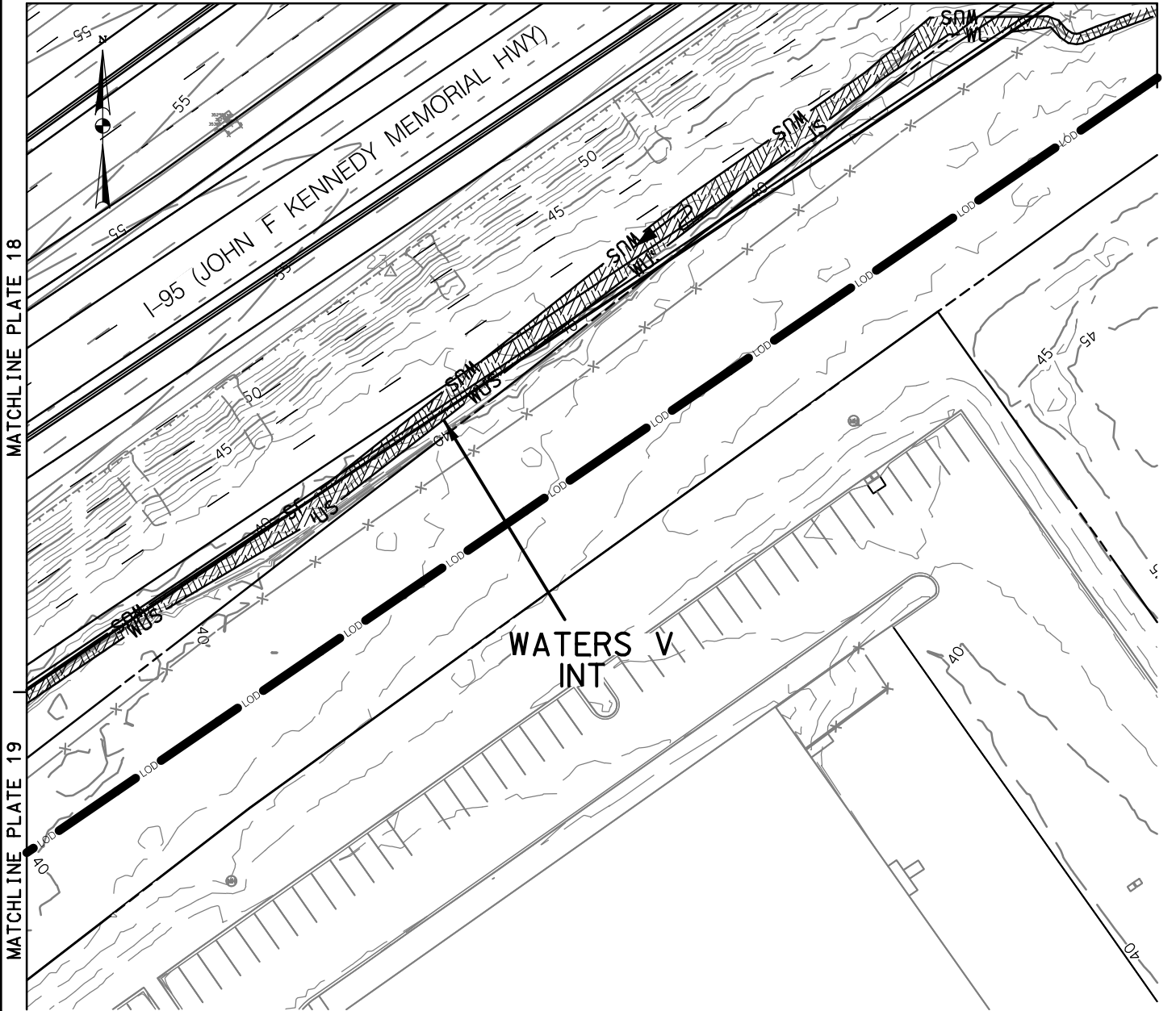

IMPACTS ON THIS PLATE

	TEMPORARY	PERMANENT
PFO WETLAND	0 SF	0 SF
PSS WETLAND	0 SF	0 SF
PEM WETLAND	0 SF	0 SF
PERENNIAL WUS	0 LF/SF	0 LF/SF
INTERMITTENT WUS	0 LF/SF	528/3,851 LF/SF
EPHEMERAL WUS	0 LF/SF	0 LF/SF
WETLAND BUFFER	0 SF	0 SF
100-YEAR FLOODPLAIN	0 SF	0 SF

WETLAND IMPACT PLATE

I-95 ETL NORTHBOUND EXTENSION
 PHASE II
 MD 24 INTERCHANGE
 I-95 NB ETL TWO-LANE EXTENSION
 HARFORD COUNTY, MARYLAND



**MARYLAND 05
 TRANSPORTATION AUTHORITY**

SCALE: 1" = 60'

CONTRACT NO.: KH-3021

DATE: JUNE 2019

PLATE 17 OF 22

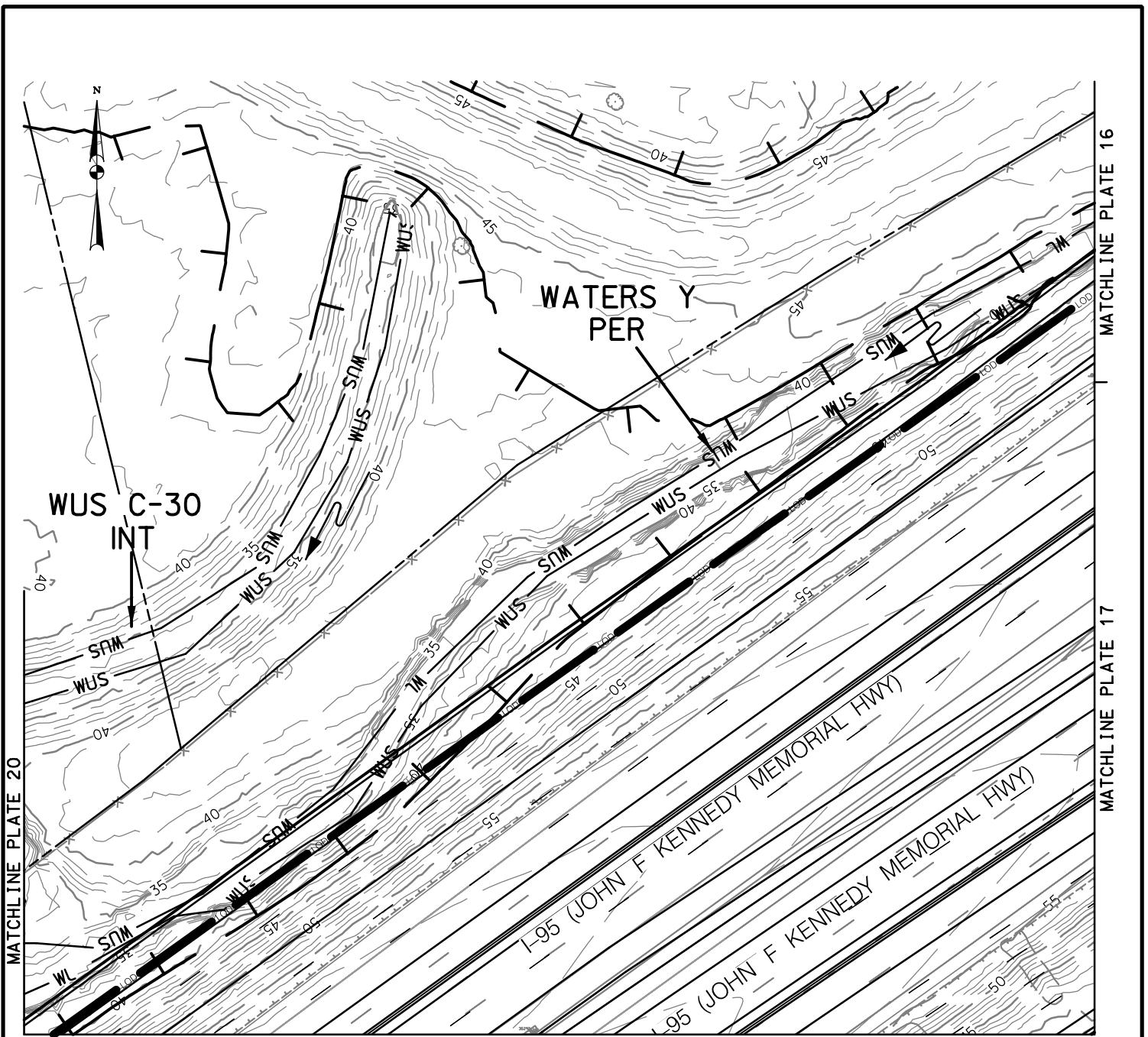

MATCHLINE PLATE 19

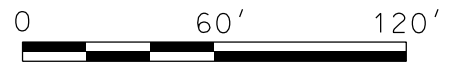

IMPACTS ON THIS PLATE

	TEMPORARY	PERMANENT
PFO WETLAND	0 SF	0 SF
PSS WETLAND	0 SF	0 SF
PEM WETLAND	0 SF	0 SF
PERENNIAL WUS	0 LF/SF	0 LF/SF
INTERMITTENT WUS	0 LF/SF	1/1 LF/SF
EPHEMERAL WUS	0 LF/SF	0 LF/SF
WETLAND BUFFER	0 SF	0 SF
100-YEAR FLOODPLAIN	0 SF	1,422 SF

WETLAND IMPACT PLATE

I-95 ETL NORTHBOUND EXTENSION
 PHASE II
 MD 24 INTERCHANGE
 I-95 NB ETL TWO-LANE EXTENSION
 HARFORD COUNTY, MARYLAND



**MARYLAND
 TRANSPORTATION AUTHORITY**

SCALE: 1" = 60'

CONTRACT NO.: KH-3021

DATE: JUNE 2019

PLATE 18 OF 22

MATCHLINE PLATE 18

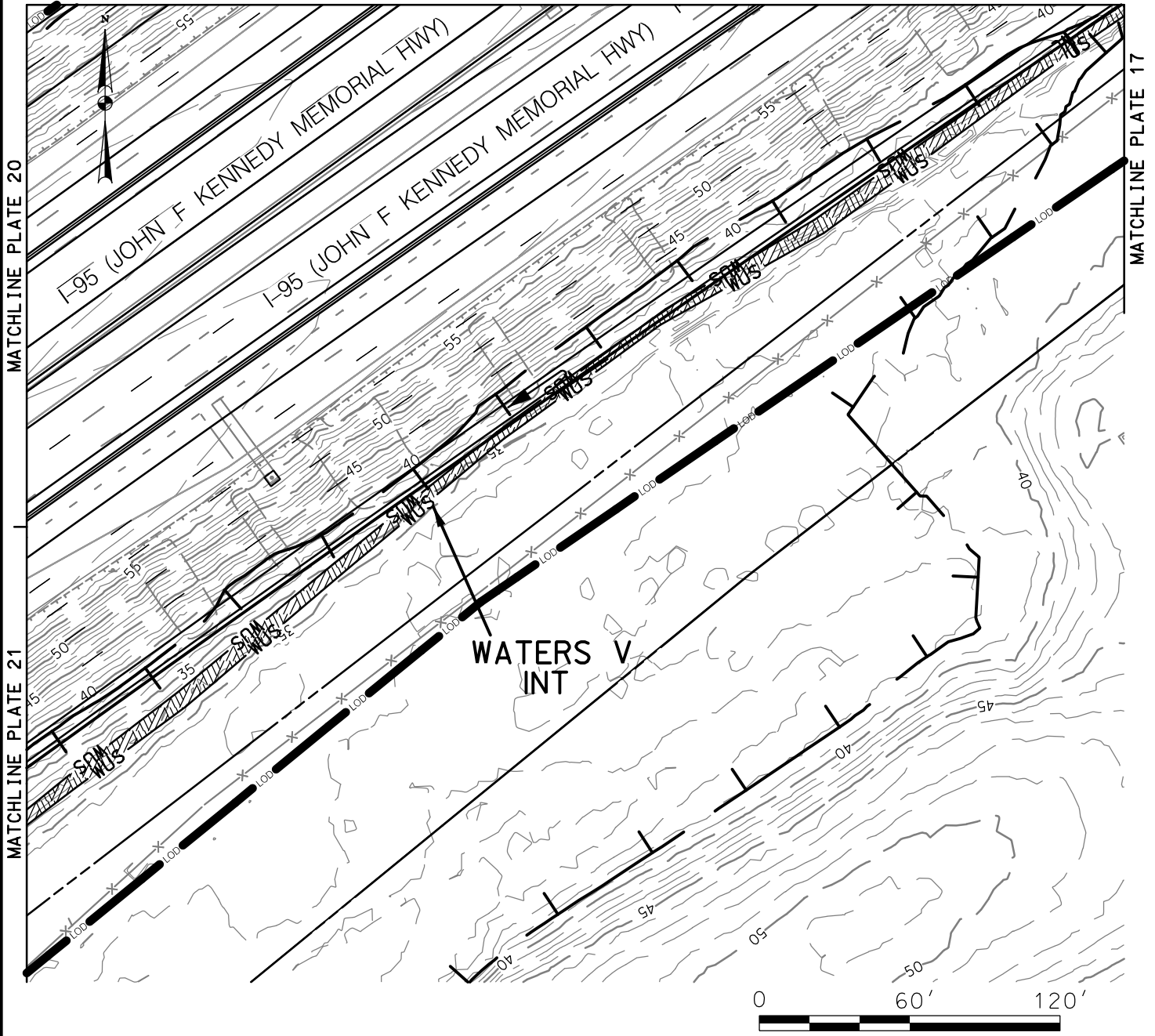

IMPACTS ON THIS PLATE

	TEMPORARY	PERMANENT
PFO WETLAND	0 SF	0 SF
PSS WETLAND	0 SF	0 SF
PEM WETLAND	0 SF	0 SF
PERENNIAL WUS	0 LF/SF	0 LF/SF
INTERMITTENT WUS	0 LF/SF	543/2,809 LF/SF
EPHEMERAL WUS	0 LF/SF	0 LF/SF
WETLAND BUFFER	0 SF	0 SF
100-YEAR FLOODPLAIN	0 SF	33,223 SF

WETLAND IMPACT PLATE

I-95 ETL NORTHBOUND EXTENSION
 PHASE II
 MD 24 INTERCHANGE
 I-95 NB ETL TWO-LANE EXTENSION
 HARFORD COUNTY, MARYLAND



**MARYLAND
 TRANSPORTATION AUTHORITY**

SCALE: 1" = 60'

CONTRACT NO.: KH-3021

DATE: JUNE 2019

PLATE 19 OF 22

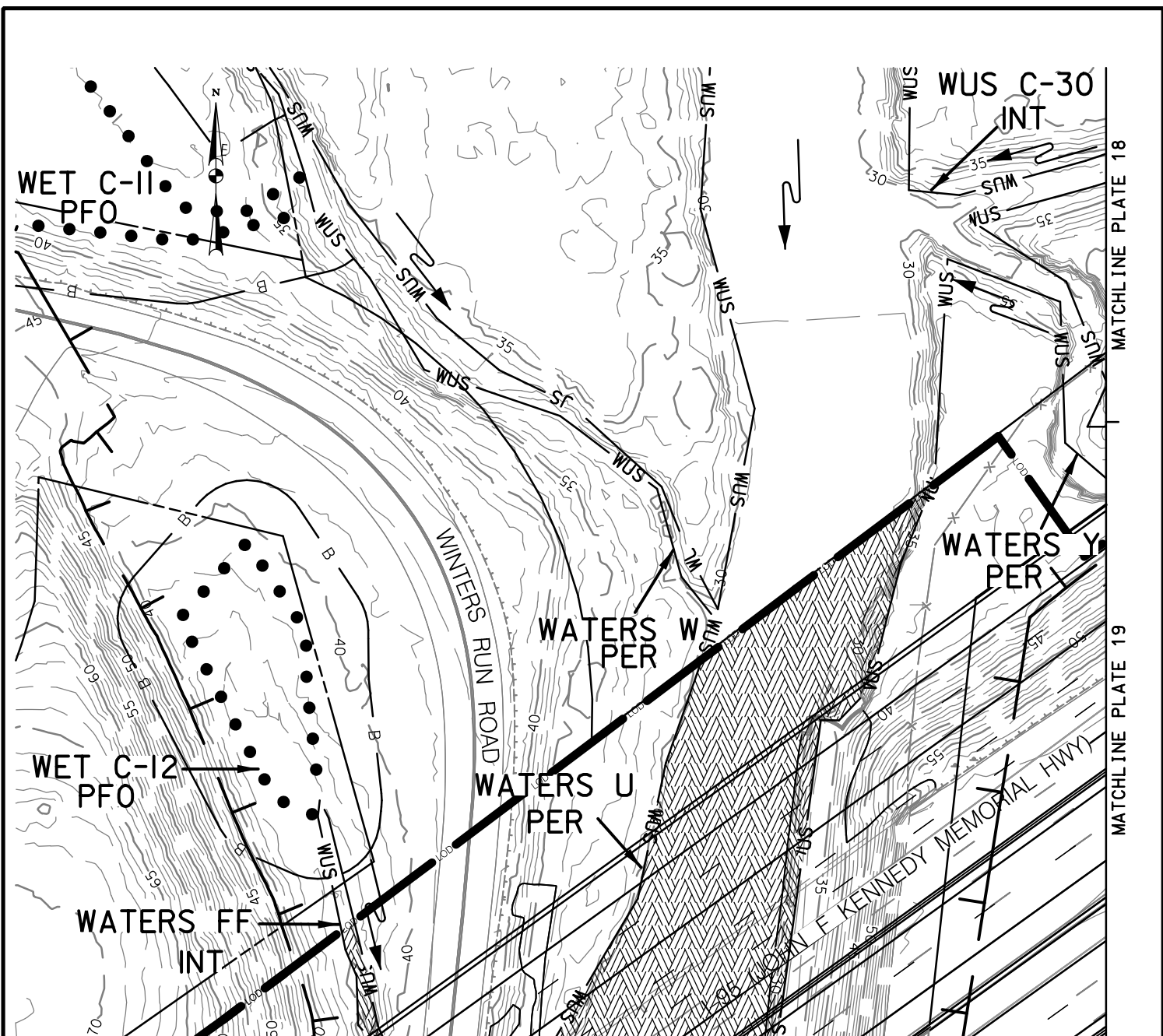

MATCHLINE PLATE 21

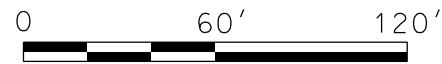

IMPACTS ON THIS PLATE

	TEMPORARY	PERMANENT
PFO WETLAND	0 SF	0 SF
PSS WETLAND	0 SF	0 SF
PEM WETLAND	0 SF	0 SF
PERENNIAL WUS	0 LF/SF	212/12,708 LF/SF
INTERMITTENT WUS	0 LF/SF	48/269 LF/SF
EPHEMERAL WUS	0 LF/SF	0 LF/SF
WETLAND BUFFER	0 SF	0 SF
100-YEAR FLOODPLAIN	0 SF	39,572 SF

WETLAND IMPACT PLATE

I-95 ETL NORTHBOUND EXTENSION
 PHASE II
 MD 24 INTERCHANGE
 I-95 NB ETL TWO-LANE EXTENSION
 HARFORD COUNTY, MARYLAND



**MARYLAND
 TRANSPORTATION AUTHORITY**

SCALE: 1" = 60'

CONTRACT NO.: KH-3021

DATE: JUNE 2019

PLATE 20 OF 22

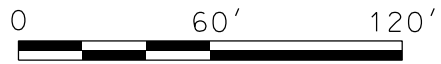
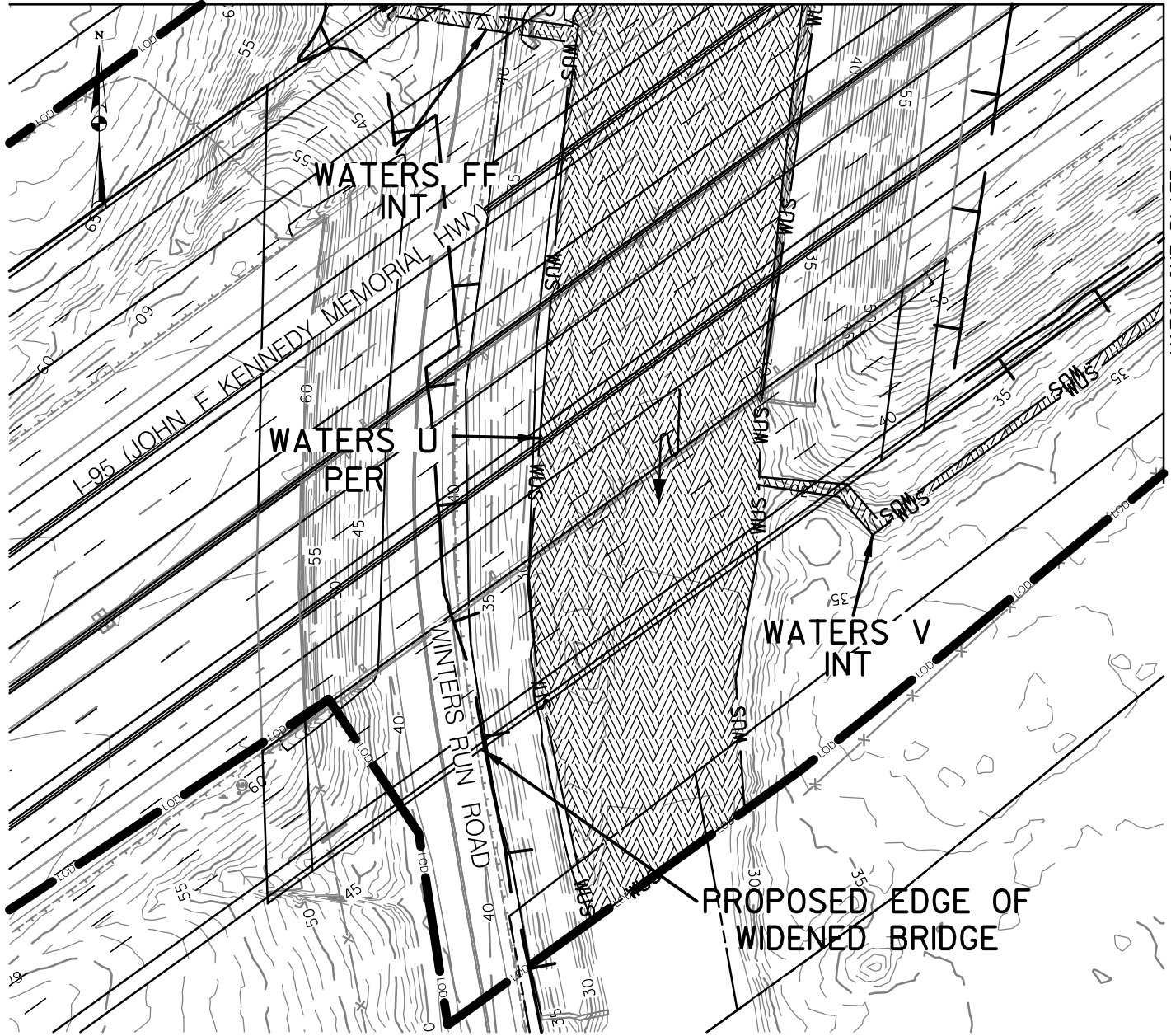

IMPACTS ON THIS PLATE

	TEMPORARY	PERMANENT
PFO WETLAND	0 SF	0 SF
PSS WETLAND	0 SF	0 SF
PEM WETLAND	0 SF	0 SF
PERENNIAL WUS	0 LF/SF	328/26,918 LF/SF
INTERMITTENT WUS	0 LF/SF	258/1,098 LF/SF
EPHEMERAL WUS	0 LF/SF	0 LF/SF
WETLAND BUFFER	0 SF	0 SF
100-YEAR FLOODPLAIN	0 SF	69,228 SF

WETLAND IMPACT PLATE

I-95 ETL NORTHBOUND EXTENSION
 PHASE II
 MD 24 INTERCHANGE
 I-95 NB ETL TWO-LANE EXTENSION
 HARFORD COUNTY, MARYLAND



**MARYLAND
 TRANSPORTATION AUTHORITY**

SCALE: 1" = 60'

CONTRACT NO.: KH-3021

DATE: JUNE 2019

PLATE 21 OF 22

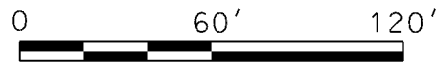
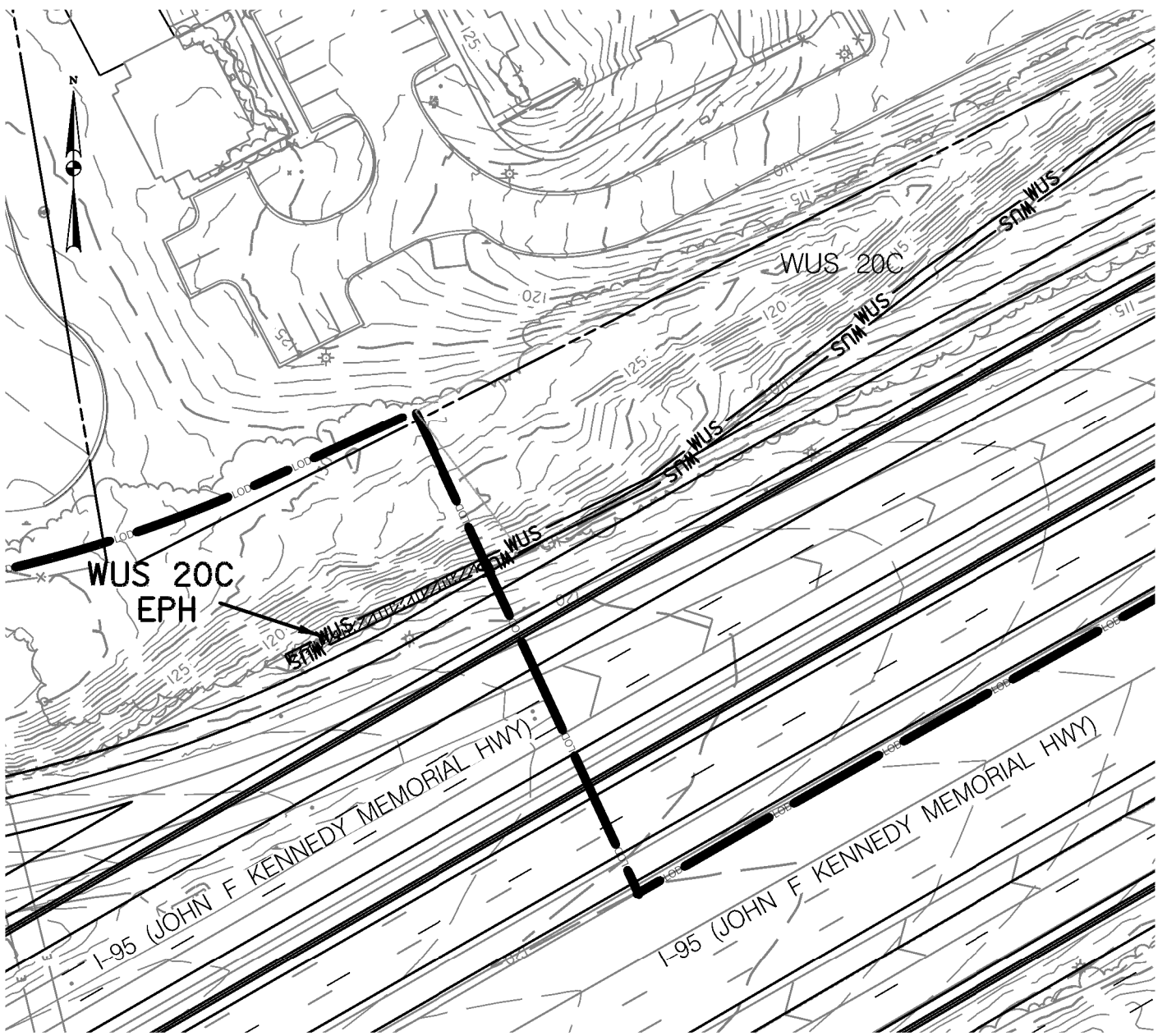

IMPACTS ON THIS PLATE

	TEMPORARY	PERMANENT
PFO WETLAND	0 SF	0 SF
PSS WETLAND	0 SF	0 SF
PEM WETLAND	0 SF	0 SF
PERENNIAL WUS	0 LF/SF	0 LF/SF
INTERMITTENT WUS	0 LF/SF	0 LF/SF
EPHEMERAL WUS	0 LF/SF	84/336 LF/SF
WETLAND BUFFER	0 SF	0 SF
100-YEAR FLOODPLAIN	0 SF	0 SF

WETLAND IMPACT PLATE

I-95 ETL NORTHBOUND EXTENSION
 PHASE II
 MD 24 INTERCHANGE
 I-95 NB ETL TWO-LANE EXTENSION
 HARFORD COUNTY, MARYLAND

**MARYLAND
 TRANSPORTATION AUTHORITY**

SCALE: 1" = 60'

CONTRACT NO.: KH-3021

DATE: JUNE 2019

PLATE 22 OF 22