

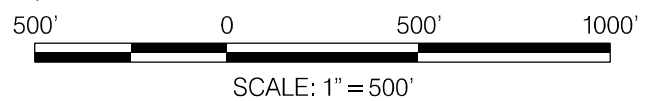

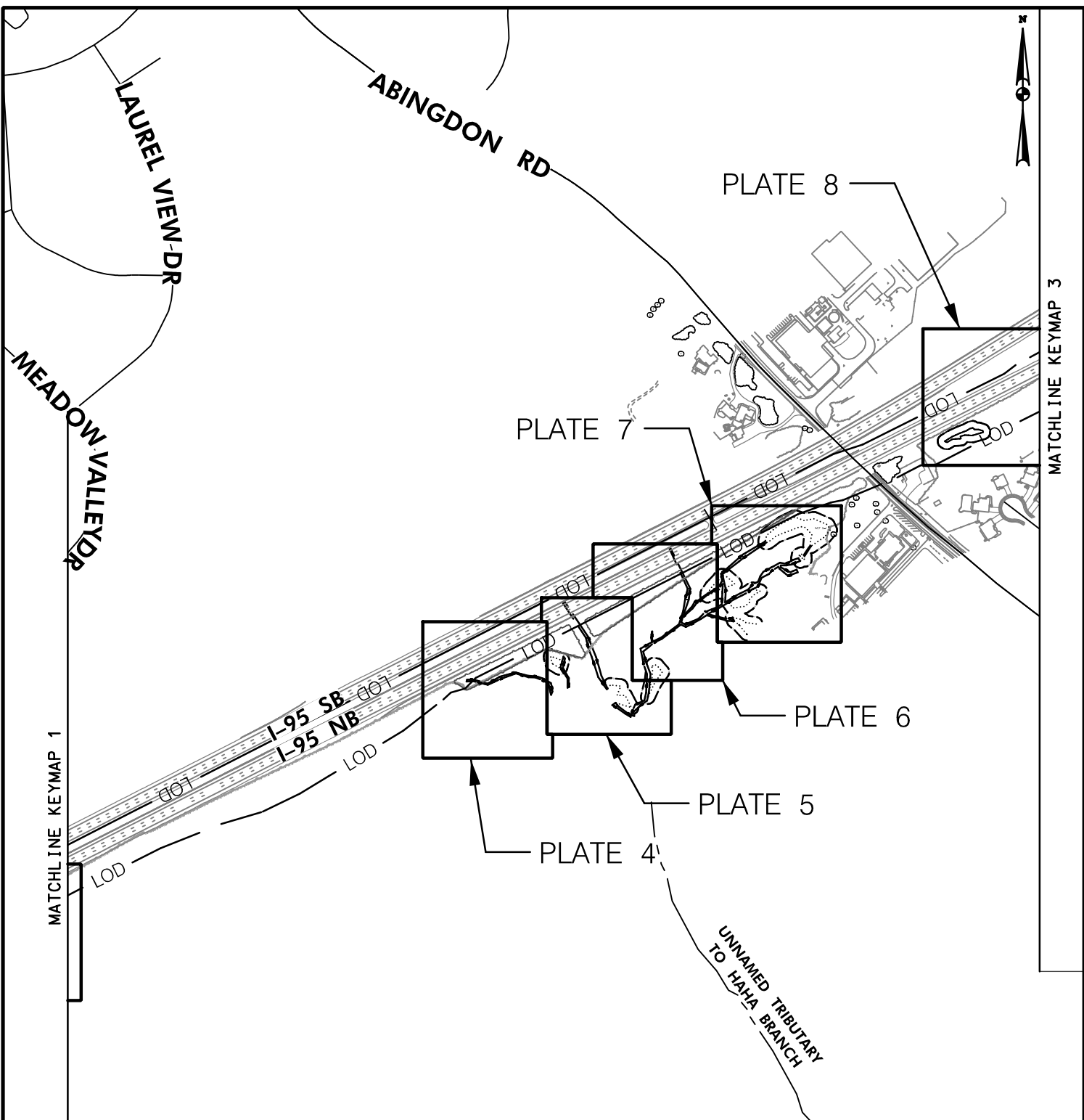

<p><b>IMPACT PLATE KEYMAP I</b></p> <p><b>I-95 ETL NORTHBOUND EXTENSION PHASE II</b></p> <p>I-95 ETL NB EXTENSION TO BYNUM RUN          NB NOISE WALL ON NB I-95 NORTH OF ABINGDON RD          HARFORD COUNTY, MARYLAND</p>	
 <p><b>MARYLAND TRANSPORTATION AUTHORITY</b></p>	
<p>CONTRACT NO.: KH-3020</p>	
<p>SCALE: 1" = 500'</p>	<p>DATE: OCTOBER 2019</p>



<b>IMPACT PLATE KEYMAP 2</b>	
<b>I-95 ETL NORTHBOUND EXTENSION PHASE II</b>	
I-95 ETL NB EXTENSION TO BYNUM RUN NB NOISE WALL ON NB I-95 NORTH OF ABINGDON RD HARFORD COUNTY, MARYLAND	
 <b>MARYLAND TRANSPORTATION AUTHORITY</b>	
CONTRACT NO.: KH-3020	
SCALE: 1" = 500'	DATE: OCTOBER 2019

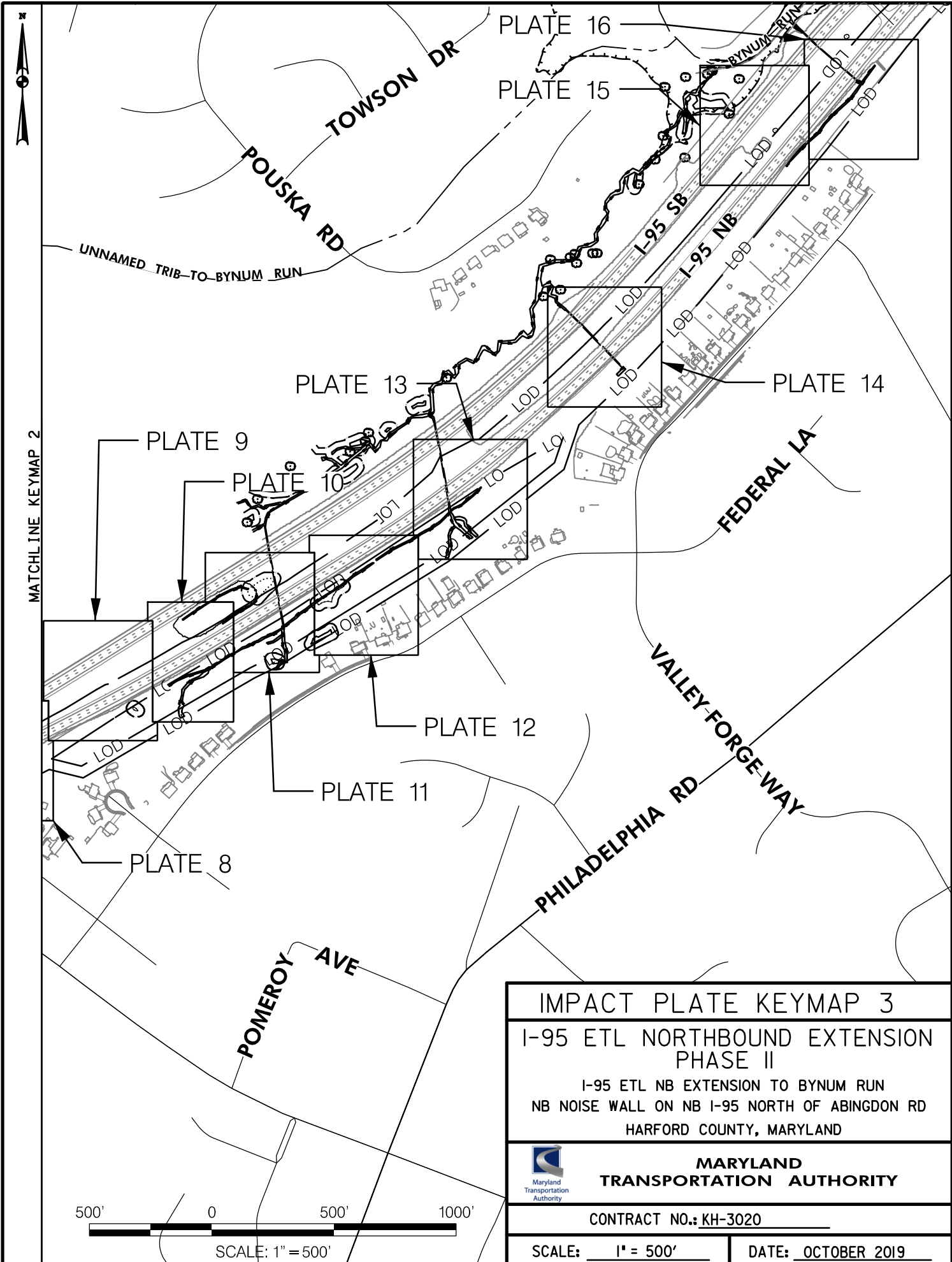

<b>IMPACT PLATE KEYMAP 3</b> <b>I-95 ETL NORTHBOUND EXTENSION</b> <b>PHASE II</b> I-95 ETL NB EXTENSION TO BYNUM RUN NB NOISE WALL ON NB I-95 NORTH OF ABINGDON RD HARFORD COUNTY, MARYLAND	
 <b>MARYLAND</b> <b>TRANSPORTATION AUTHORITY</b>	
CONTRACT NO.: <u>          KH-3020          </u>	
SCALE: <u>          1" = 500'          </u>	DATE: <u>          OCTOBER 2019          </u>

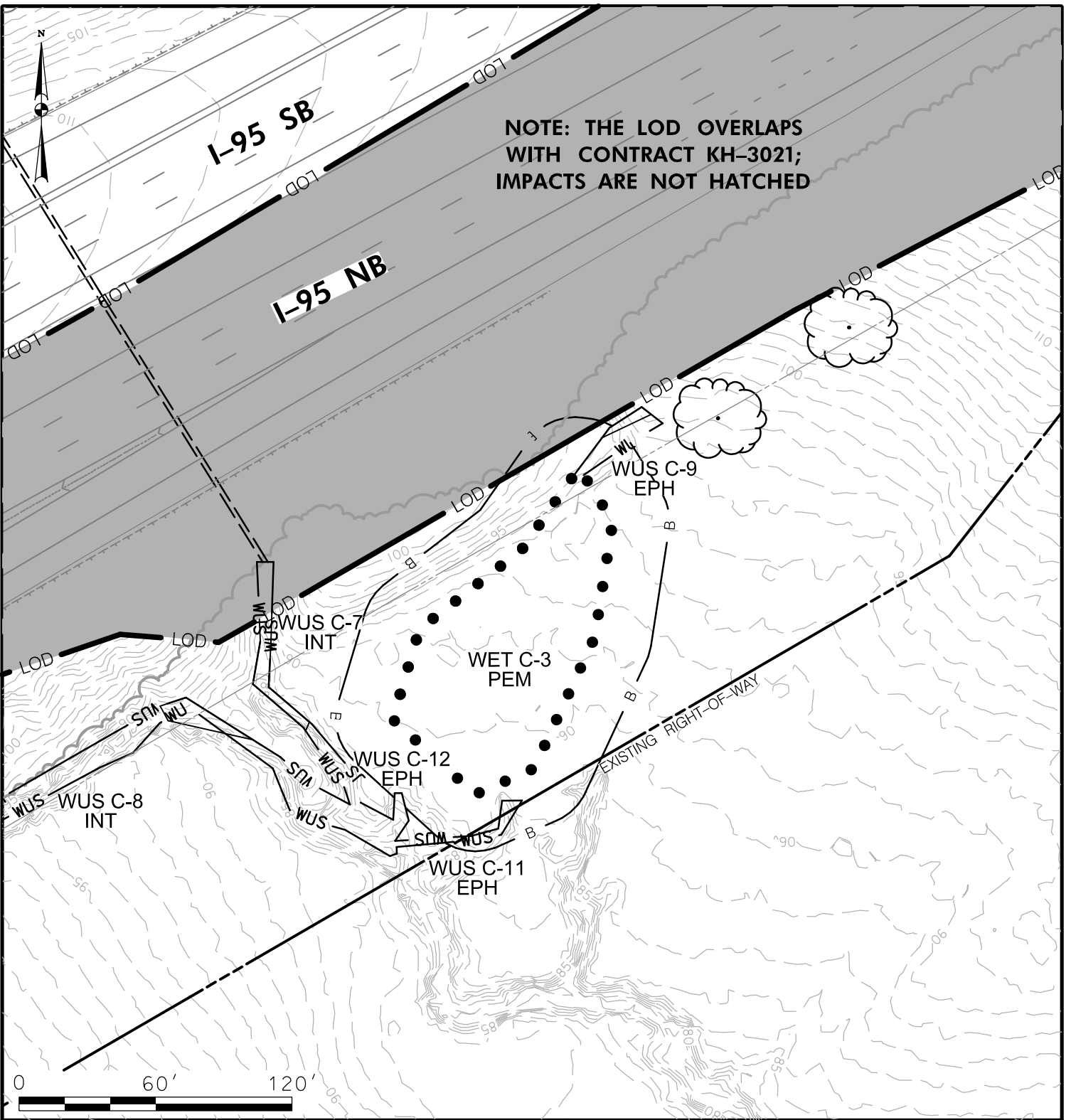

**IMPACTS ON THIS PLATE**

	TEMPORARY	PERMANENT
PFO WETLAND	0 SF	0 SF
PSS WETLAND	0 SF	0 SF
PEM WETLAND	0 SF	0 SF
PERENNIAL WUS	0 LF/SF	0/0 LF/SF
INTERMITTENT WUS	0 LF/SF	0 LF/SF
EPHEMERAL WUS	0 LF/SF	0 LF/SF
WETLAND BUFFER	0 SF	0 SF
100-YEAR FLOODPLAIN	0 SF	0 SF

**WETLAND IMPACT PLATE**

**I-95 ETL NORTHBOUND EXTENSION  
PHASE II**

I-95 ETL NB EXTENSION TO BYNUM RUN  
NB NOISE WALL ON NB I-95 NORTH OF ABINGDON RD  
HARFORD COUNTY, MARYLAND



**MARYLAND  
TRANSPORTATION AUTHORITY**

SCALE: 1" = 60'

CONTRACT NO.: KH-3020

DATE: OCTOBER 2019

PLATE 1 OF 16

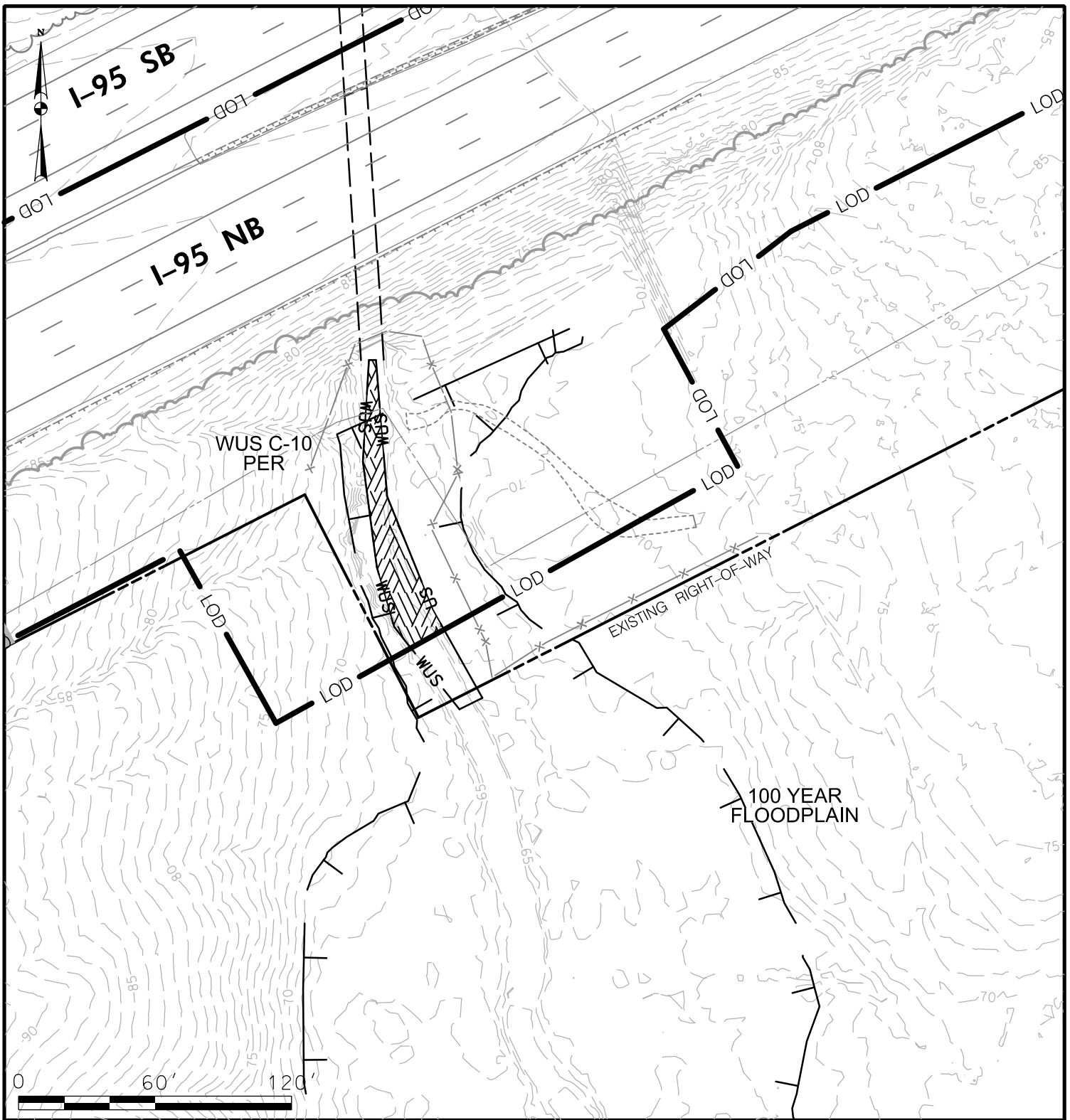

**IMPACTS ON THIS PLATE**

	TEMPORARY	PERMANENT
PFO WETLAND	0 SF	0 SF
PSS WETLAND	0 SF	0 SF
PEM WETLAND	0 SF	0 SF
PERENNIAL WUS	0 LF/SF	127/1,424 LF/SF
INTERMITTENT WUS	0 LF/SF	0 LF/SF
EPHEMERAL WUS	0 LF/SF	0 LF/SF
WETLAND BUFFER	0 SF	0 SF
100-YEAR FLOODPLAIN	0 SF	44,276 SF

**WETLAND IMPACT PLATE**

**I-95 ETL NORTHBOUND EXTENSION  
PHASE II**

I-95 ETL NB EXTENSION TO BYNUM RUN  
NB NOISE WALL ON NB I-95 NORTH OF ABINGDON RD  
HARFORD COUNTY, MARYLAND



**MARYLAND  
TRANSPORTATION AUTHORITY**

SCALE: 1" = 60'

CONTRACT NO.: KH-3020

DATE: OCTOBER 2019

PLATE 2 OF 16

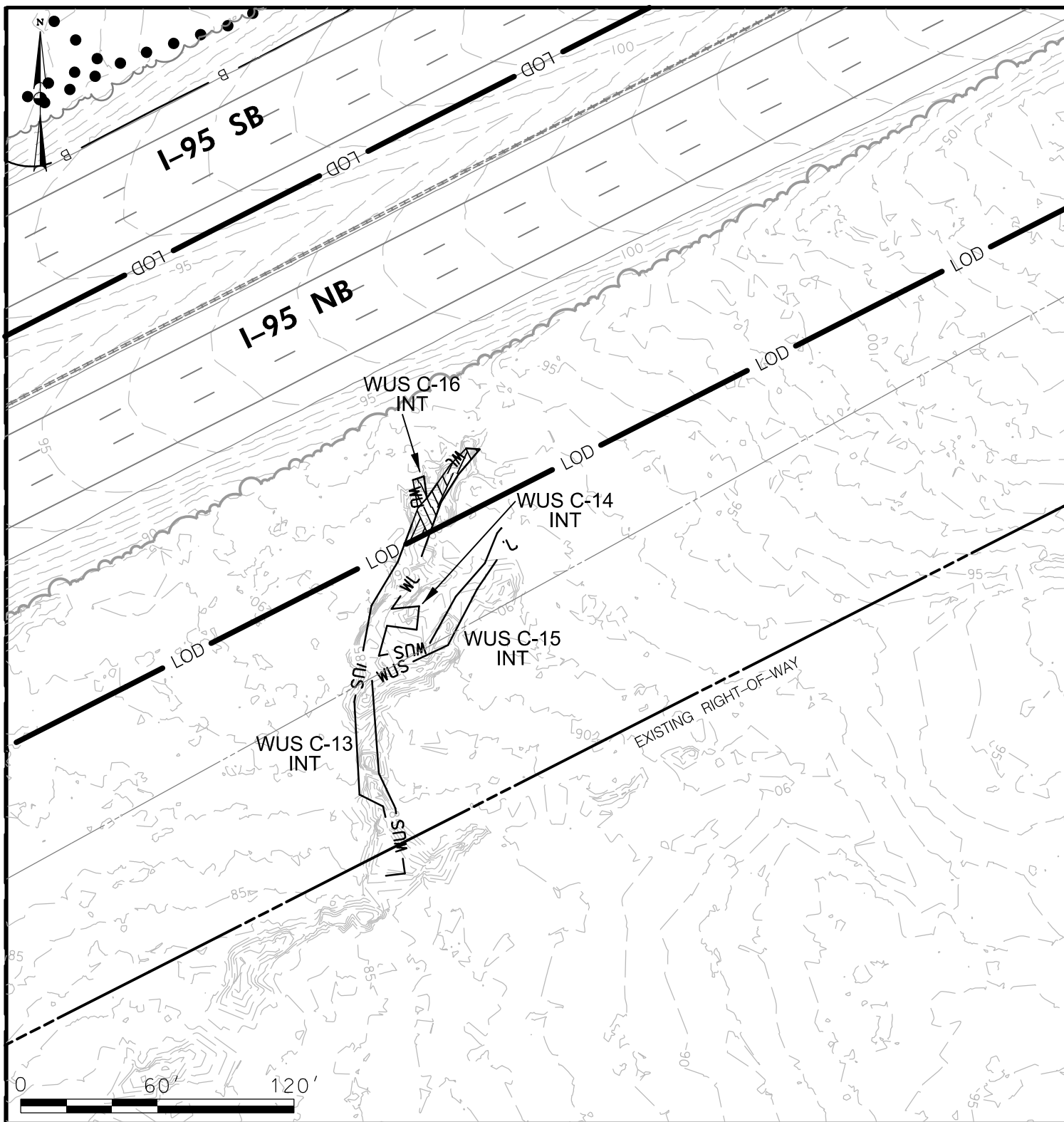

**IMPACTS ON THIS PLATE**

	TEMPORARY	PERMANENT
PFO WETLAND	0 SF	0 SF
PSS WETLAND	0 SF	0 SF
PEM WETLAND	0 SF	0 SF
PERENNIAL WUS	0 LF/SF	0 LF/SF
INTERMITTENT WUS	0 LF/SF	47/362 LF/SF
EPHEMERAL WUS	0 LF/SF	0 LF/SF
WETLAND BUFFER	0 SF	0 SF
100-YEAR FLOODPLAIN	0 SF	0 SF

**WETLAND IMPACT PLATE**

**I-95 ETL NORTHBOUND EXTENSION  
PHASE II**

I-95 ETL NB EXTENSION TO BYNUM RUN  
NB NOISE WALL ON NB I-95 NORTH OF ABINGDON RD  
HARFORD COUNTY, MARYLAND



**MARYLAND  
TRANSPORTATION AUTHORITY**

SCALE: 1" = 60'

CONTRACT NO.: KH-3020

DATE: OCTOBER 2019

PLATE 3 OF 16

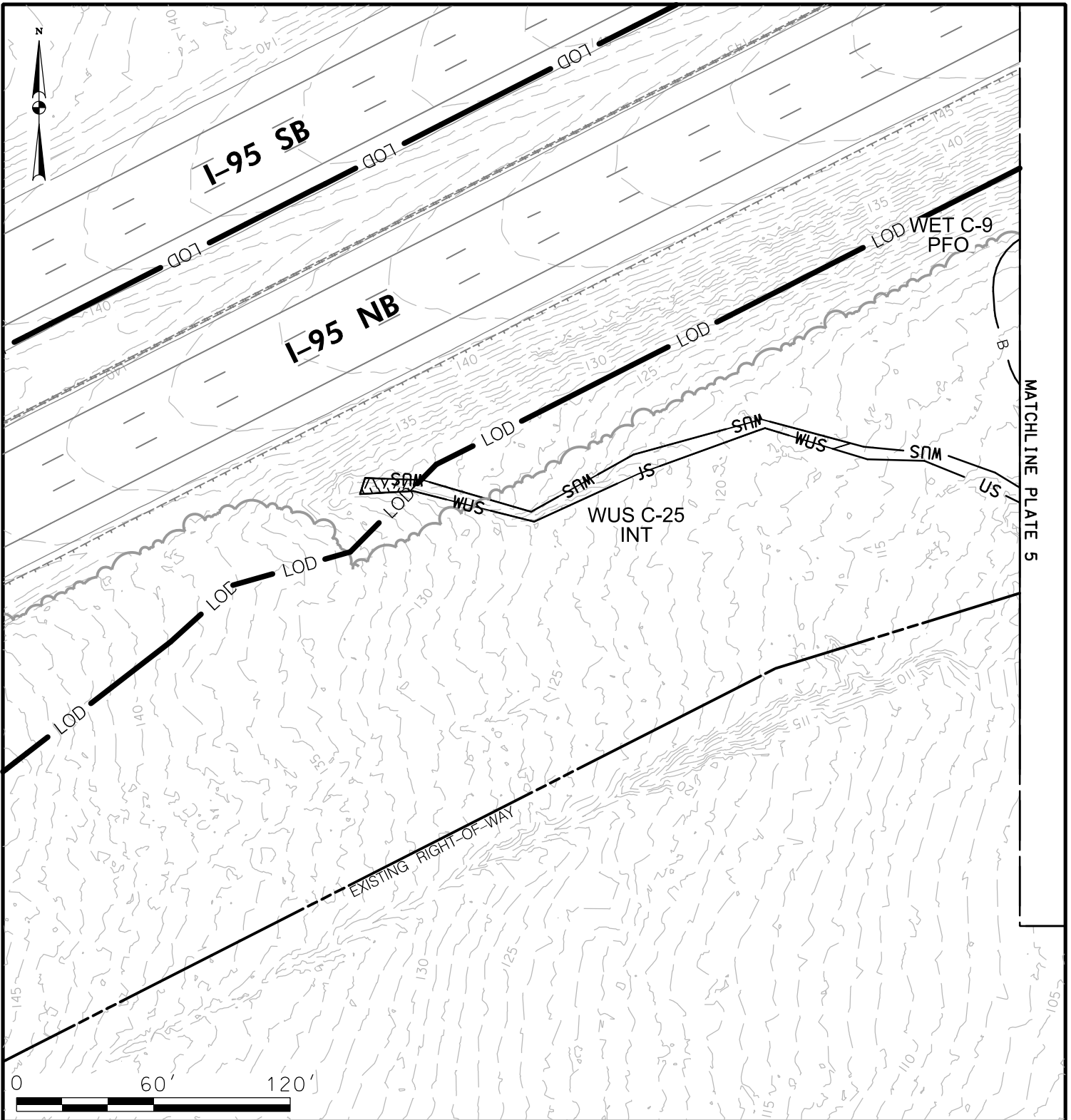

MATCHLINE PLATE 5

**IMPACTS ON THIS PLATE**

	TEMPORARY	PERMANENT
PFO WETLAND	0 SF	0 SF
PSS WETLAND	0 SF	0 SF
PEM WETLAND	0 SF	0 SF
PERENNIAL WUS	0 LF/SF	0 LF/SF
INTERMITTENT WUS	0 LF/SF	22/138 LF/SF
EPHEMERAL WUS	0 LF/SF	0 LF/SF
WETLAND BUFFER	0 SF	0 SF
100-YEAR FLOODPLAIN	0 SF	0 SF

**WETLAND IMPACT PLATE**

**I-95 ETL NORTHBOUND EXTENSION  
PHASE II**

I-95 ETL NB EXTENSION TO BYNUM RUN  
NB NOISE WALL ON NB I-95 NORTH OF ABINGDON RD  
HARFORD COUNTY, MARYLAND



**MARYLAND  
TRANSPORTATION AUTHORITY**

SCALE: 1" = 60'

CONTRACT NO.: KH-3020

DATE: OCTOBER 2019

PLATE 4 OF 16

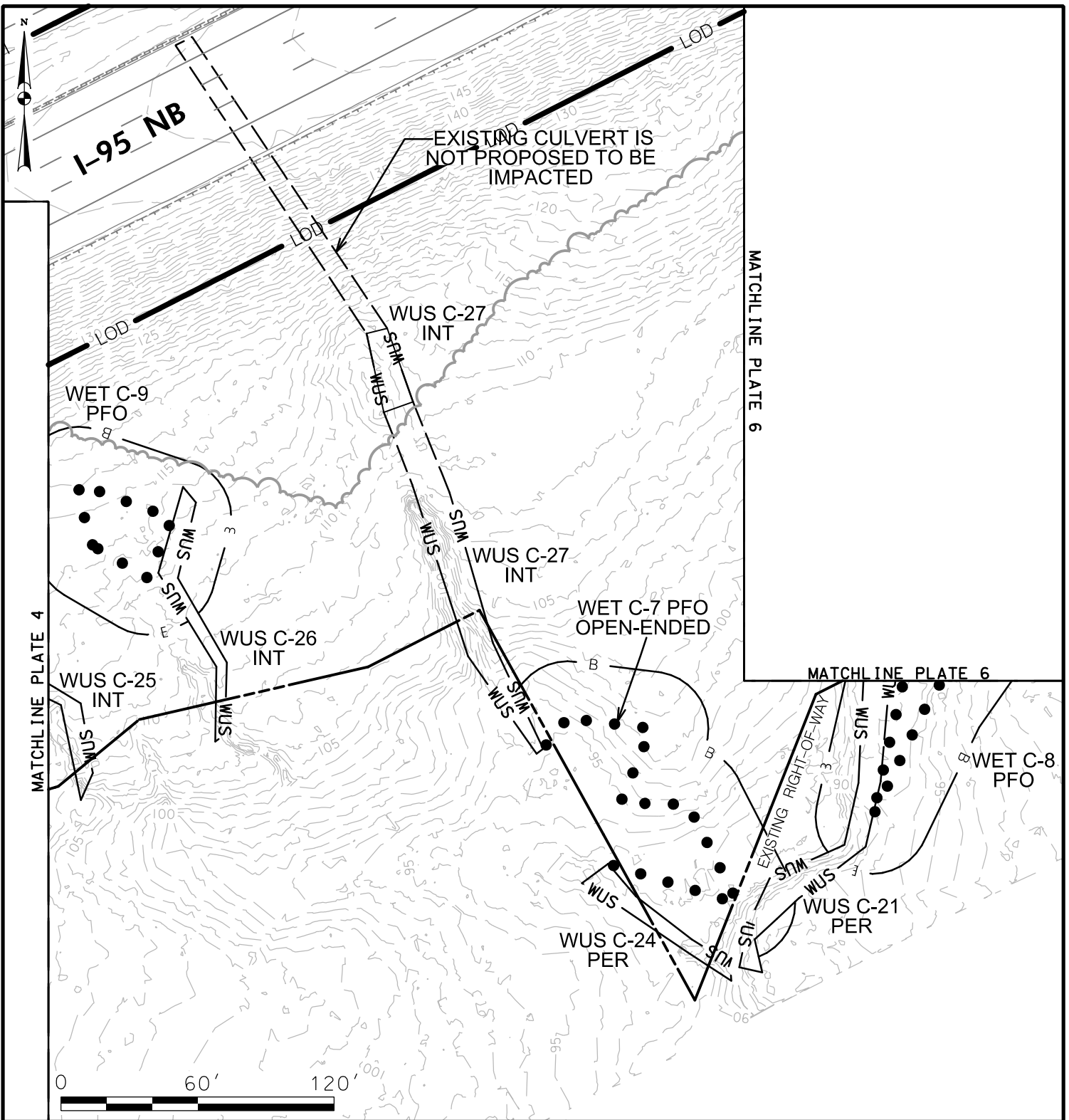

**IMPACTS ON THIS PLATE**

	TEMPORARY	PERMANENT
PFO WETLAND	0 SF	0 SF
PSS WETLAND	0 SF	0 SF
PEM WETLAND	0 SF	0 SF
PERENNIAL WUS	0 LF/SF	0 LF/SF
INTERMITTENT WUS	0/O LF/SF	0 LF/SF
EPHEMERAL WUS	0 LF/SF	0 LF/SF
WETLAND BUFFER	0 SF	0 SF
100-YEAR FLOODPLAIN	0 SF	0 SF

**WETLAND IMPACT PLATE**

**I-95 ETL NORTHBOUND EXTENSION  
PHASE II**

I-95 ETL NB EXTENSION TO BYNUM RUN  
NB NOISE WALL ON NB I-95 NORTH OF ABINGDON RD  
HARFORD COUNTY, MARYLAND



**MARYLAND  
TRANSPORTATION AUTHORITY**

SCALE: 1" = 60'

CONTRACT NO.: KH-3020

DATE: OCTOBER 2019

PLATE 5 OF 16



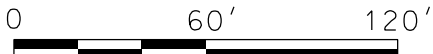
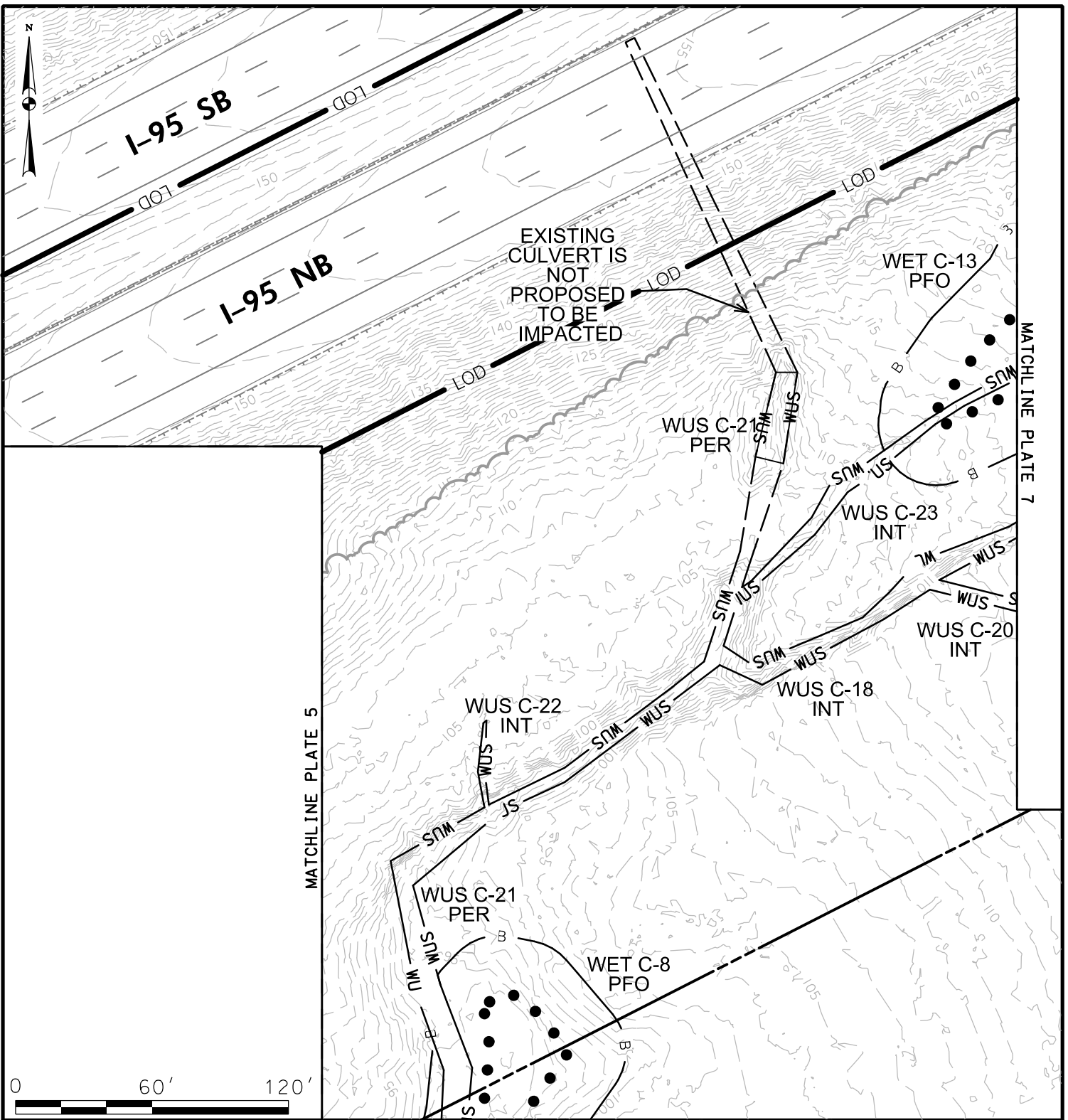

**IMPACTS ON THIS PLATE**

	TEMPORARY	PERMANENT
PFO WETLAND	0 SF	0 SF
PSS WETLAND	0 SF	0 SF
PEM WETLAND	0 SF	0 SF
PERENNIAL WUS	0/0 LF/SF	0/0 LF/SF
INTERMITTENT WUS	0 LF/SF	0 LF/SF
EPHEMERAL WUS	0 LF/SF	0 LF/SF
WETLAND BUFFER	0 SF	0 SF
100-YEAR FLOODPLAIN	0 SF	0 SF

**WETLAND IMPACT PLATE**

**I-95 ETL NORTHBOUND EXTENSION  
PHASE II**

I-95 ETL NB EXTENSION TO BYNUM RUN  
NB NOISE WALL ON NB I-95 NORTH OF ABINGDON RD  
HARFORD COUNTY, MARYLAND



**MARYLAND  
TRANSPORTATION AUTHORITY**

SCALE: 1" = 60'

CONTRACT NO.: KH-3020

DATE: OCTOBER 2019

PLATE 6 OF 16

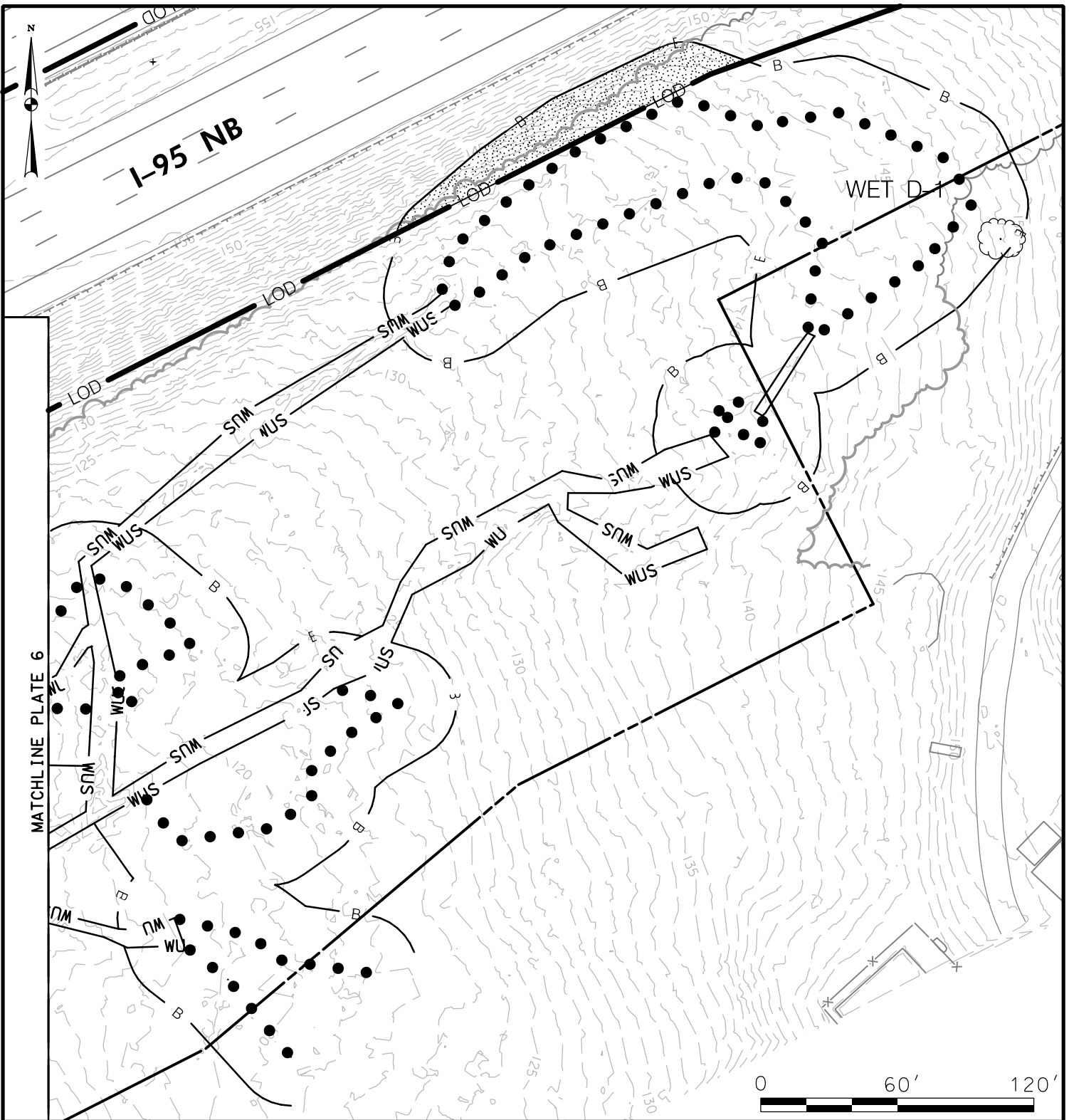

**IMPACTS ON THIS PLATE**

	TEMPORARY	PERMANENT
PFO WETLAND	0 SF	0 SF
PSS WETLAND	0 SF	0 SF
PEM WETLAND	0 SF	0 SF
PERENNIAL WUS	0 LF/SF	0 LF/SF
INTERMITTENT WUS	0/0 LF/SF	0 LF/SF
EPHEMERAL WUS	0 LF/SF	0 LF/SF
WETLAND BUFFER	0 SF	2,740 SF
100-YEAR FLOODPLAIN	0 SF	0 SF

**WETLAND IMPACT PLATE**

**I-95 ETL NORTHBOUND EXTENSION  
PHASE II**

I-95 ETL NB EXTENSION TO BYNUM RUN  
NB NOISE WALL ON NB I-95 NORTH OF ABINGDON RD  
HARFORD COUNTY, MARYLAND



**MARYLAND  
TRANSPORTATION AUTHORITY**

SCALE: 1" = 60'

CONTRACT NO.: KH-3020

DATE: OCTOBER 2019

PLATE 7 OF 16

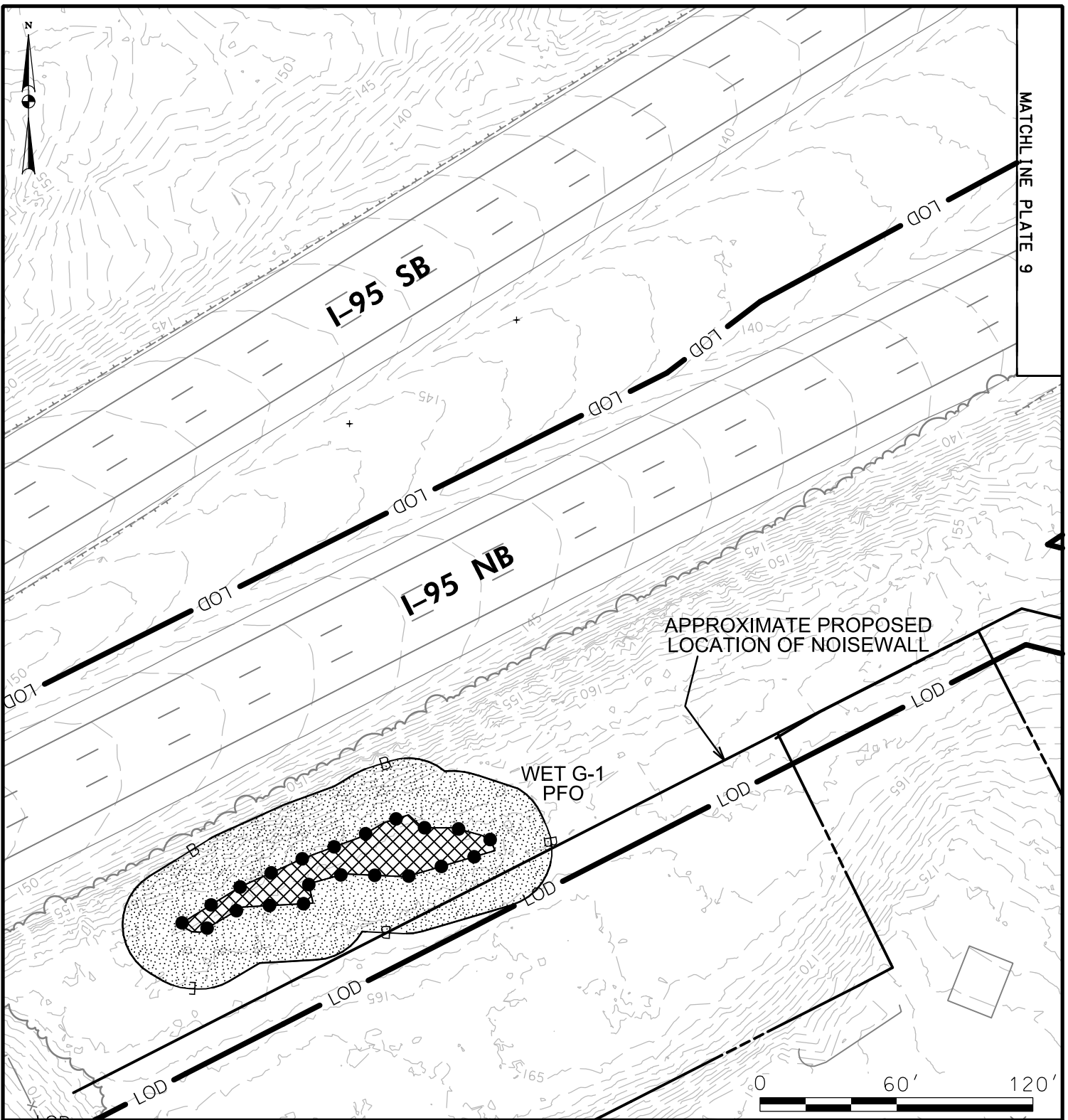

**IMPACTS ON THIS PLATE**

	TEMPORARY	PERMANENT
PFO WETLAND	0 SF	2,017 SF
PSS WETLAND	0 SF	0 SF
PEM WETLAND	0 SF	0 SF
PERENNIAL WUS	0 LF/SF	0 LF/SF
INTERMITTENT WUS	0 LF/SF	0 LF/SF
EPHEMERAL WUS	0 LF/SF	0 LF/SF
WETLAND BUFFER	0 SF	9,646 SF
100-YEAR FLOODPLAIN	0 SF	0 SF

**WETLAND IMPACT PLATE**

**I-95 ETL NORTHBOUND EXTENSION  
PHASE II**

I-95 ETL NB EXTENSION TO BYNUM RUN  
NB NOISE WALL ON NB I-95 NORTH OF ABINGDON RD  
HARFORD COUNTY, MARYLAND



**MARYLAND  
TRANSPORTATION AUTHORITY**

SCALE: 1" = 60'

CONTRACT NO.: KH-3020

DATE: OCTOBER 2019

PLATE 8 OF 16

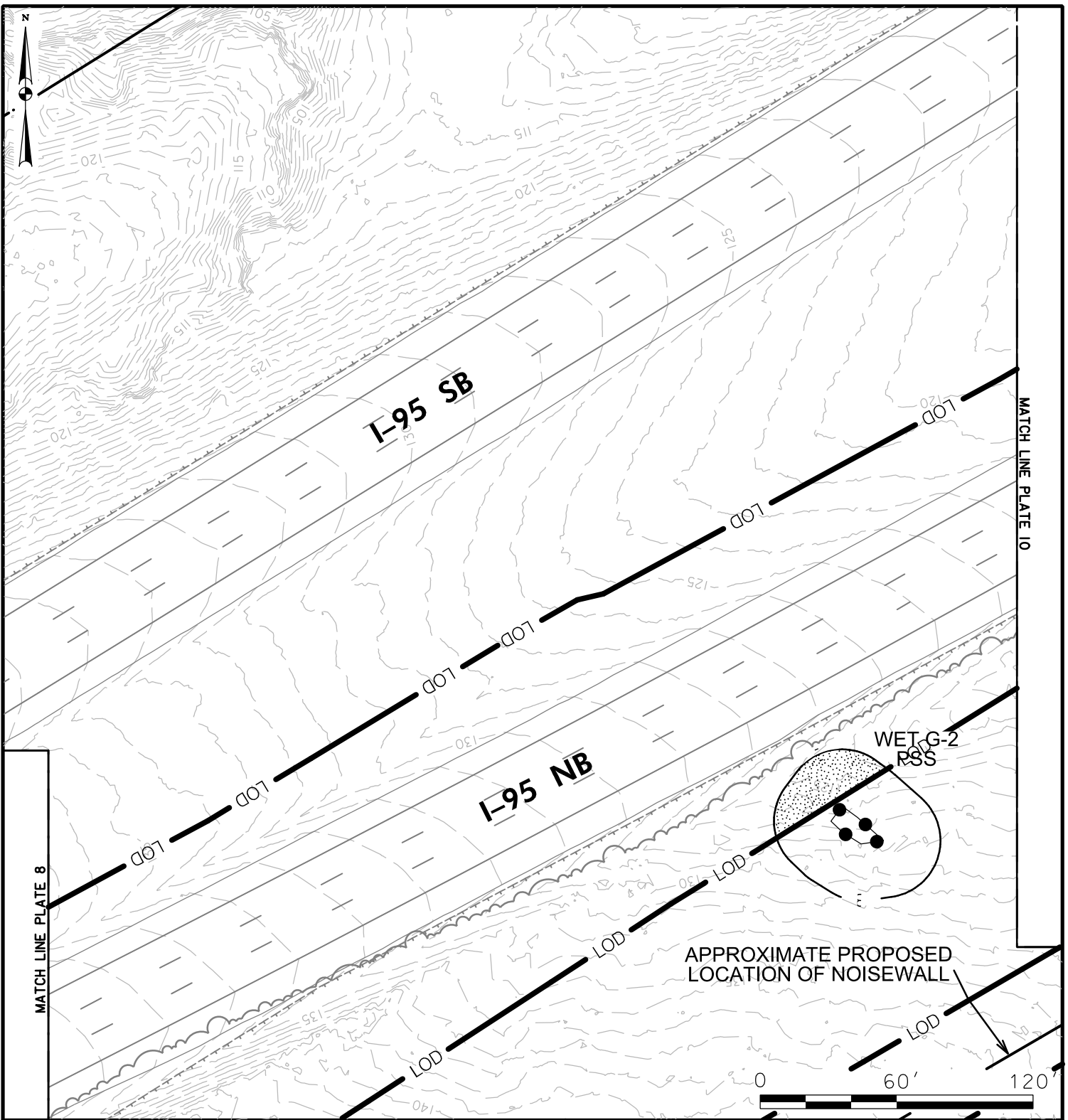

**IMPACTS ON THIS PLATE**

	TEMPORARY	PERMANENT
PFO WETLAND	0 SF	0 SF
PSS WETLAND	0 SF	0 SF
PEM WETLAND	0 SF	0 SF
PERENNIAL WUS	0 LF/SF	0 LF/SF
INTERMITTENT WUS	0 LF/SF	0 LF/SF
EPHEMERAL WUS	0 LF/SF	0 LF/SF
WETLAND BUFFER	0 SF	9IISF
100-YEAR FLOODPLAIN	0 SF	0 SF

**WETLAND IMPACT PLATE**

**I-95 ETL NORTHBOUND EXTENSION  
PHASE II**

I-95 ETL NB EXTENSION TO BYNUM RUN  
NB NOISE WALL ON NB I-95 NORTH OF ABINGDON RD  
HARFORD COUNTY, MARYLAND



**MARYLAND  
TRANSPORTATION AUTHORITY**

SCALE: 1" = 60'

CONTRACT NO.: KH-3020

DATE: OCTOBER 2019

PLATE 9 OF 16

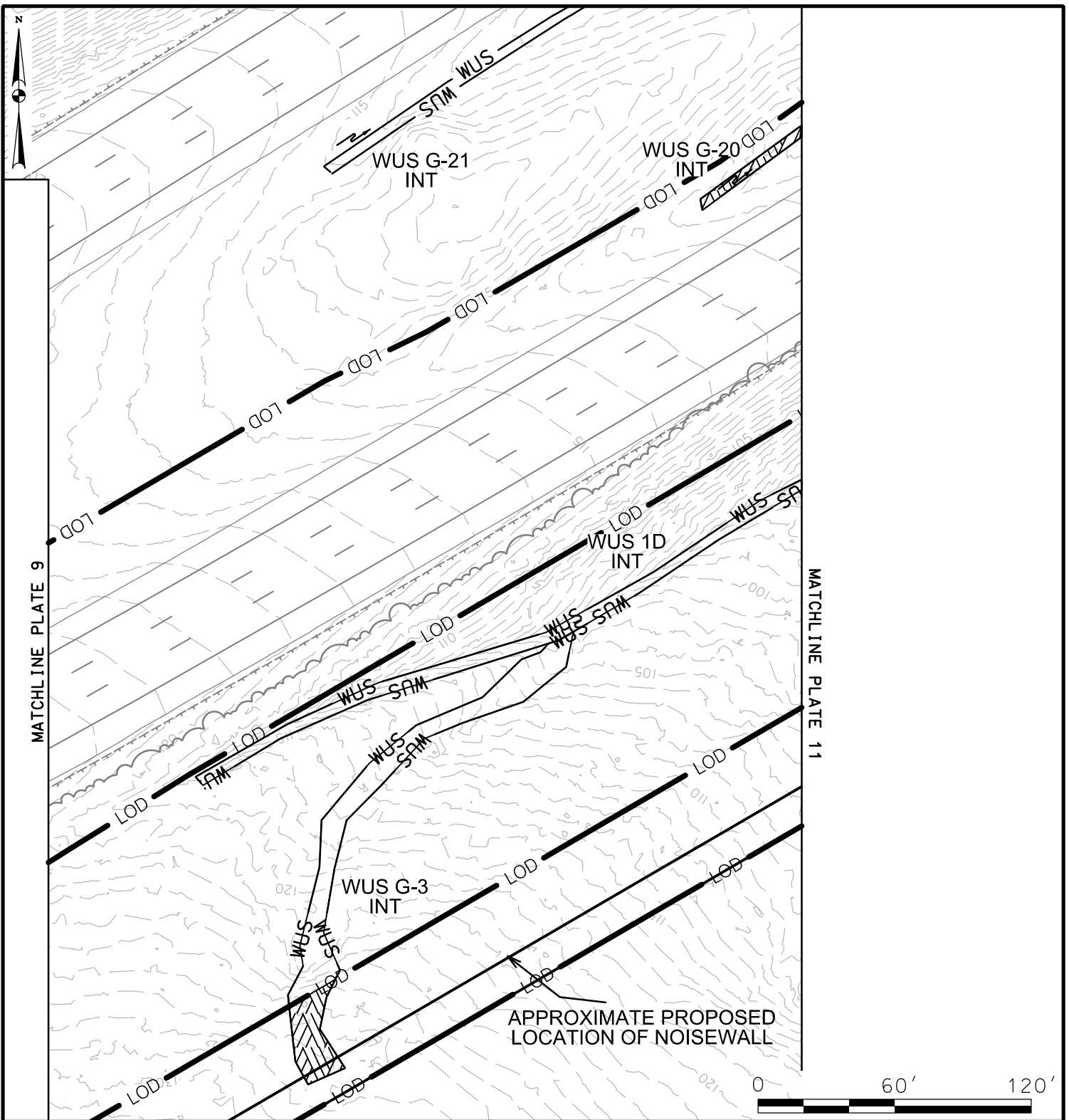

**IMPACTS ON THIS PLATE**

	TEMPORARY	PERMANENT
PFO WETLAND	0 SF	0 SF
PSS WETLAND	0 SF	0 SF
PEM WETLAND	0 SF	0 SF
PERENNIAL WUS	0 LF/SF	0 LF/SF
INTERMITTENT WUS	0 SF	94/821 LF/SF
EPHEMERAL WUS	0 LF/SF	0 LF/SF
WETLAND BUFFER	0 SF	0 SF
100-YEAR FLOODPLAIN	0 SF	0 SF

**WETLAND IMPACT PLATE**

**I-95 ETL NORTHBOUND EXTENSION  
PHASE II**

I-95 ETL NB EXTENSION TO BYNUM RUN  
NB NOISE WALL ON NB I-95 NORTH OF ABINGDON RD  
HARFORD COUNTY, MARYLAND



**MARYLAND  
TRANSPORTATION AUTHORITY**

SCALE: 1" = 60'

CONTRACT NO.: KH-3020

DATE: OCTOBER 2019

PLATE 10 OF 16

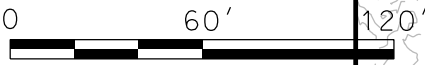
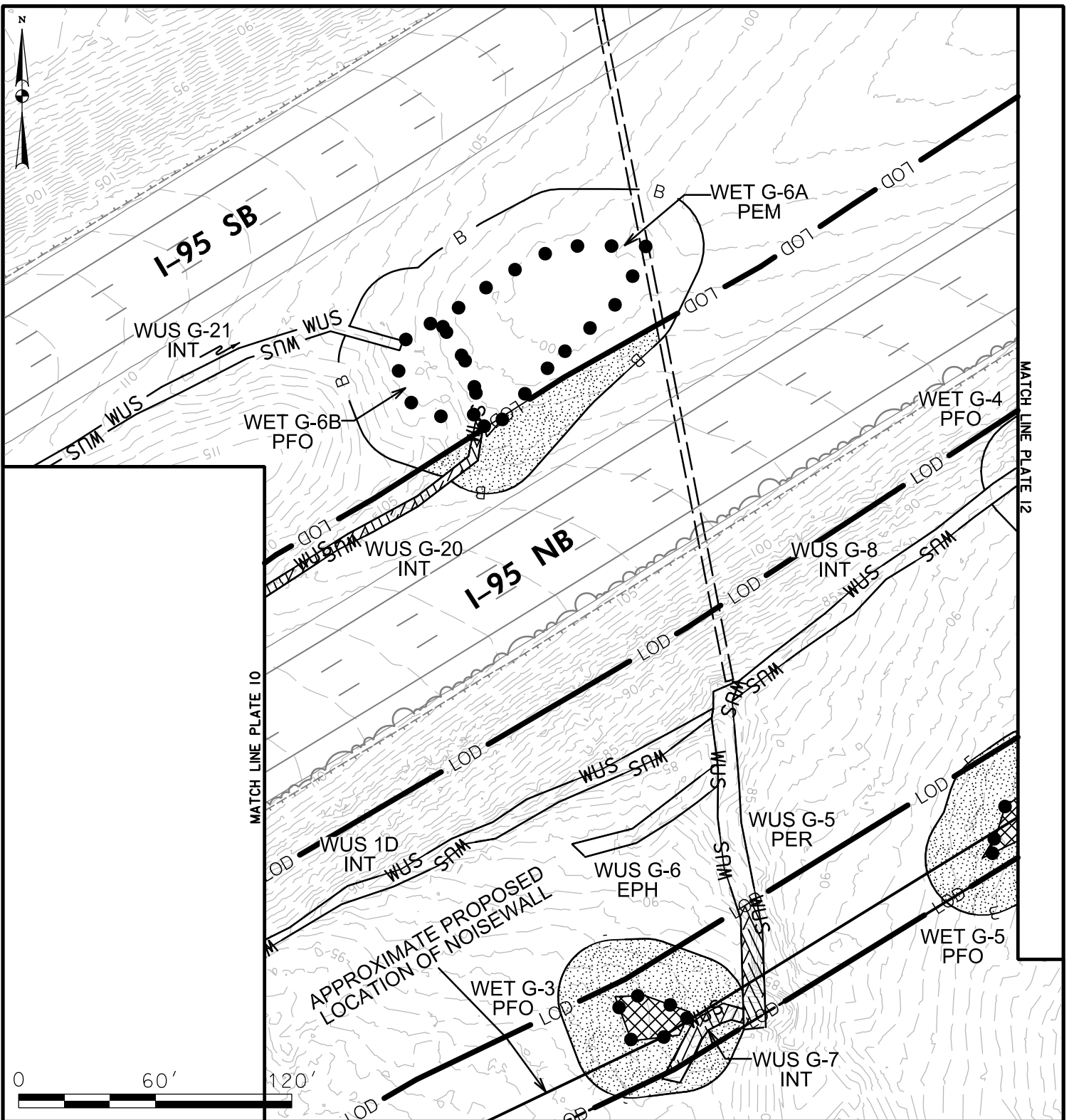

**IMPACTS ON THIS PLATE**

	TEMPORARY	PERMANENT
PFO WETLAND	0 SF	621 SF
PSS WETLAND	0 SF	0 SF
PEM WETLAND	0 SF	0 SF
PERENNIAL WUS	0 LF/SF	51/478 LF/SF
INTERMITTENT WUS	0 LF/SF	164/775 LF/SF
EPHEMERAL WUS	0 LF/SF	0 LF/SF
WETLAND BUFFER	0 SF	8,032 SF
100-YEAR FLOODPLAIN	0 SF	0 SF

**WETLAND IMPACT PLATE**

**I-95 ETL NORTHBOUND EXTENSION  
PHASE II**

I-95 ETL NB EXTENSION TO BYNUM RUN  
NB NOISE WALL ON NB I-95 NORTH OF ABINGDON RD  
HARFORD COUNTY, MARYLAND



**MARYLAND  
TRANSPORTATION AUTHORITY**

SCALE: 1" = 60'

CONTRACT NO.: KH-3020

DATE: OCTOBER 2019

PLATE 11 OF 16

FILE: T:\185649A - MDTA 2013-04 Compr. Prelim & Final Eng design\*Task 7 - Env Permit Management  
DATE: Tuesday, October 08, 2019 AT 10:24 AM

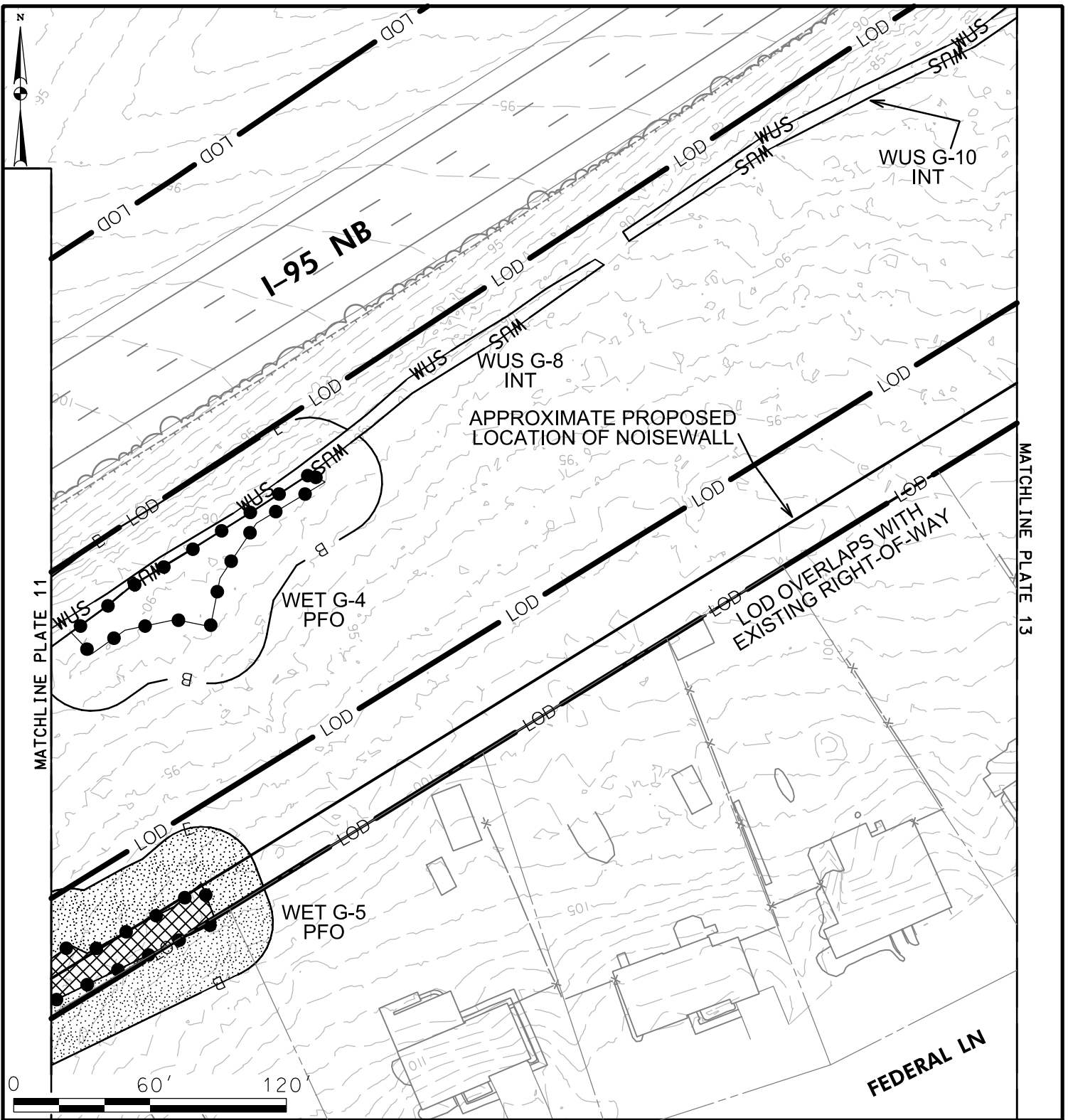

**IMPACTS ON THIS PLATE**

	TEMPORARY	PERMANENT
PFO WETLAND	0 SF	1,132 SF
PSS WETLAND	0 SF	0 SF
PEM WETLAND	0 SF	0 SF
PERENNIAL WUS	0 LF/SF	0 LF/SF
INTERMITTENT WUS	0 LF/SF	0 LF/SF
EPHEMERAL WUS	0 LF/SF	0 LF/SF
WETLAND BUFFER	0 SF	5,344 SF
100-YEAR FLOODPLAIN	0 SF	0 SF

**WETLAND IMPACT PLATE**

**I-95 ETL NORTHBOUND EXTENSION  
PHASE II**

I-95 ETL NB EXTENSION TO BYNUM RUN  
NB NOISE WALL ON NB I-95 NORTH OF ABINGDON RD  
HARFORD COUNTY, MARYLAND



**MARYLAND  
TRANSPORTATION AUTHORITY**

SCALE: 1" = 60'

CONTRACT NO.: KH-3020

DATE: OCTOBER 2019

PLATE 12 OF 16

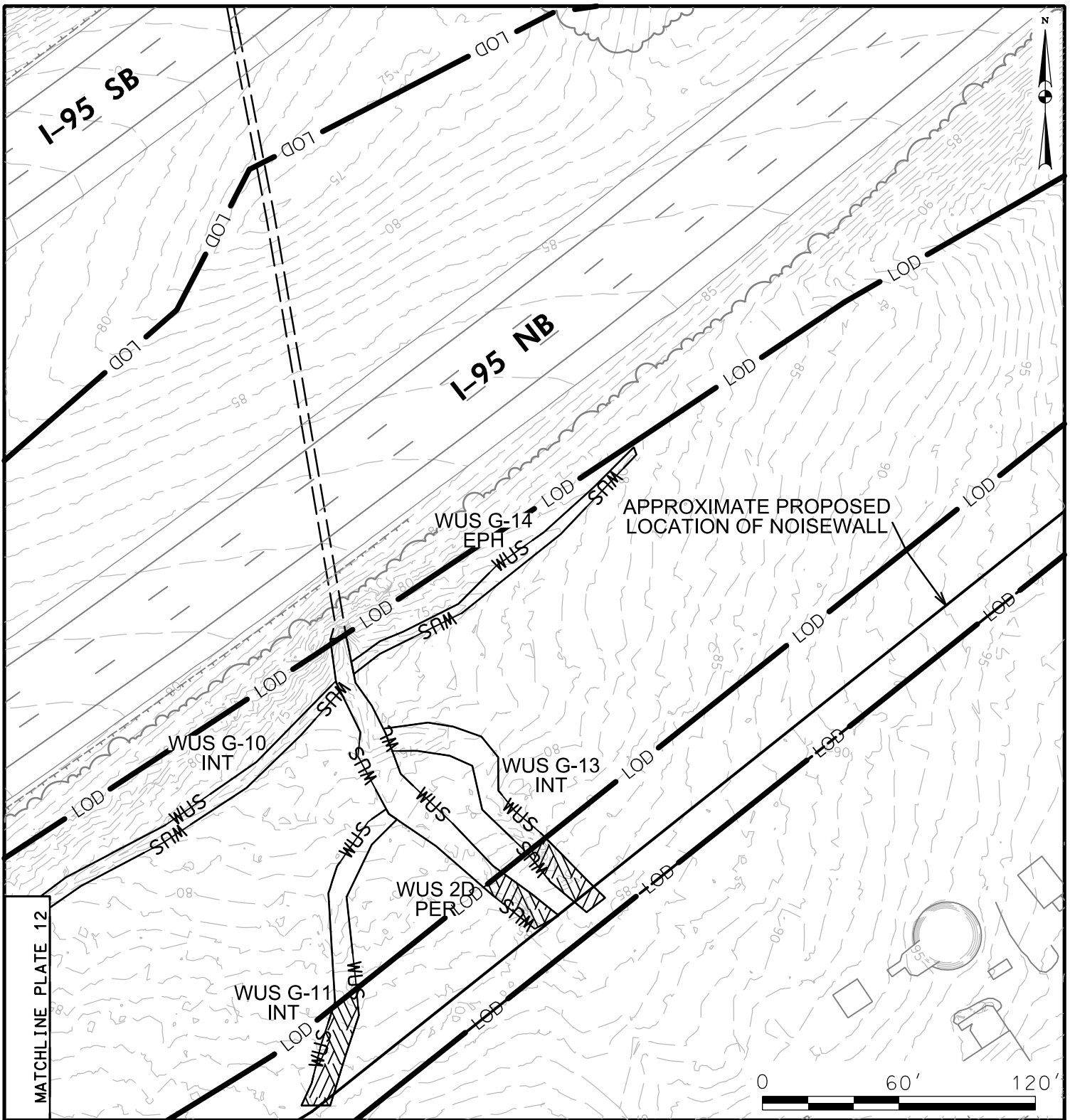

MATCHLINE PLATE 12

**IMPACTS ON THIS PLATE**

	TEMPORARY	PERMANENT
PFO WETLAND	0 SF	0 SF
PSS WETLAND	0 SF	0 SF
PEM WETLAND	0 SF	0 SF
PERENNIAL WUS	0 LF/SF	31/329 LF/SF
INTERMITTENT WUS	0 LF/SF	86/974 LF/SF
EPHEMERAL WUS	0 LF/SF	0 LF/SF
WETLAND BUFFER	0 SF	0 SF
100-YEAR FLOODPLAIN	0 SF	0 SF

**WETLAND IMPACT PLATE**

**I-95 ETL NORTHBOUND EXTENSION  
PHASE II**

I-95 ETL NB EXTENSION TO BYNUM RUN  
NB NOISE WALL ON NB I-95 NORTH OF ABINGDON RD  
HARFORD COUNTY, MARYLAND



**MARYLAND  
TRANSPORTATION AUTHORITY**

SCALE: 1" = 60'

CONTRACT NO.: KH-3020

DATE: OCTOBER 2019

PLATE 13 OF 16



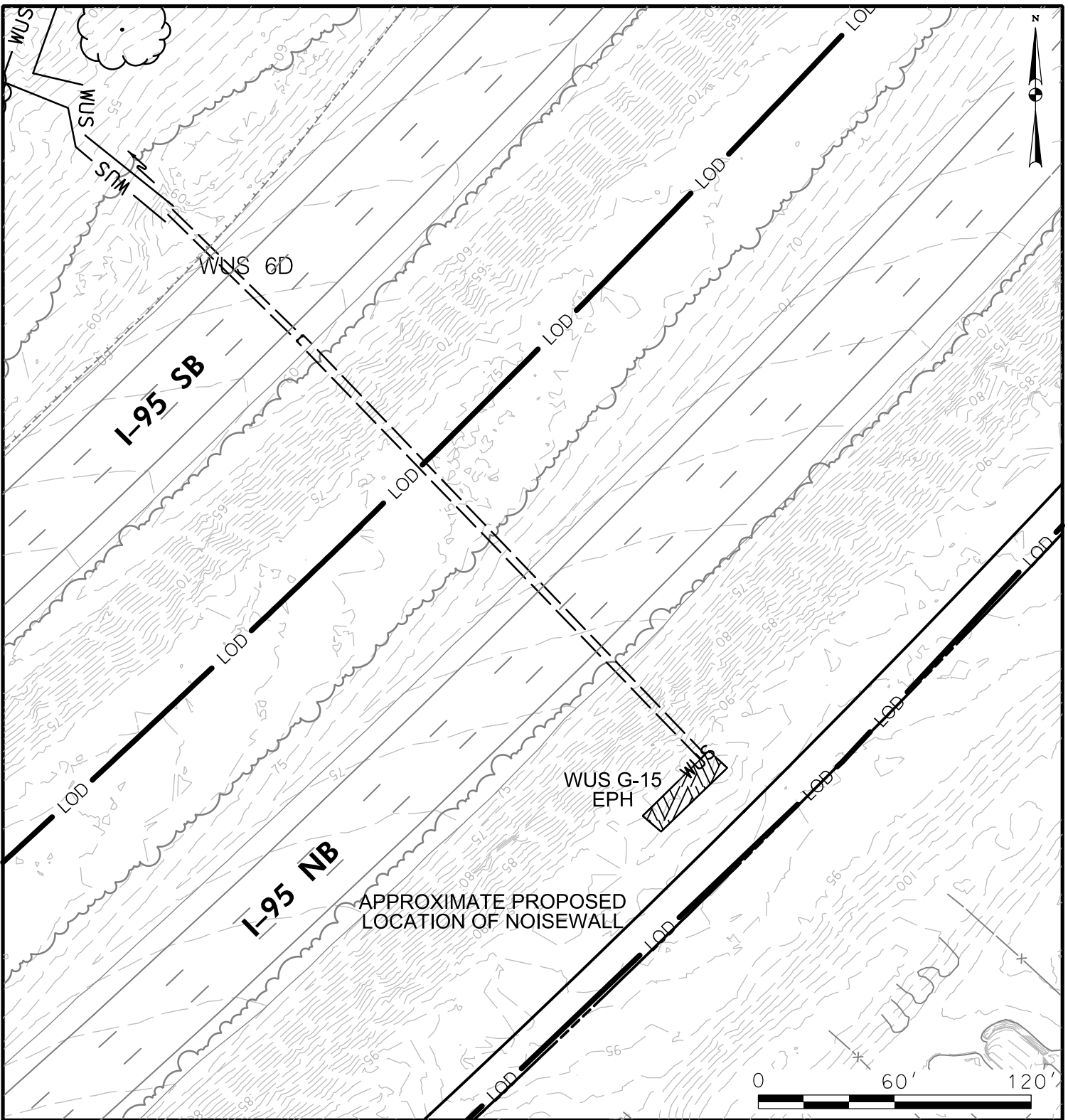

**IMPACTS ON THIS PLATE**

	TEMPORARY	PERMANENT
PFO WETLAND	0 SF	0 SF
PSS WETLAND	0 SF	0 SF
PEM WETLAND	0 SF	0 SF
PERENNIAL WUS	0 LF/SF	0 LF/SF
INTERMITTENT WUS	0 LF/SF	0 LF/SF
EPHEMERAL WUS	0 LF/SF	40/439 LF/SF
WETLAND BUFFER	0 SF	0 SF
100-YEAR FLOODPLAIN	0 SF	0 SF

**WETLAND IMPACT PLATE**

**I-95 ETL NORTHBOUND EXTENSION  
PHASE II**

I-95 ETL NB EXTENSION TO BYNUM RUN  
NB NOISE WALL ON NB I-95 NORTH OF ABINGDON RD  
HARFORD COUNTY, MARYLAND



**MARYLAND  
TRANSPORTATION AUTHORITY**

SCALE: 1" = 60'

CONTRACT NO.: KH-3020

DATE: OCTOBER 2019

PLATE 14 OF 16

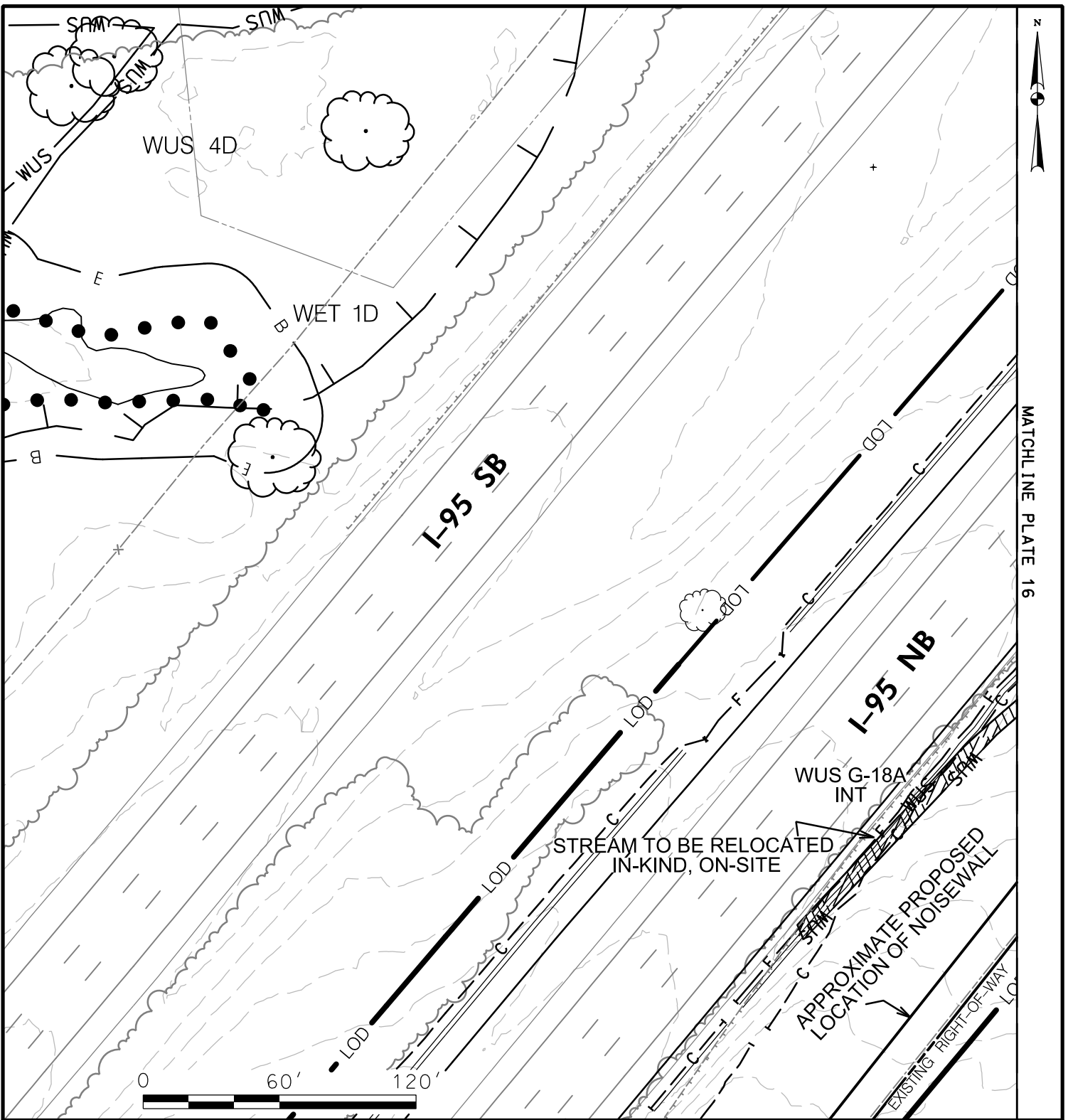

**IMPACTS ON THIS PLATE**

	TEMPORARY	PERMANENT
PFO WETLAND	0 SF	0 SF
PSS WETLAND	0 SF	0 SF
PEM WETLAND	0 SF	0 SF
PERENNIAL WUS	0 LF/SF	0 LF/SF
INTERMITTENT WUS	0 LF/SF	137/895 LF/SF
EPHEMERAL WUS	0 LF/SF	0 LF/SF
WETLAND BUFFER	0 SF	0 SF
100-YEAR FLOODPLAIN	0 SF	0 SF

**WETLAND IMPACT PLATE**

**I-95 ETL NORTHBOUND EXTENSION  
PHASE II**

I-95 ETL NB EXTENSION TO BYNUM RUN  
NB NOISE WALL ON NB I-95 NORTH OF ABINGDON RD  
HARFORD COUNTY, MARYLAND



**MARYLAND  
TRANSPORTATION AUTHORITY**

SCALE: 1" = 60'

CONTRACT NO.: KH-3020

DATE: OCTOBER 2019

PLATE 15 OF 16

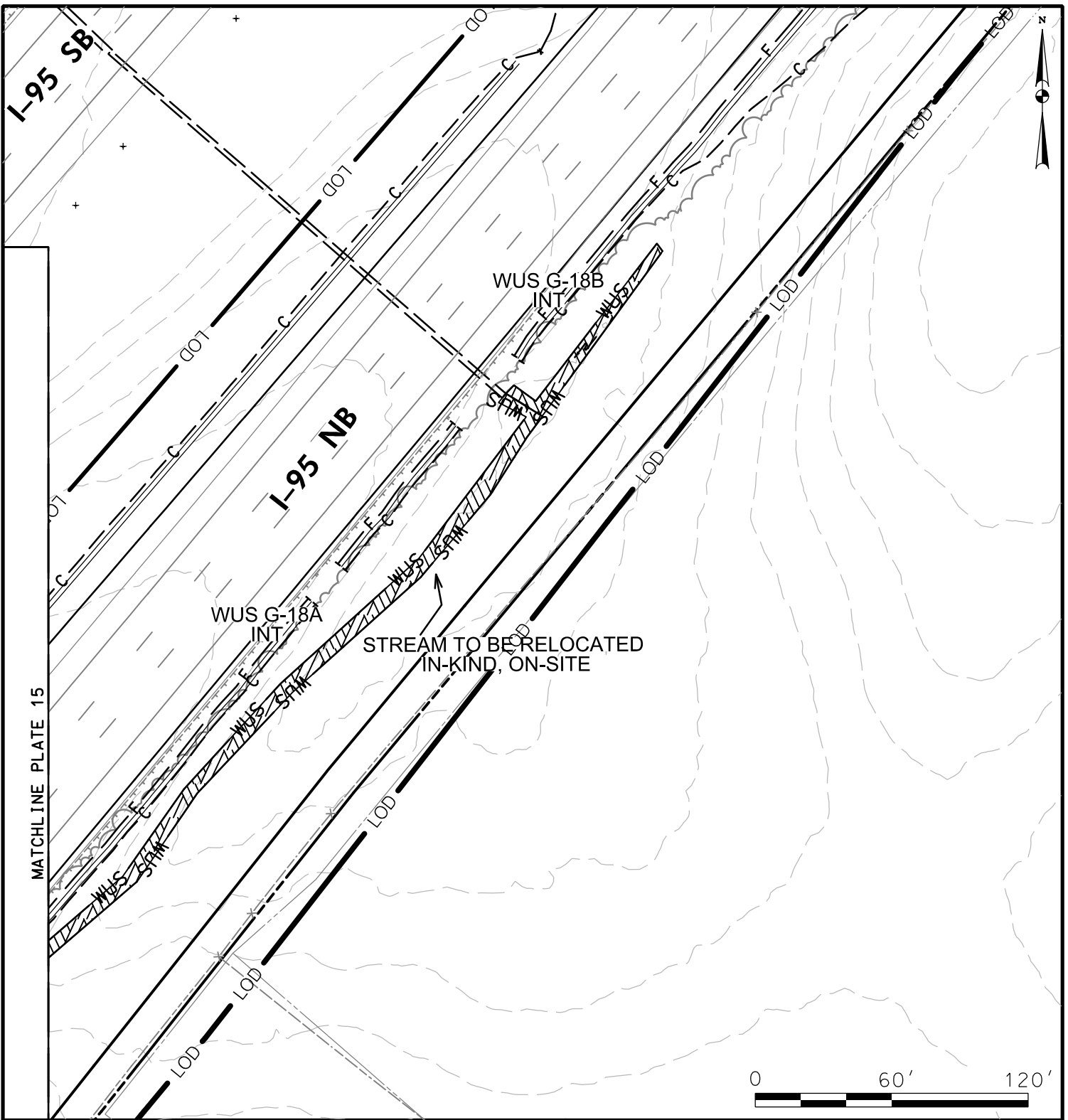

**IMPACTS ON THIS PLATE**

	TEMPORARY	PERMANENT
PFO WETLAND	0 SF	0 SF
PSS WETLAND	0 SF	0 SF
PEM WETLAND	0 SF	0 SF
PERENNIAL WUS	0 LF/SF	0 LF/SF
INTERMITTENT WUS	0 LF/SF	439/2,616 LF/SF
EPHEMERAL WUS	0 LF/SF	0 LF/SF
WETLAND BUFFER	0 SF	0 SF
100-YEAR FLOODPLAIN	0 SF	0 SF

**WETLAND IMPACT PLATE**

**I-95 ETL NORTHBOUND EXTENSION PHASE II**

I-95 ETL NB EXTENSION TO BYNUM RUN  
 NB NOISE WALL ON NB I-95 NORTH OF ABINGDON RD  
 HARFORD COUNTY, MARYLAND



**MARYLAND TRANSPORTATION AUTHORITY**

SCALE: 1" = 60'

CONTRACT NO.: KH-3020

DATE: OCTOBER 2019

PLATE 16 OF 16