

LAUREL DR

CLAYTON RD

PLATE 3



PLATE 2

NOTE: THE LOD OVERLAPS WITH CONTRACT KH-3019; IMPACTS ARE NOT HATCHED

I-95

UNNAMED TRIB. TO WINTERS RUN

PLATE 1

IMPACT PLATE KEYMAP

I-95 ETL NORTHBOUND EXTENSION
PHASE II
CLAYTON ROAD
OVERPASS RECONSTRUCTION
HARFORD COUNTY, MARYLAND



**MARYLAND
TRANSPORTATION AUTHORITY**

CONTRACT NO.: KH-3022

SCALE: 1" = 200'

DATE: AUGUST 2019



SCALE: 1" = 200'

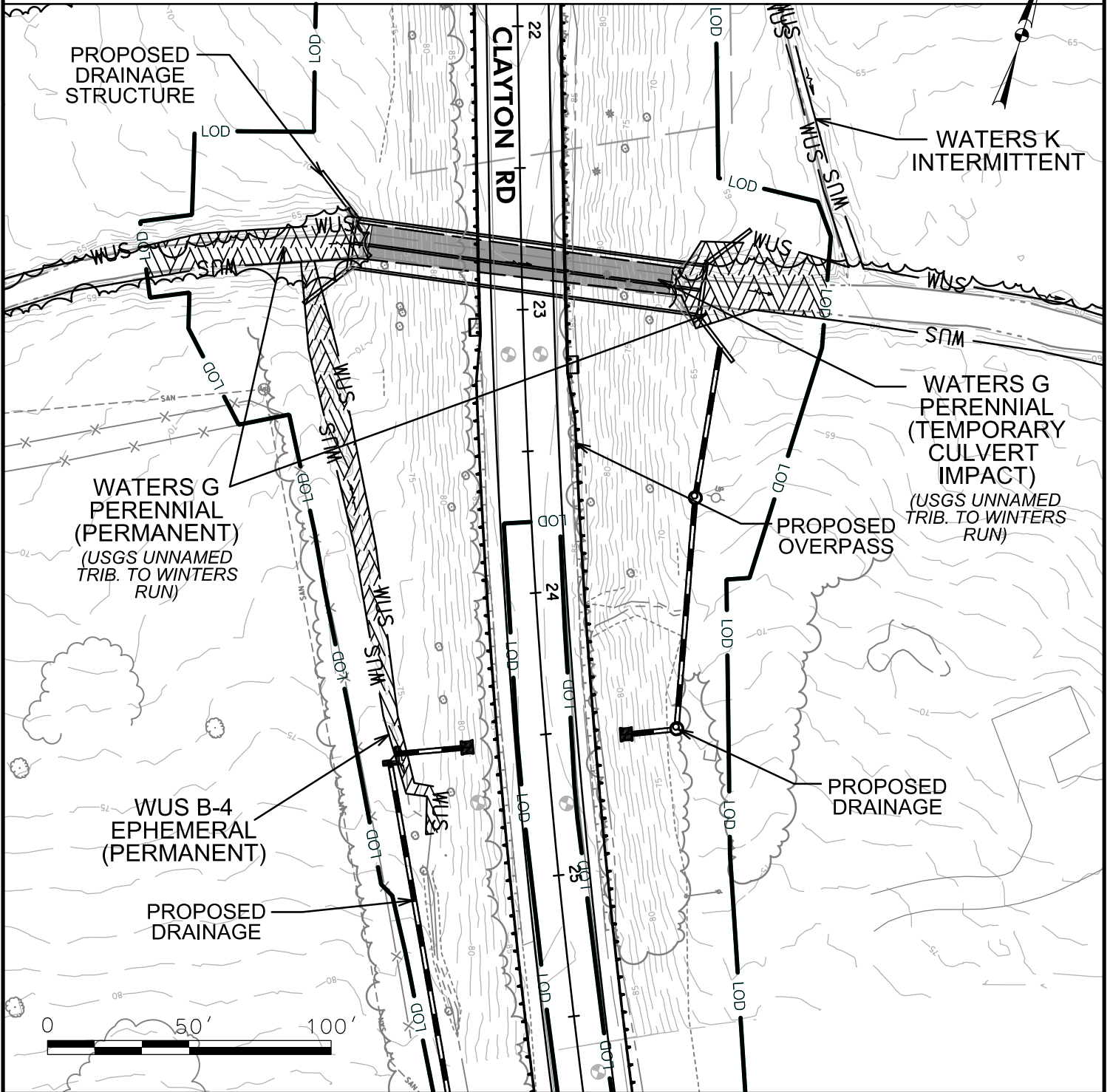

IMPACTS ON THIS PLATE

	TEMPORARY	PERMANENT
PFO WETLAND	0 SF	0 SF
PSS WETLAND	0 SF	0 SF
PEM WETLAND	0 SF	0 SF
PERENNIAL WUS	107/1,181 LF/SF	145/2,239 LF/SF
INTERMITTENT WUS	0 LF/SF	0 LF/SF
EPHEMERAL WUS	0 LF/SF	212/1,434 LF/SF
WETLAND BUFFER	0 SF	0 SF
100-YEAR FLOODPLAIN	0 SF	0 SF

WETLAND IMPACT PLATE

I-95 ETL NORTHBOUND EXTENSION
 PHASE II
 CLAYTON ROAD
 OVERPASS RECONSTRUCTION
 HARFORD COUNTY, MARYLAND



**MARYLAND
 TRANSPORTATION AUTHORITY**

SCALE: 1" = 50'

CONTRACT NO.: KH-3022

DATE: AUGUST 2019

PLATE 1 OF 3

MATCHLINE PLATE 3

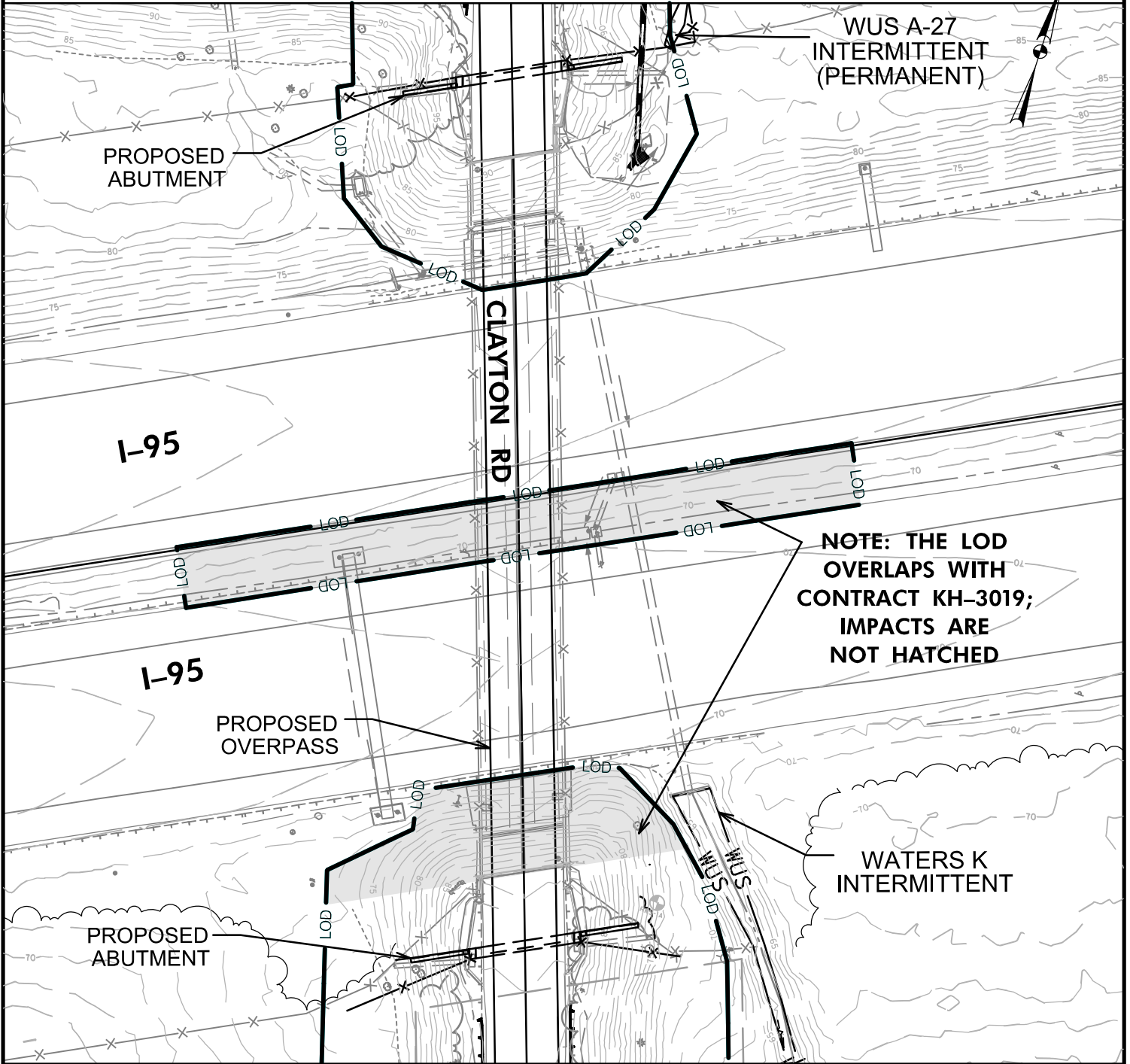

NOTE: THE LOD OVERLAPS WITH CONTRACT KH-3019; IMPACTS ARE NOT HATCHED

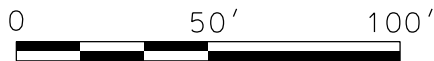

MATCHLINE PLATE 1

IMPACTS ON THIS PLATE

	TEMPORARY	PERMANENT
PFO WETLAND	0 SF	0 SF
PSS WETLAND	0 SF	0 SF
PEM WETLAND	0 SF	0 SF
PERENNIAL WUS	0 LF/SF	0 LF/SF
INTERMITTENT WUS	0 LF/SF	7/10 LF/SF
EPHEMERAL WUS	0 LF/SF	0 LF/SF
WETLAND BUFFER	0 SF	0 SF
100-YEAR FLOODPLAIN	0 SF	0 SF

WETLAND IMPACT PLATE

I-95 ETL NORTHBOUND EXTENSION
 PHASE II
 CLAYTON ROAD
 OVERPASS RECONSTRUCTION
 HARFORD COUNTY, MARYLAND



**MARYLAND
 TRANSPORTATION AUTHORITY**

SCALE: 1" = 50'

CONTRACT NO.: KH-3022

DATE: AUGUST 2019

PLATE 2 OF 3

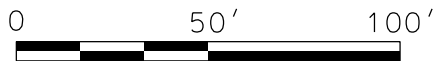
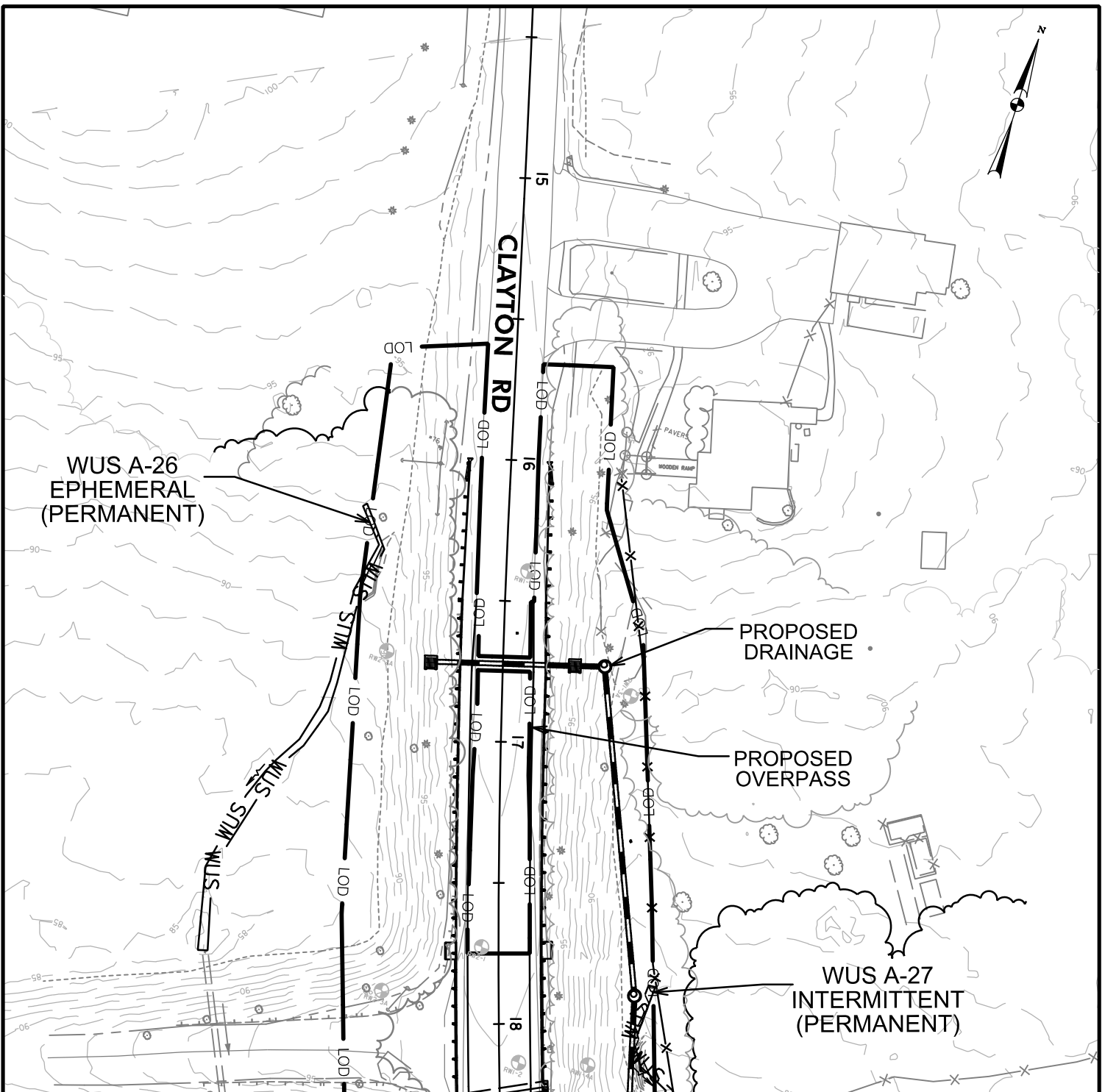

MATCHLINE PLATE 2

IMPACTS ON THIS PLATE

	TEMPORARY		PERMANENT	
PFO WETLAND	0 SF		0 SF	
PSS WETLAND	0 SF		0 SF	
PEM WETLAND	0 SF		0 SF	
PERENNIAL WUS	0 LF/SF		0 LF/SF	
INTERMITTENT WUS	0 LF/SF		37/76 LF/SF	
EPHEMERAL WUS	0 LF/SF		31/51 LF/SF	
WETLAND BUFFER	0 SF		0 SF	
100-YEAR FLOODPLAIN	0 SF		0 SF	

WETLAND IMPACT PLATE

I-95 ETL NORTHBOUND EXTENSION
 PHASE II
 CLAYTON ROAD
 OVERPASS RECONSTRUCTION
 HARFORD COUNTY, MARYLAND



**MARYLAND
 TRANSPORTATION AUTHORITY**

SCALE: 1" = 50'

CONTRACT NO.: KH-3022

DATE: AUGUST 2019

PLATE 3 OF 3