



I-895 ROADWORK NEAR MD 295 EXPECT DELAYS

Use I-95 in peak times.

@TheMDTA #i895bmore

Changing traffic patterns on I-895 between Exit 4 (MD 295) and Exit 6 (I-97 and MD 2 spur road).

Stay Alert

The Maryland Transportation Authority (MDTA) is replacing the bridge deck and superstructure on the bridge carrying I-895 over the Patapsco River Flats, located between Exit 4 (MD 295) and Exit 6 (I-97 and MD 2 spur road). This preservation project, funded completely by toll revenue, is part of the MDTA's commitment to preserving and maintaining the state's aging toll bridges, tunnels and highways.

Two-way traffic (one adjacent lane in each direction) will operate 24/7 on I-895 across the Patapsco Flats bridge. Crews will close the northbound bridge, and two-way traffic will operate on the southbound bridge. Only one lane will be open across the bridge in each direction, separated by barrier. Motorists should use I-95/Fort McHenry Tunnel as an alternate route during peak travel times.

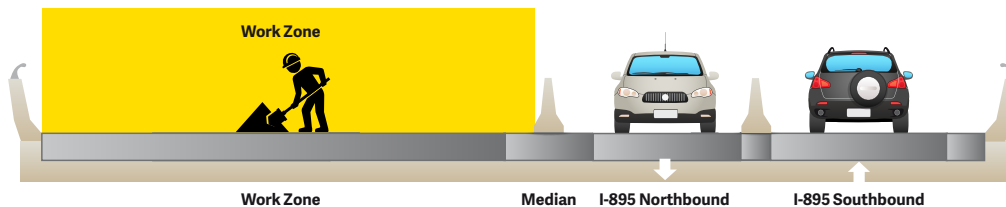

Note:

- **The traffic pattern will change on northbound I-895 before the work zone.** The current left lane closure will change to a **right** lane closure approaching the work area.
- **The traffic pattern remains the same on southbound I-895 before the work zone.** Southbound I-895 traffic approaching the work zone must use the left lane to remain on I-895 and must use the right lane for Exit 6 (I-97 and MD 2).

Motorists should expect delays during peak travel times and use I-95/Fort McHenry Tunnel as an alternate route. The MDTA will update motorists on changing traffic patterns via traffic advisories, social media and mdta.maryland.gov.

The entire project is anticipated to be complete in summer 2019. The construction includes replacing the bridge's superstructure in its entirety, which will reduce the number of bridge joints for a smoother ride. Work also includes concrete removal and repairs. The MDTA is taking the necessary steps to protect the marshland during construction. The Patapsco Flats bridge was built in 1957 and underwent minor rehabilitation four years ago.

Work Zone Safety Reminder: Slow down. Lives are on the line.

Work zone speed limits on northbound and southbound I-895 are **55 mph**. Please obey posted speed limits and pay attention.

