

IMPACT PLATE KEYMAP	
I-95 ETL NORTHBOUND EXTENSION PHASE II LILLY RUN STREAM MITIGATION HARFORD COUNTY, MARYLAND	
 MARYLAND TRANSPORTATION AUTHORITY	
CONTRACT NO.: <u> KH-30XX </u>	
SCALE: <u> 1" = 300' </u>	DATE: <u> AUGUST 2019 </u>

FILE: Q:\SMD\130770_048_195_ETL_N_Tron\CADD\Lilly Run\NCR\Impact Plates\PT-KeyMap.dgn
 DATE: Friday, August 23, 2019 AT 07:26 PM

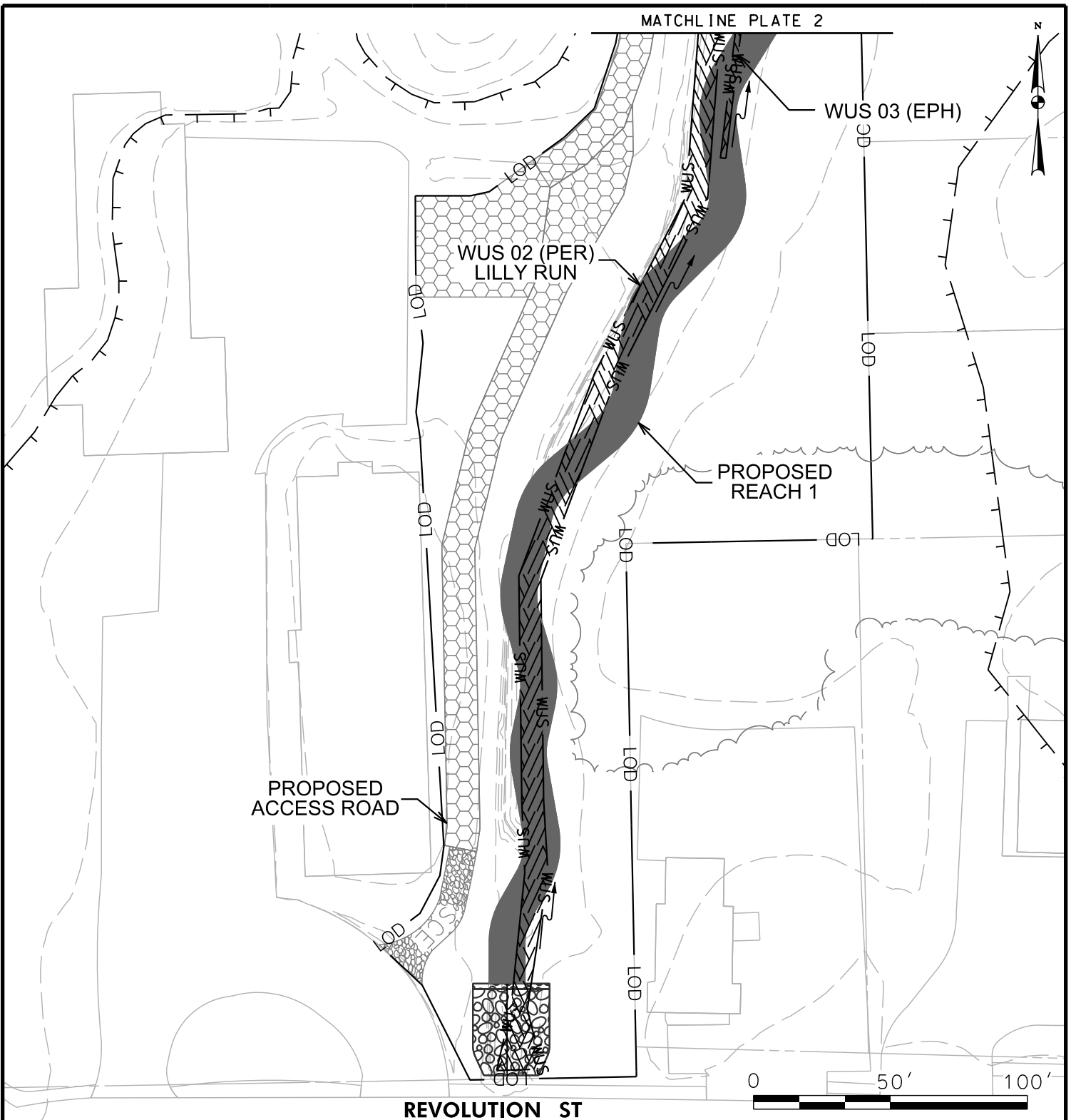

IMPACTS ON THIS PLATE

	TEMPORARY		PERMANENT	
	0	SF	0	SF
PFO WETLAND	0	SF	0	SF
PSS WETLAND	0	SF	0	SF
PEM WETLAND	0	SF	0	SF
PERENNIAL WUS	0	LF/SF	392/3,154	LF/SF
INTERMITTENT WUS	0	LF/SF	0	LF/SF
EPHEMERAL WUS	0	LF/SF	45/91	LF/SF
WETLAND BUFFER	0	SF	0	SF
100-YEAR FLOODPLAIN	38,033	SF	0	SF

•100-YEAR FLOODPLAIN IMPACTS ARE NOT HATCHED

WETLAND IMPACT PLATE

I-95 ETL NORTHBOUND EXTENSION
 PHASE II
 LILLY RUN STREAM MITIGATION
 HARFORD COUNTY, MARYLAND



**MARYLAND
 TRANSPORTATION AUTHORITY**

SCALE: 1" = 50'

CONTRACT NO.: KH-30XX

DATE: AUGUST 2019

PLATE 1 OF 9

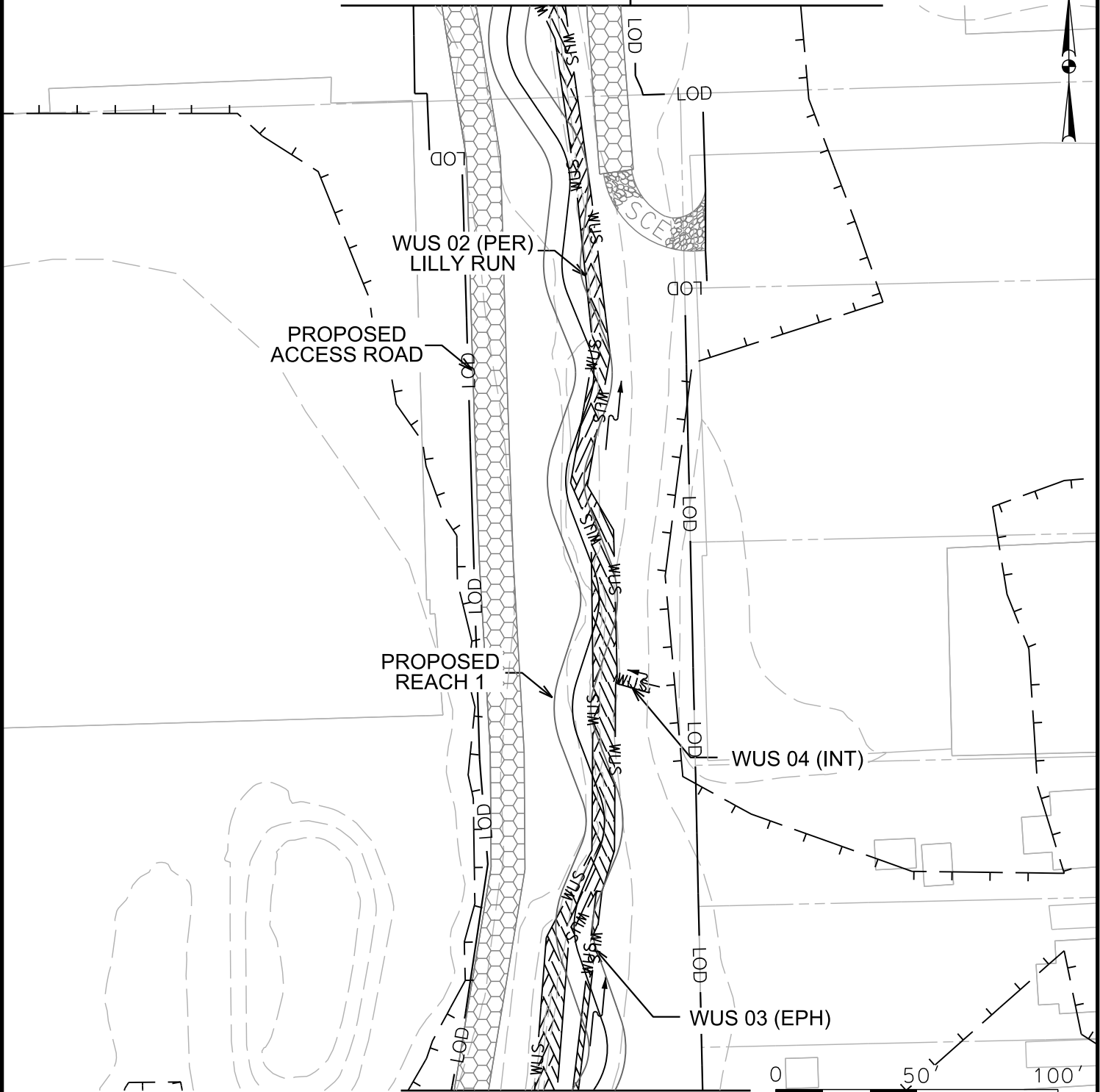

IMPACTS ON THIS PLATE

	TEMPORARY		PERMANENT	
	0	SF	0	SF
PFO WETLAND	0	SF	0	SF
PSS WETLAND	0	SF	0	SF
PEM WETLAND	0	SF	0	SF
PERENNIAL WUS	0	LF/SF	391/2,707	LF/SF
INTERMITTENT WUS	0	LF/SF	12/23	LF/SF
EPHEMERAL WUS	0	LF/SF	71/142	LF/SF
WETLAND BUFFER	0	SF	0	SF
100-YEAR FLOODPLAIN	27,182	SF	0	SF

•100-YEAR FLOODPLAIN IMPACTS ARE NOT HATCHED

WETLAND IMPACT PLATE

I-95 ETL NORTHBOUND EXTENSION
 PHASE II
 LILLY RUN STREAM MITIGATION
 HARFORD COUNTY, MARYLAND



Maryland
 Transportation
 Authority

**MARYLAND
 TRANSPORTATION AUTHORITY**

SCALE: 1" = 50'

CONTRACT NO.: KH-30XX

DATE: AUGUST 2019

PLATE 2 OF 9

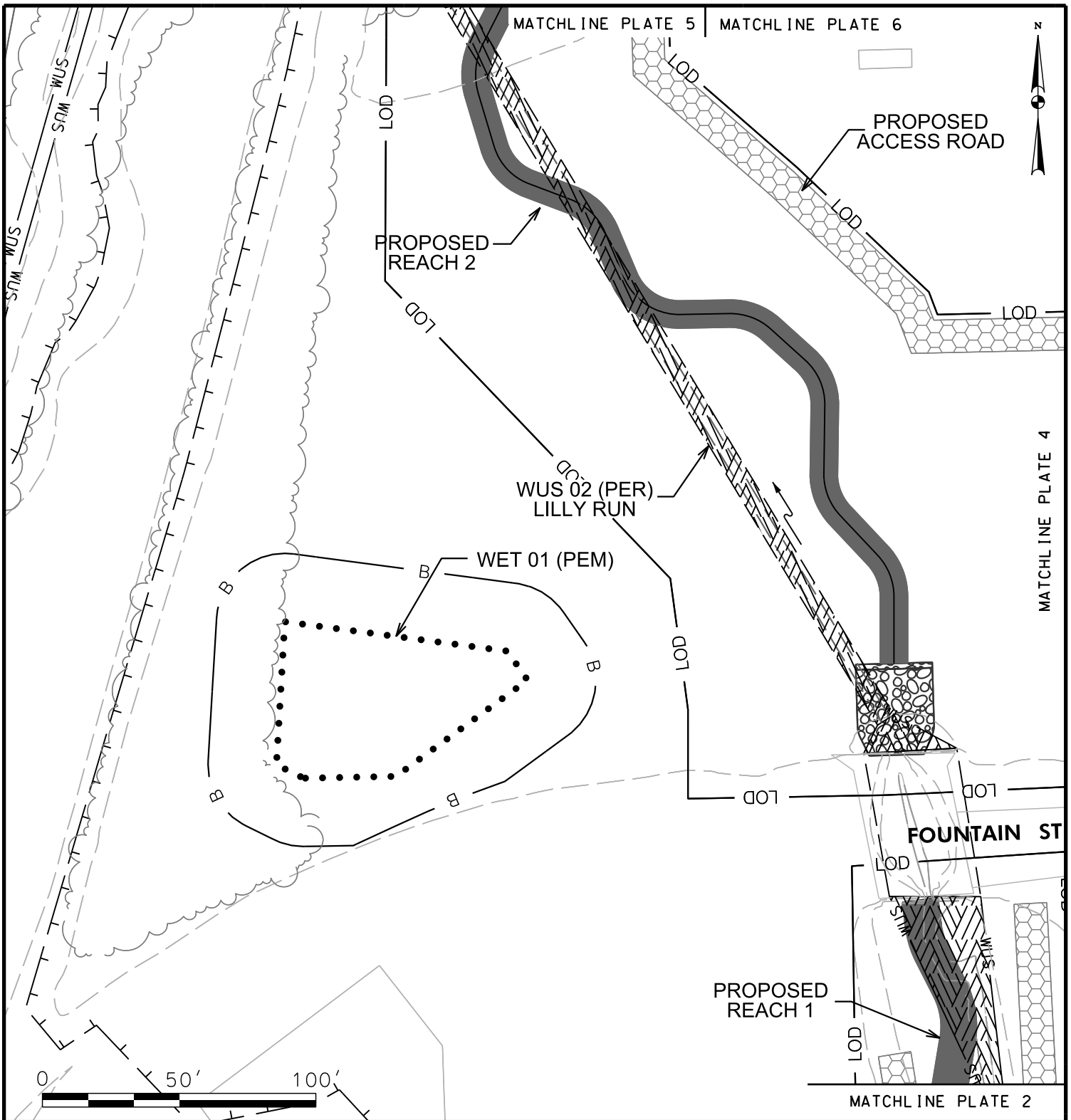

IMPACTS ON THIS PLATE

	TEMPORARY		PERMANENT	
	0	SF	0	SF
PFO WETLAND	0	SF	0	SF
PSS WETLAND	0	SF	0	SF
PEM WETLAND	0	SF	0	SF
PERENNIAL WUS	0/0	LF/SF	391/3,973	LF/SF
INTERMITTENT WUS	0	LF/SF	0	LF/SF
EPHEMERAL WUS	0	LF/SF	0	LF/SF
WETLAND BUFFER	0	SF	0	SF
100-YEAR FLOODPLAIN	47,590	SF	0	SF

*100-YEAR FLOODPLAIN IMPACTS ARE NOT HATCHED

WETLAND IMPACT PLATE

I-95 ETL NORTHBOUND EXTENSION
 PHASE II
 LILLY RUN STREAM MITIGATION
 HARFORD COUNTY, MARYLAND



**MARYLAND
 TRANSPORTATION AUTHORITY**

SCALE: 1" = 50'

CONTRACT NO.: KH-30XX

DATE: AUGUST 2019

PLATE 3 OF 9

MATCHLINE PLATE 6



BOURBON ST

S JUNIATA ST

FOUNTAIN ST

INV. ELEV. = 17.87'

PROPOSED ACCESS ROAD

LOD

LOD

SCE

MATCHLINE PLATE 3

LOD

LOD

LOD

MATCHLINE PLATE 2

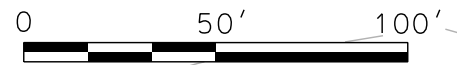

IMPACTS ON THIS PLATE

	TEMPORARY		PERMANENT	
	0	SF	0	SF
PFO WETLAND	0	SF	0	SF
PSS WETLAND	0	SF	0	SF
PEM WETLAND	0	SF	0	SF
PERENNIAL WUS	0	LF/SF	0	LF/SF
INTERMITTENT WUS	0	LF/SF	0	LF/SF
EPHEMERAL WUS	0	LF/SF	0	LF/SF
WETLAND BUFFER	0	SF	0	SF
100-YEAR FLOODPLAIN	20,941	SF	0	SF

*100-YEAR FLOODPLAIN IMPACTS ARE NOT HATCHED

WETLAND IMPACT PLATE

I-95 ETL NORTHBOUND EXTENSION
 PHASE II
 LILLY RUN STREAM MITIGATION
 HARFORD COUNTY, MARYLAND



**MARYLAND
 TRANSPORTATION AUTHORITY**

SCALE: 1" = 50'

CONTRACT NO.: KH-30XX

DATE: AUGUST 2019

PLATE 4 OF 9

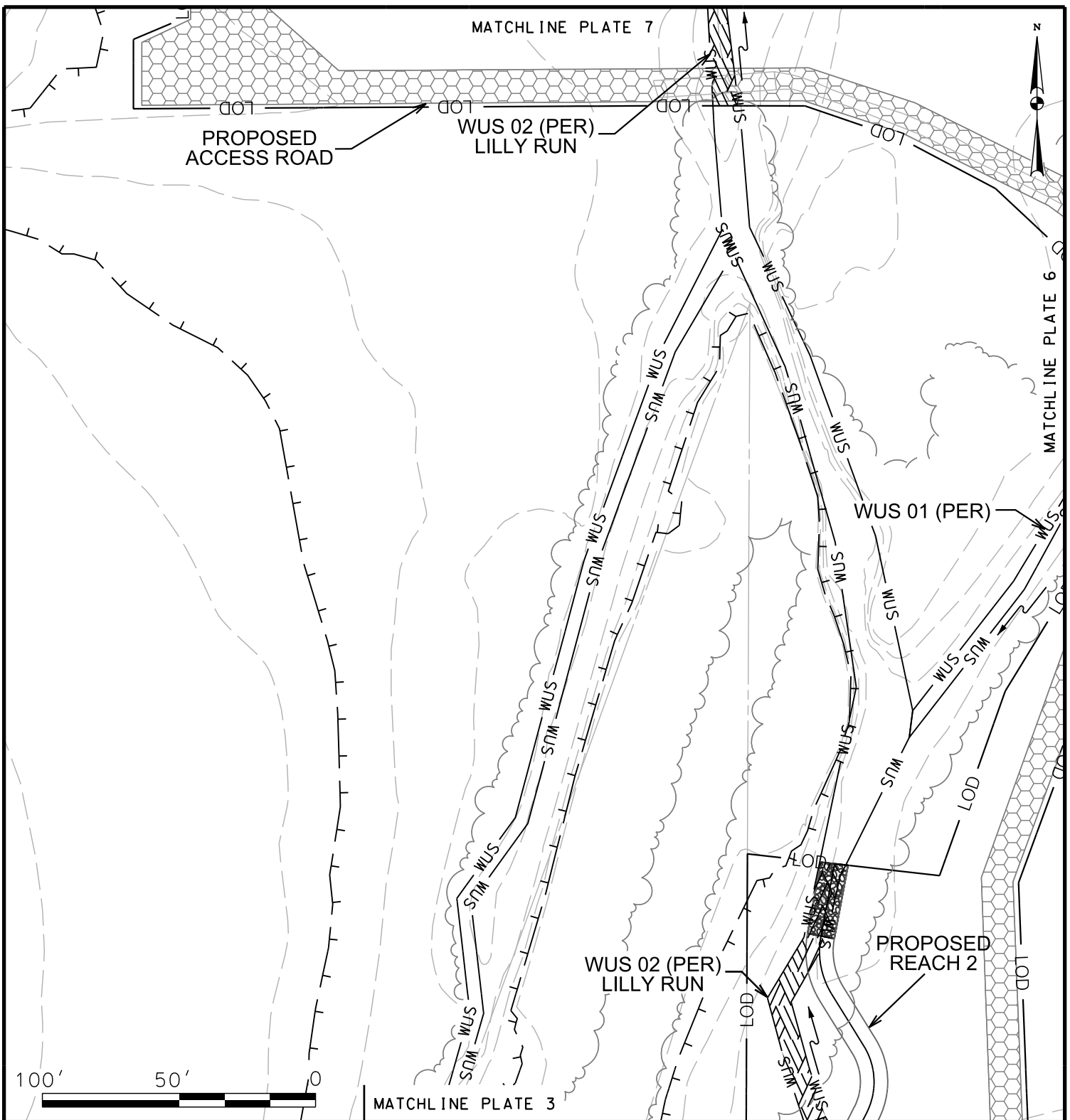

IMPACTS ON THIS PLATE

	TEMPORARY		PERMANENT	
	0	SF	0	SF
PFO WETLAND	0	SF	0	SF
PSS WETLAND	0	SF	0	SF
PEM WETLAND	0	SF	0	SF
PERENNIAL WUS	0	LF/SF	137/1,106	LF/SF
INTERMITTENT WUS	0	LF/SF	0	LF/SF
EPHEMERAL WUS	0	LF/SF	0	LF/SF
WETLAND BUFFER	0	SF	0	SF
100-YEAR FLOODPLAIN	24,814	SF	0	SF

•100-YEAR FLOODPLAIN IMPACTS ARE NOT HATCHED

WETLAND IMPACT PLATE

I-95 ETL NORTHBOUND EXTENSION
 PHASE II
 LILLY RUN STREAM MITIGATION
 HARFORD COUNTY, MARYLAND



**MARYLAND
 TRANSPORTATION AUTHORITY**

SCALE: 1" = 50'

CONTRACT NO.: KH-30XX

DATE: AUGUST 2019

PLATE 5 OF 9

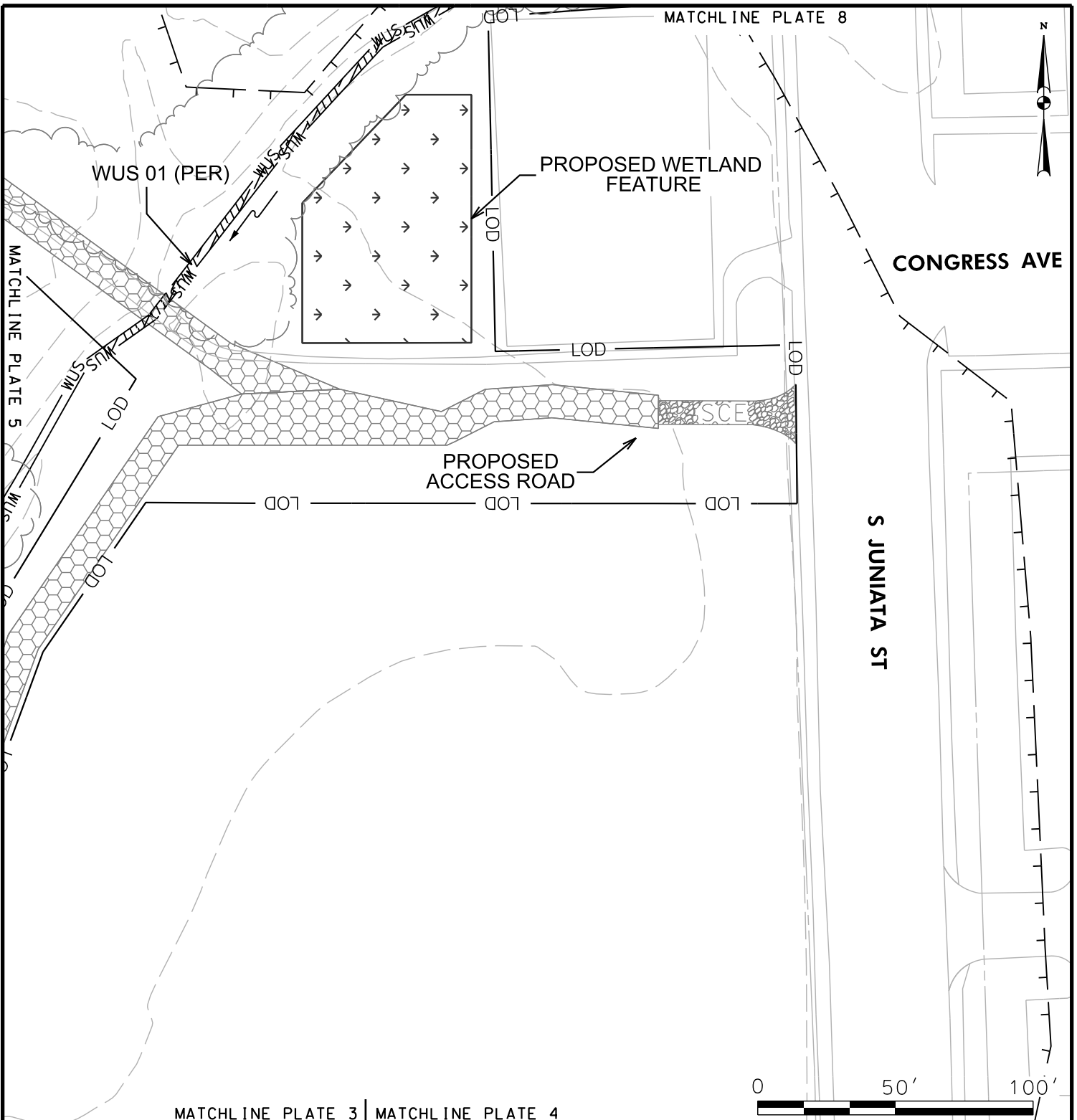

MATCHLINE PLATE 3 | MATCHLINE PLATE 4

IMPACTS ON THIS PLATE

	TEMPORARY		PERMANENT	
	0	SF	0	SF
PFO WETLAND	0	SF	0	SF
PSS WETLAND	0	SF	0	SF
PEM WETLAND	0	SF	0	SF
PERENNIAL WUS	0	LF/SF	188/531	LF/SF
INTERMITTENT WUS	0	LF/SF	0	LF/SF
EPHEMERAL WUS	0	LF/SF	0	LF/SF
WETLAND BUFFER	0	SF	0	SF
100-YEAR FLOODPLAIN	35,111	SF	0	SF

•100-YEAR FLOODPLAIN IMPACTS ARE NOT HATCHED

WETLAND IMPACT PLATE

I-95 ETL NORTHBOUND EXTENSION
 PHASE II
 LILLY RUN STREAM MITIGATION
 HARFORD COUNTY, MARYLAND



**MARYLAND
 TRANSPORTATION AUTHORITY**

SCALE: 1" = 50'

CONTRACT NO.: KH-30XX

DATE: AUGUST 2019

PLATE 6 OF 9

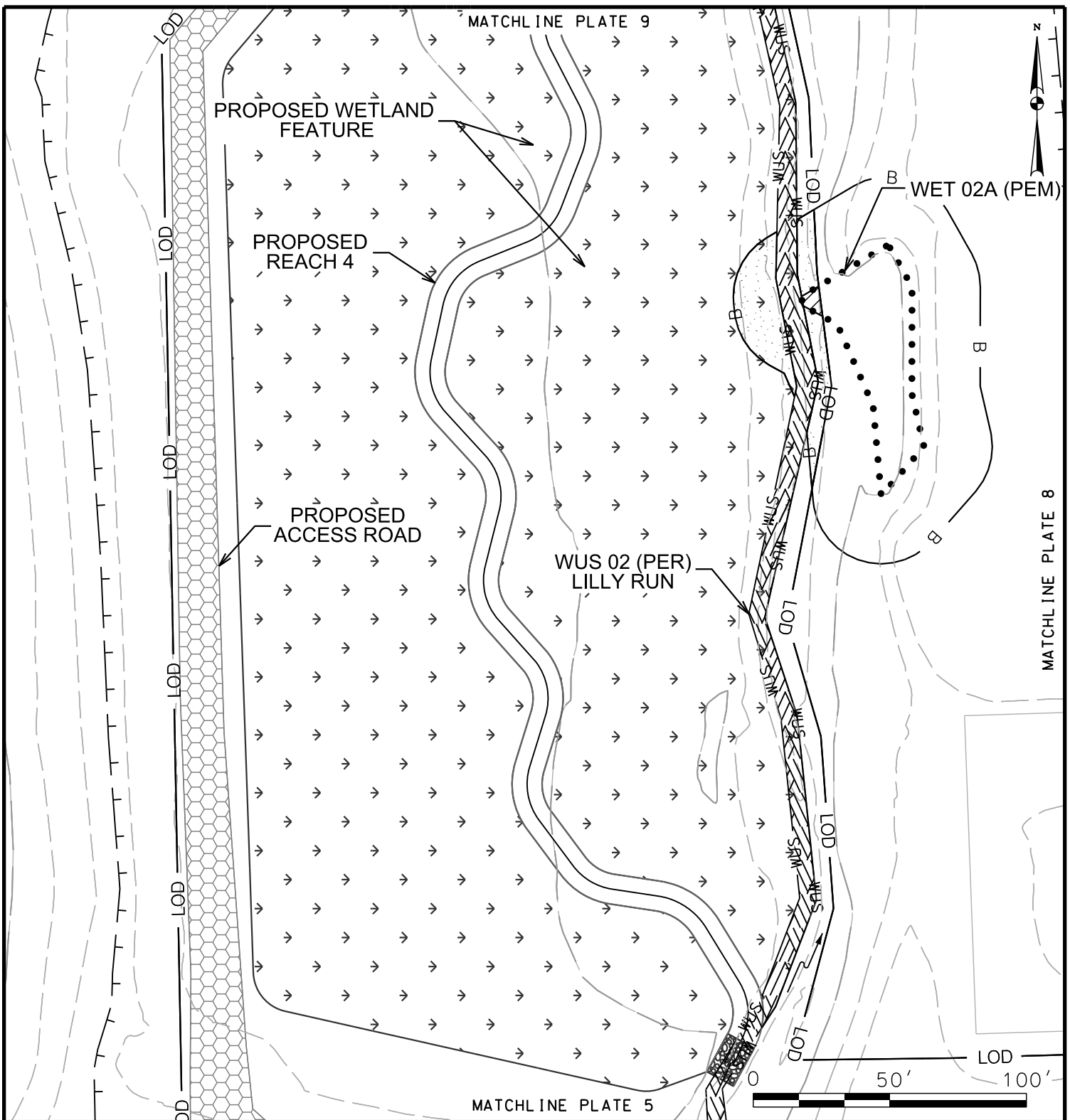

IMPACTS ON THIS PLATE

	TEMPORARY		PERMANENT	
		SF		SF
PFO WETLAND	0	SF	0	SF
PSS WETLAND	0	SF	0	SF
PEM WETLAND	48	SF	0	SF
PERENNIAL WUS	0	LF/SF	421/2,696	LF/SF
INTERMITTENT WUS	0	LF/SF	0	LF/SF
EPHEMERAL WUS	0	LF/SF	0	LF/SF
WETLAND BUFFER	1,198	SF	0	SF
100-YEAR FLOODPLAIN	95,378	SF	0	SF

•100-YEAR FLOODPLAIN IMPACTS ARE NOT HATCHED

WETLAND IMPACT PLATE

I-95 ETL NORTHBOUND EXTENSION
 PHASE II
 LILLY RUN STREAM MITIGATION
 HARFORD COUNTY, MARYLAND



Maryland
 Transportation
 Authority

**MARYLAND
 TRANSPORTATION AUTHORITY**

SCALE: 1" = 50'

CONTRACT NO.: KH-30XX

DATE: AUGUST 2019

PLATE 7 OF 9

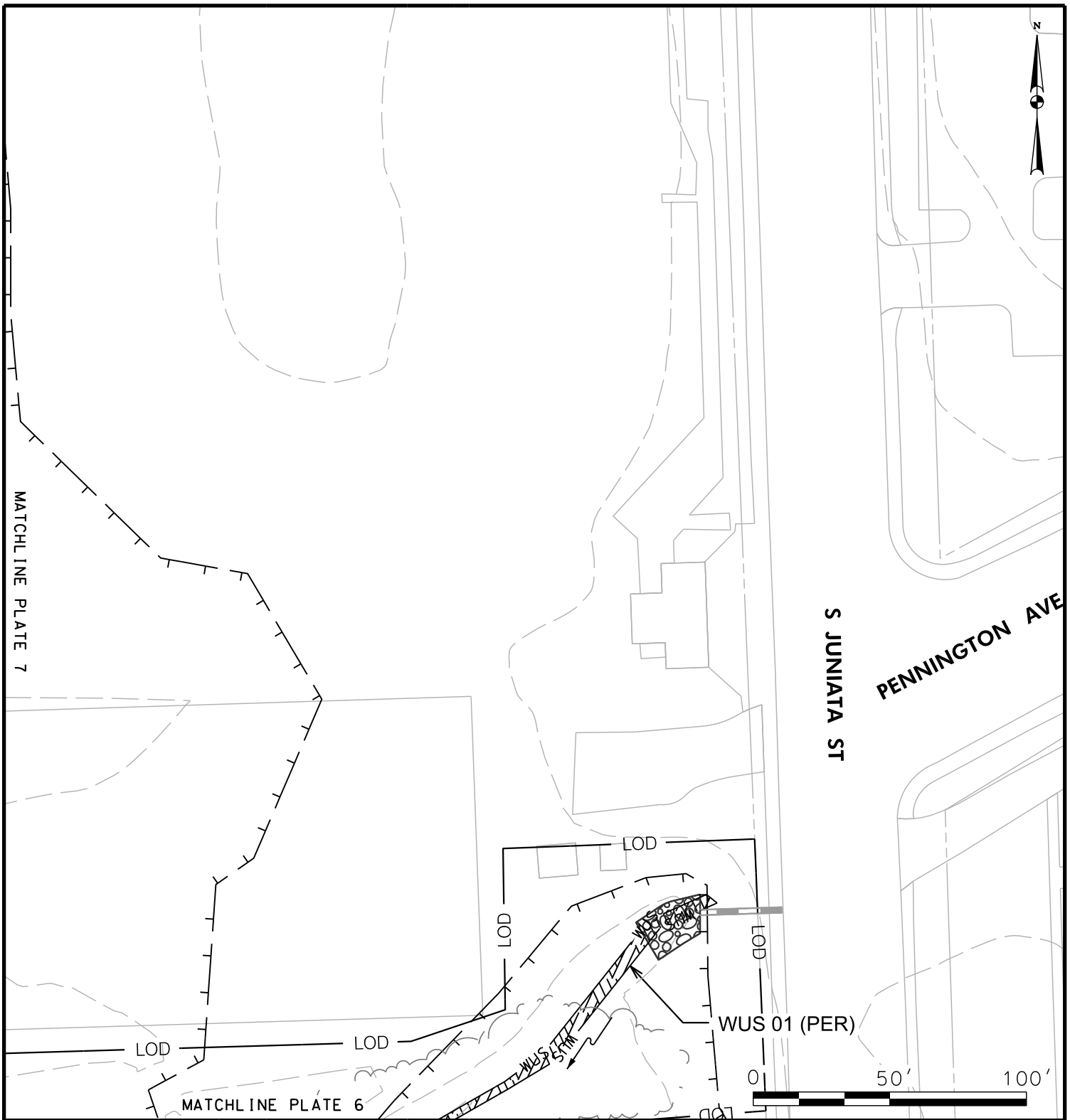

IMPACTS ON THIS PLATE

	TEMPORARY		PERMANENT	
	0	SF	0	SF
PFO WETLAND	0	SF	0	SF
PSS WETLAND	0	SF	0	SF
PEM WETLAND	0	SF	0	SF
PERENNIAL WUS	0	LF/SF	128/3,028	LF/SF
INTERMITTENT WUS	0	LF/SF	0	LF/SF
EPHEMERAL WUS	0	LF/SF	0	LF/SF
WETLAND BUFFER	0	SF	0	SF
100-YEAR FLOODPLAIN	8,057	SF	0	SF

•100-YEAR FLOODPLAIN IMPACTS ARE NOT HATCHED

WETLAND IMPACT PLATE

I-95 ETL NORTHBOUND EXTENSION
 PHASE II
 LILLY RUN STREAM MITIGATION
 HARFORD COUNTY, MARYLAND



**MARYLAND
 TRANSPORTATION AUTHORITY**

SCALE: 1" = 50'

CONTRACT NO.: KH-30XX

DATE: AUGUST 2019

PLATE 8 OF 9

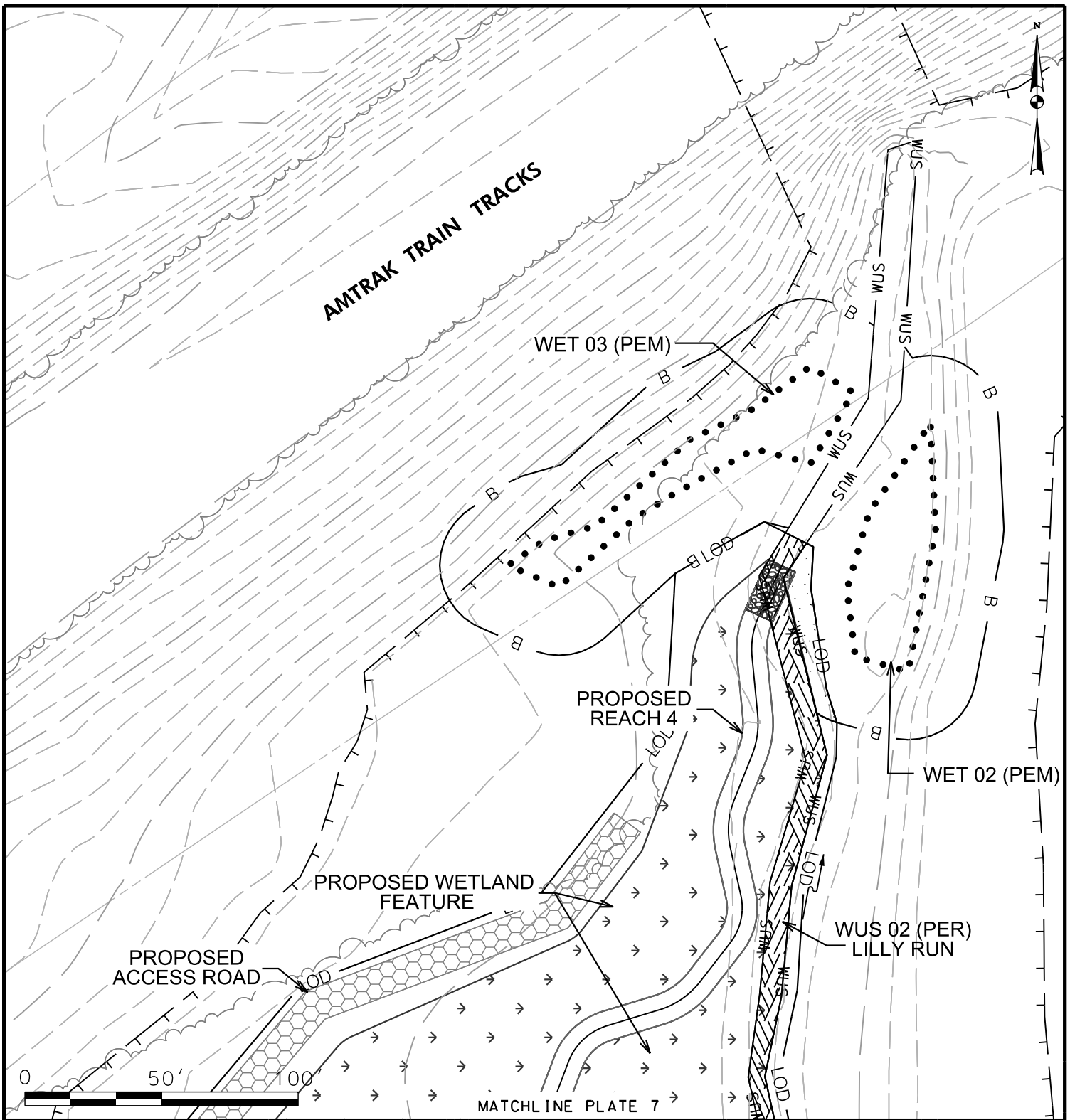

IMPACTS ON THIS PLATE

	TEMPORARY		PERMANENT	
	0	SF	0	SF
PFO WETLAND	0	SF	0	SF
PSS WETLAND	0	SF	0	SF
PEM WETLAND	0	SF	0	SF
PERENNIAL WUS	0	LF/SF	219/1,695	LF/SF
INTERMITTENT WUS	0	LF/SF	0	LF/SF
EPHEMERAL WUS	0	LF/SF	0	LF/SF
WETLAND BUFFER	460	SF	0	SF
100-YEAR FLOODPLAIN	21,316	SF	0	SF

•100-YEAR FLOODPLAIN IMPACTS ARE NOT HATCHED

WETLAND IMPACT PLATE

I-95 ETL NORTHBOUND EXTENSION
 PHASE II
 LILLY RUN STREAM MITIGATION
 HARFORD COUNTY, MARYLAND

**MARYLAND
 TRANSPORTATION AUTHORITY**

SCALE: 1" = 50'

CONTRACT NO.: KH-30XX

DATE: AUGUST 2019

PLATE 9 OF 9