

LIMIT OF DISTURBANCE

PLATE 1

PLATE 2

PLATE 3

NOTE: THE LOD OVERLAPS WITH CONTRACT KH-3021; IMPACTS ARE NOT HATCHED

HAHA BRANCH



SCALE: 1"=600'

IMPACT PLATE KEYMAP

**I-95 ETL NORTHBOUND EXTENSION
PHASE II**

**NOISE WALL ON SB I-95 AT
MD 24 / WOODSDALE
HARFORD COUNTY, MARYLAND**



**MARYLAND
TRANSPORTATION AUTHORITY**

CONTRACT NO.: KH-3030

SCALE: 1" = 600'

DATE: JULY 2019

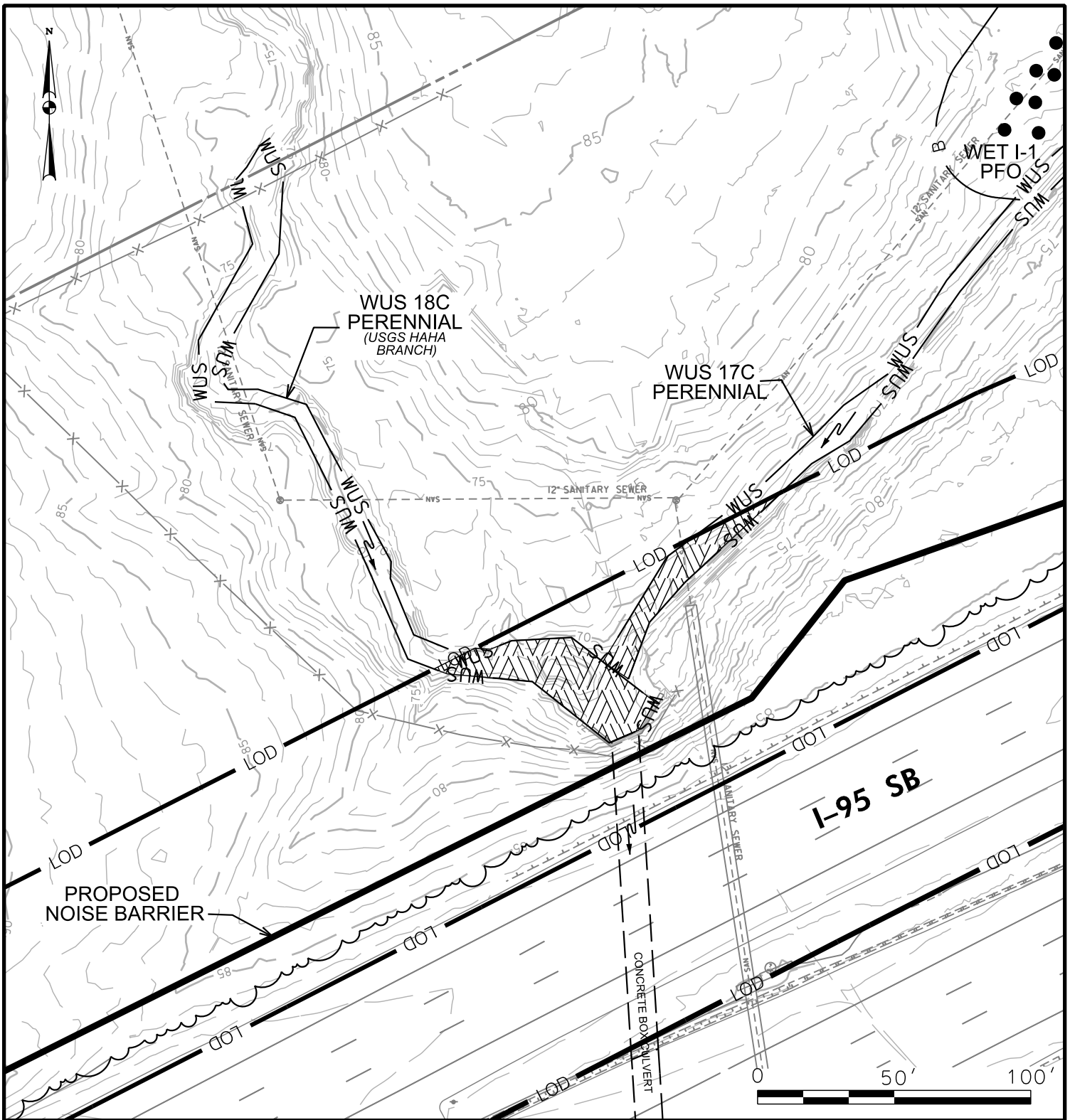

IMPACTS ON THIS PLATE

	TEMPORARY	PERMANENT
PFO WETLAND	0 SF	0 SF
PSS WETLAND	0 SF	0 SF
PEM WETLAND	0 SF	0 SF
PERENNIAL WUS	0 LF/SF	167 LF / 2,019 SF
INTERMITTENT WUS	0 LF/SF	0 LF/SF
EPHEMERAL WUS	0 LF/SF	0 LF/SF
WETLAND BUFFER	0 SF	0 SF
100-YEAR FLOODPLAIN	0 SF	0 SF

WETLAND IMPACT PLATE

I-95 ETL NORTHBOUND EXTENSION
 PHASE II
 NOISE WALL ON SB I-95 AT
 MD 24 / WOODSDALE
 HARFORD COUNTY, MARYLAND



**MARYLAND
 TRANSPORTATION AUTHORITY**

SCALE: 1" = 50'

CONTRACT NO.: KH-3030

DATE: JULY 2019

PLATE 1 OF 3

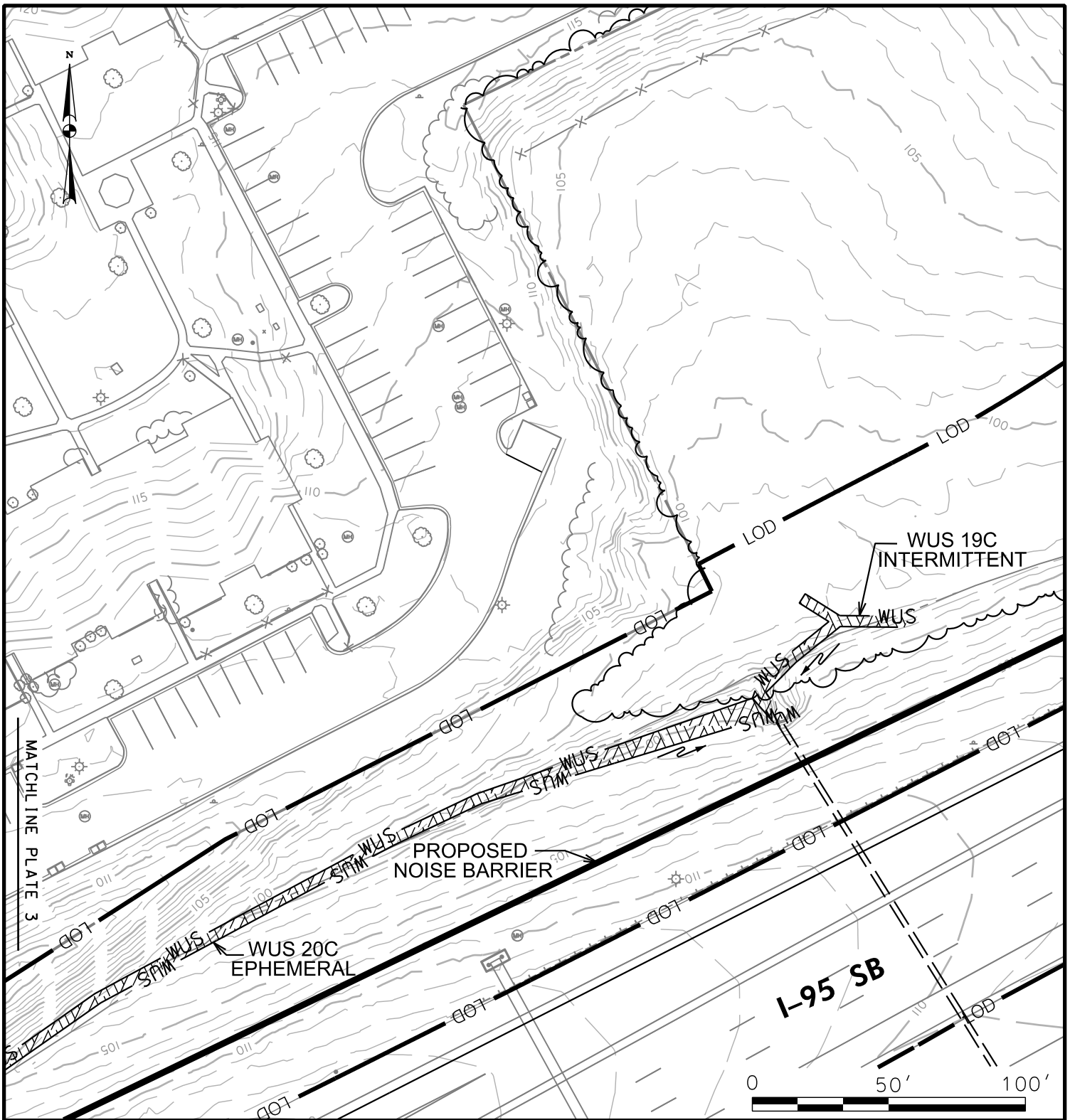

IMPACTS ON THIS PLATE

	TEMPORARY	PERMANENT
PFO WETLAND	0 SF	0 SF
PSS WETLAND	0 SF	0 SF
PEM WETLAND	0 SF	0 SF
PERENNIAL WUS	0 LF/SF	0 LF/SF
INTERMITTENT WUS	0 LF/SF	90 LF/371 SF
EPHEMERAL WUS	0 LF/SF	308 LF/1,457 SF
WETLAND BUFFER	0 SF	0 SF
100-YEAR FLOODPLAIN	0 SF	0 SF

WETLAND IMPACT PLATE

I-95 ETL NORTHBOUND EXTENSION
 PHASE II
 NOISE WALL ON SB I-95 AT
 MD 24 / WOODSDALE
 HARFORD COUNTY, MARYLAND

**MARYLAND
 TRANSPORTATION AUTHORITY**

SCALE: 1" = 50'

CONTRACT NO.: KH-3030

DATE: JULY 2019

PLATE 2 OF 3

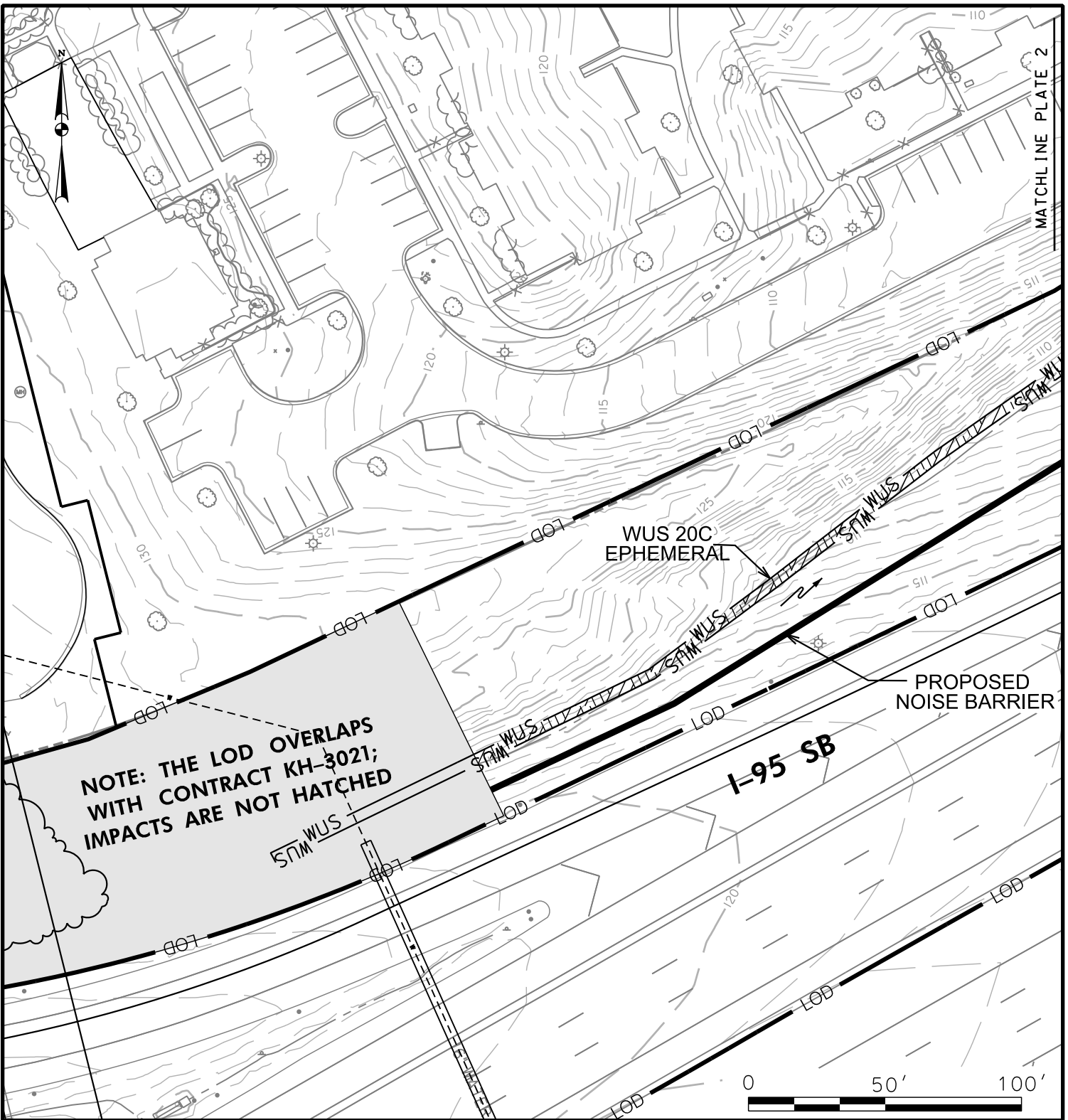

NOTE: THE LOD OVERLAPS WITH CONTRACT KH-3021; IMPACTS ARE NOT HATCHED

IMPACTS ON THIS PLATE

	TEMPORARY	PERMANENT
PFO WETLAND	0 SF	0 SF
PSS WETLAND	0 SF	0 SF
PEM WETLAND	0 SF	0 SF
PERENNIAL WUS	0 LF/SF	0 LF/SF
INTERMITTENT WUS	0 LF/SF	0 LF/SF
EPHEMERAL WUS	0 LF/SF	259 LF/ 1,037 SF
WETLAND BUFFER	0 SF	0 SF
100-YEAR FLOODPLAIN	0 SF	0 SF

WETLAND IMPACT PLATE

**I-95 ETL NORTHBOUND EXTENSION
PHASE II
NOISE WALL ON SB I-95 AT
MD 24 / WOODSDALE
HARFORD COUNTY, MARYLAND**

**MARYLAND
TRANSPORTATION AUTHORITY**

SCALE: 1" = 50'

CONTRACT NO.: KH-3030

DATE: JULY 2019

PLATE 3 OF 3